



# GUARDIAN Electric Manufacturing

ISO 9001 / AS9100 Certified Company

Woodstock, IL 60098 Ph. (815)334-3600 Fax (815)337-0377

Or visit us at our website [www.guardian-electric.com](http://www.guardian-electric.com)

## Model LT8 x 16 Long-Life DC Tubular Solenoid

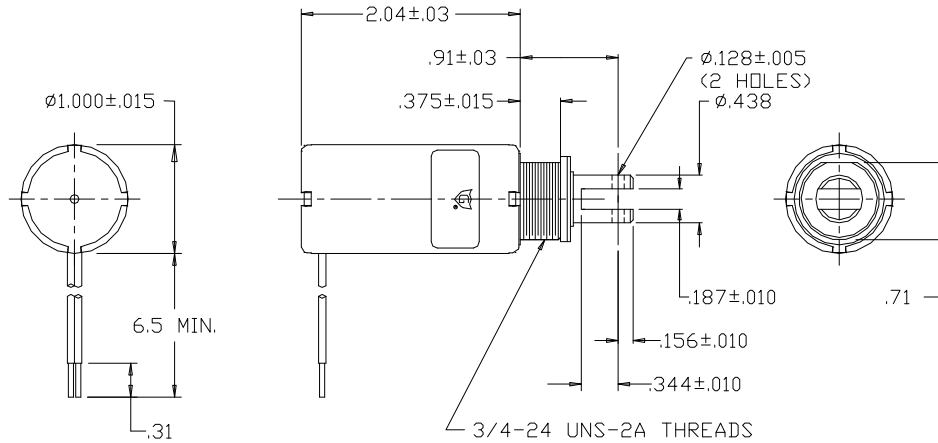

Solenoid shown energized and fully seated.

Supplied with mounting bracket, hex nut and lockwasher (not shown).

Spring kits are available (consult factory).

Total Weight: 6.4 oz.

Plunger Weight: 1.4 oz.

Model No.	Part No.	Duty Cycle	Voltage	Resistance (Ω)	Power (W)	Current
LT8x16-I-12	A420-064851-00	Intermittent	12VDC	6.2	24.4	1.94 A
LT8x16-C-12	A420-064850-00	Continuous	12VDC	19.3	7.8	622 mA
LT8x16-I-24	A420-064853-00	Intermittent	24VDC	29.7	20.4	808 mA
LT8x16-C-24	A420-064852-00	Continuous	24VDC	77.2	7.8	311 mA

When ordering, please refer to Part No., as listed above.

Consult factory for custom configurations.

Stroke (in.)	Pull Force (oz.)								Holding Force (oz.)
	0.050	0.125	0.250	0.375	0.500	0.625	0.750	1.000	
Continuous Duty	45	28	12	9	5	3	1	N/A	43
Intermittent Duty	80	55	35	25	15	10	3	N/A	66

### UL Recognition

Recognized under the  Component Recognition Program of **Underwriters Laboratories, Inc.**

### Continuous Duty

100% 'On' Time

### Intermittent Duty

25% 'On' Time, (100 Seconds 'On' Max. Followed By 300 Seconds 'Off' Min.)

### RoHS

These parts comply with **RoHS** Directive 2002/95/EC