

CONTACT ORIENTATION ON ROLL

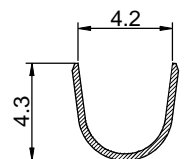

SECTION B-B

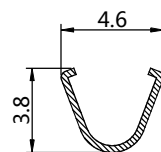

SECTION A-A

NOTES : (UNLESS OTHERWISE SPECIFIED)

1. MATERIAL :
 - 1.1. CONTACT BODY : COPPER ALLOY.
 - 1.2. OUTER SPRING : STAINLESS STEEL
2. SPECIFICATIONS :
 - 2.1 CURRENT RATING : 23A MAX.
 - 2.2 TERMINATION TYPE : CRIMPING.
 - 2.3 WIRE RANGE : 14~12AWG.
 - 2.4 WIRE INSULATION DIA(MAX) : Ø4.3mm.
3. ROHS COMPLIANT.
4. ALL DIMENSIONS ARE FOR REFERENCE USE ONLY.

P/N	CONTACT PLATING(MATING AREA)
SP12A1T	TIN PLATING OVER NICKEL.
SP12A1F	GOLD FLASH PLATING OVER NICKEL.
SP12A1G10	10µ" GOLD PLATING OVER NICKEL.
SP12A1G15	15µ" GOLD PLATING OVER NICKEL.
SP12A1G30	30µ" GOLD PLATING OVER NICKEL.

REVISIONS					
REV	ECO	DESCRIPTION	DATE	BY	APPR
B1	-	RELEASED DRAWING	JAN-18-2014	ARROW	TOMMY

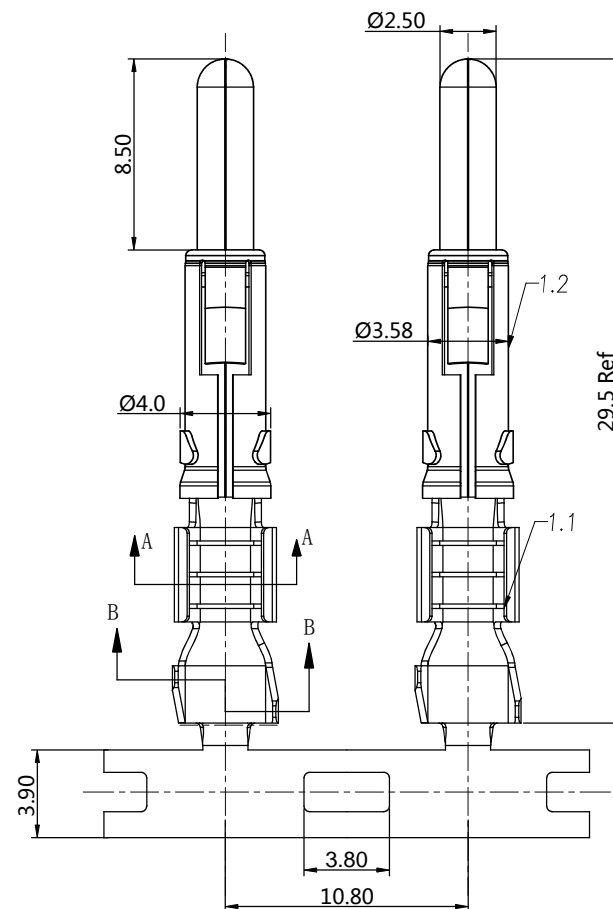

QUANTITY	PART NUMBER	DESCRIPTION	ITEM

MATERIALS LIST			
UNLESS OTHERWISE SPECIFIED 1) All dimensions are in metric(mm). 2) Tolerances are as follows: 1 PL DEC ±0.30 Fractions ±1/64 2 PL DEC ±0.15 Angles ±1° 3 PL DEC ±0.08 3) Note reference = Δ	SIGNATURES	DATE	Amphenol Sine Systems - www.amphenol-sine.com 44724 Morley Drive Clinton Township, MI 48036
	DRAWN: ARROW	JAN-17-2014	
	CHECKED:		ECO-MATE, PIN CONTACT, STAMPED, 14-12AWG, 2.5mm CONTACT
	ENGINEER:		
	APPROVAL:		THIS DRAWING IS SUPPLIED FOR INFORMATION ONLY. DESIGN FEATURES, SPECIFICATIONS AND PERFORMANCE DATA SHOWN HEREON ARE THE PROPERTY OF THE AMPHENOL CORPORATION. NO RIGHTS OF REPRODUCTION ARE IMPLIED. ALL DIMENSIONS ARE SUBJECT TO NORMAL MANUFACTURING VARIATIONS.
	CUSTOMER:		
MATERIAL SPECIFICATIONS:			SIZE: B TYPE: C- DWG NO: SP12A1XX REVISION: B1
PROCESS SPECIFICATIONS:			SCALE: NONE SHEET 1 OF 1
NEXT ASSY:			

TITLE: ECO-MATE, PIN CONTACT, STAMPED, 14-12AWG, 2.5mm
 DWG NO: SP12A1XX
 REV: B1
 SHEET: 1
 OF: 1