

EAO – Your Expert Partner for Human Machine Interfaces

45-2134.1190.000 - Pushbutton actuator, Maintain

45-2134.1190.000 - Pushbutton actuator, Maintain



Attention: The preview is based on a sample product. This can differ from your current configuration.

Mounting

Design raised
Mounting cut-out Ø 22.5 mm

Front

Front shape round
Front dimension Ø 29.45 mm
Front ring material Plastic
Front ring colour black

Other Attributes

Weight 0.013 kg

Operating-/Indication part

Lens optics opaque
Lens material Plastic
Lens colour white
Lens profile flat / level with front ring

IP-Rating

Front protection IP66, IP67, IP69K

Actuator

Switching action Maintained
Housing material Plastic

Switching element

6

Function

Pushbutton

EAO – Your Expert Partner for Human Machine Interfaces

45-2134.1190.000 - Pushbutton actuator, Maintain

Dimensions

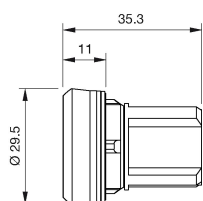

Mounting cut-outs



Wiring diagram



Additional information

Push to unlatch

Legend

Switching action: C = Maintained