

# EAO – Your Expert Partner for Human Machine Interfaces

45-2131.1140.000 - Pushbutton actuator, Momentary

## 45-2131.1140.000 - Pushbutton actuator, Momentary



*Attention: The preview is based on a sample product. This can differ from your current configuration.*

### Mounting

Design raised  
Mounting cut-out Ø 22.5 mm

### Front

Front shape round  
Front dimension Ø 29.45 mm  
Front ring material Plastic  
Front ring colour black

### Other Attributes

Weight 0.013 kg

### Operating-/Indication part

Lens optics opaque  
Lens material Plastic  
Lens colour yellow  
Lens profile flat / level with front ring

### IP-Rating

Front protection IP66, IP67, IP69K

### Actuator

Switching action Momentary  
Housing material Plastic

### Switching element

6

### Function

Pushbutton

# EAO – Your Expert Partner for Human Machine Interfaces

45-2131.1140.000 - Pushbutton actuator, Momentary

## Dimensions

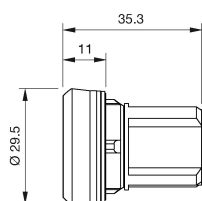

## Mounting cut-outs

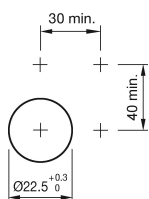

## Wiring diagram

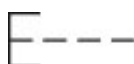

## Legend

Switching action: B = Momentary