

EAO – Your Expert Partner for Human Machine Interfaces

45-2F13.1010.000 - Lever switch

45-2F13.1010.000 - Lever switch



Attention: The preview is based on a sample product. This can differ from your current configuration.

Mounting

Mounting cut-out Ø 22.5 mm
Design raised

Front

Front shape round
Front dimension Ø 29.45 mm
Front ring material Plastic
Front ring colour black

Other Attributes

Weight 0.035 kg

Operating-/Indication part

Lever colour black
Lever material Plastic

IP-Rating

Front protection IP66, IP67, IP69K

Actuator

Switching action Momentary
Housing material Plastic

Switching element

6

Function

Lever switch

EAO – Your Expert Partner for Human Machine Interfaces

45-2F13.1010.000 - Lever switch

Dimensions

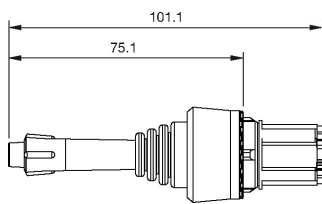

Mounting cut-outs

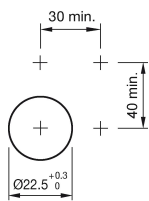

Wiring diagram

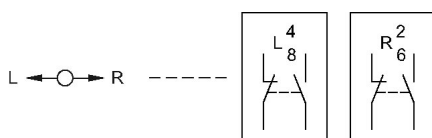

Additional information

2 positions (L-R) without latch position
lockable

Legend

Switching action: B = Momentary