

## Flush-type connector - SACC-DSI-M12FST-4P-M16XL/0,5 - 1411599

Please be informed that the data shown in this PDF Document is generated from our Online Catalog. Please find the complete data in the user's documentation. Our General Terms of Use for Downloads are valid (<http://phoenixcontact.com/download>)



Flush-type connector, Power, 4-position, SocketLink:M12, T power, Rear mounting, M16 x 1.5, Individual wires, Cable length: 0.5 m



### Key Commercial Data

Packing unit	1 pc
GTIN	 4 046356 936064
Weight per Piece (excluding packing)	22.22 g
Custom tariff number	85366990
Country of origin	Germany
Product key	ABQEAB
Note	Made to Order (non-returnable)

### Technical data

#### Dimensions

Length of cable	0.5 m
-----------------	-------

#### Ambient conditions

Ambient temperature (operation)	-25 °C ... 85 °C (Plug / socket)
	-40 °C ... 85 °C (without mechanical actuation)
Degree of protection	IP67

#### General

Note	The electrical and mechanical data specified assume that the connector pair is correctly locked and mounted. If the connector is unlocked and if there is a danger of contamination, the connector must be sealed using a protective cap > IP54. Influences arising from litz wires, cables or PCB assembly must also be taken into consideration.
Rated current at 40°C	12 A
Rated voltage	60 V
Rated surge voltage	1.5 kV
Number of positions	4

# Flush-type connector - SACC-DSI-M12FST-4P-M16XL/0,5 - 1411599

## Technical data

### General

Insulation resistance	≥ 100 MΩ
Coding	T power
Standards/regulations	M12 connector
Signal type/category	Power
Status display	No
Overvoltage category	III
Pollution degree	3
Connection method	Individual wires
Insertion/withdrawal cycles	> 100
Torque	0.8 Nm ... 1.3 Nm (Installation-side)
Mounting type	Rear mounting M16 x 1.5 With flat nut
Assembly instructions	Tightening limitation

### Material

Flammability rating according to UL 94	V0
Contact material	CuZn
Contact surface material	Au
Contact carrier material	PA
Material, knurls	Zinc die-cast, nickel-plated
Sealing material	FKM

### Cable

Cable type	PP litz wire
Conductor cross section	1.5 mm <sup>2</sup>
AWG signal line	16
Wire colors	Black, brown, blue, white
Material conductor insulation	PP
Conductor material	Bare Cu litz wires
Ambient temperature (operation)	-40 °C ... 90 °C (cable, fixed installation)
	-30 °C ... 90 °C (cable, flexible installation)

### Standards and Regulations

Standard designation	M12 connector
Flammability rating according to UL 94	V0

## Classifications

### eCl@ss

eCl@ss 5.1	27143423
eCl@ss 6.0	27143423
eCl@ss 8.0	27440103

# Flush-type connector - SACC-DSI-M12FST-4P-M16XL/0,5 - 1411599

## Classifications

### ETIM

ETIM 4.0	EC002061
ETIM 5.0	EC002061

## Approvals

### Approvals

#### Approvals

UL Listed / cUL Listed / cULus Listed

#### Ex Approvals

#### Approvals submitted

## Approval details

UL Listed	
mm <sup>2</sup> /AWG/kcmil	16
Nominal current I <sub>N</sub>	12 A
Nominal voltage U <sub>N</sub>	63 V

cUL Listed	
mm <sup>2</sup> /AWG/kcmil	16
Nominal current I <sub>N</sub>	12 A
Nominal voltage U <sub>N</sub>	63 V

cULus Listed	
--------------	--

## Drawings

# Flush-type connector - SACC-DSI-M12FST-4P-M16XL/0,5 - 1411599

Schematic diagram

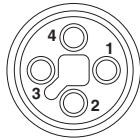

Connector pin assignment of M12 socket, 4-pos.,  
T-coded, view of socket side

Dimensional drawing

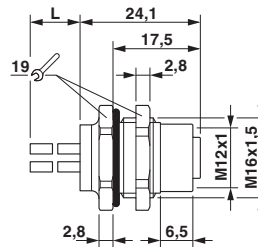

M12 flush-type plug

Circuit diagram

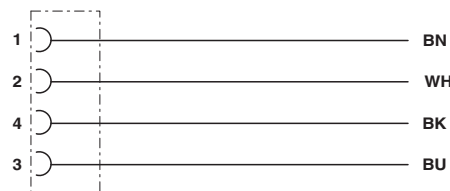

Contact assignment of the M12 socket