

Neodymium Countersunk Shallow Pot Magnet Datasheet

- Zinc plated body
- 80°C operating temperature
- Easily secured in position using a countersunk screw
- Used in point of sale displays, False Ceilings, light fixtures and fittings and general holding applications



Product Information

Part Number	Diameter mm	Height mm	Hole size mm	Screw head	Weight g	Pull force kg	Units/ Pack
E998/NEO	10	4.5	3	M3	2	1.3	20
E998/NEO	13	4.5	3	M3	3	3	20
E1000/NEO	16	4.5	3.5	M3	6	7.5	20
E1001/NEO	20	6	4.5	M4	13	10.5	10
E1002/NEO	25	7	4.5	M4	24	16	10
E1003/NEO	32	7	5.5	M5	39	31	10
E1004/NEO	40	8	5.5	M5	73	50	5
E1005/NEO	48	11.5	8.5	M8	120	87	1

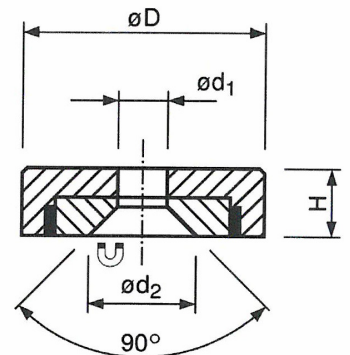

If you have any more questions, require technical assistance and would like a quotation, contact us.

www.eclipsemagnetics.com

Eclipse Magnetics Ltd, Atlas Way, Sheffield, S4 7QQ, England

T +44 (0)114 225 0600 F +44 (0)114 225 0525 E info@eclipsemagnetics.com W www.eclipsemagnetics.com

While every effort has been made to ensure the accuracy of the information in this publication please note that specifications may change without notice.