

PLEASE CHECK WWW.MOLEX.COM FOR LATEST PART INFORMATION

Part Number: [0190690045](#)
Status: **Active**
Overview: Solderless Terminals
Description: Krimptite™ Ring Tongue Terminal for 18-22 AWG Wire

Documents:

[Drawing \(PDF\)](#) [Product Specification PS-19902-013 \(PDF\)](#)
[Product Specification PS-19902-011 \(PDF\)](#) [RoHS Certificate of Compliance \(PDF\)](#)

Agency Certification

CSA LR18689
 UL E32244

General

Product Family Ring and Spade Terminals
 Series [19069](#)
 Crimp Quality Equipment Yes
 Mil-Spec N/A
 Overview [Solderless Terminals](#)
 Product Name Krimptite™
 Type Ring
 UPC 800755066401

Physical

Barrel Type Closed
 Insulation None
 Material - Plating Mating Tin
 Material - Plating Termination Tin
 Net Weight 0.672/g
 Packaging Type Bag
 Plating min - Mating 2.540µm
 Plating min - Termination 2.540µm
 Stud Size 5/16" (M8)
 Termination Interface: Style Crimp or Compression
 Wire Size AWG 18, 20, 22
 Wire Size mm² 0.35-0.80

Solder Process Data

Lead-free Process Capability N/A

Material Info

Old Part Number AA-122-56

Reference - Drawing Numbers

Product Specification PS-19902-011, PS-19902-013
 Sales Drawing SD-19069-004, SD-19069-020

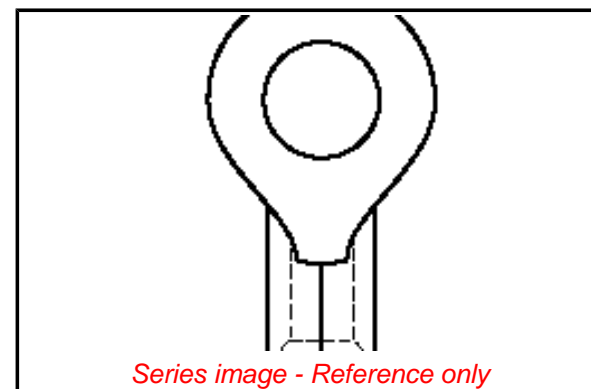

Series image - Reference only

EU ELV

Not Relevant

EU RoHS

Compliant

REACH SVHC

Contains SVHC(2015
 June 15): No

Halogen-Free

Status

Low-Halogen

**Need more information on product
 environmental compliance?**

Email productcompliance@molex.com
 Please visit the [Contact Us](#) section for any
 non-product compliance questions.

China ROHS

ELV

China RoHS

Green Image

Not Relevant

Search Parts in this Series

[19069 Series](#)

Application Tooling | [FAQ](#)

*Tooling specifications and manuals are
 found by selecting the products below.
 Crimp Height Specifications are then
 contained in the Application Tooling
 Specification document.*

Global

| Description | Product # |
|--|----------------------------|
| Crimp Head for the AT-200™ Pneumatic Hand Tool | 0640070100 |
| PremiumGrade™ Hand Crimp Tool | 0640030100 |