

Vpro-ECblue

for single phase alternating current, 200-277 V

RH19V-6IP



Description

Motor technology: EC
 Rated voltage U: 1-200-277 V*
 Rated frequency f: 50/60 Hz*
 Motor input power P: 0.12 kW*
 Rated current I: 0.94-0.68 A*
 Rated speed n: 3490 min⁻¹*
 Thermal class: THCL155*
 Min. permitted ambient temperature t_{R} : - 5 °C
 Max. permitted ambient temperature t_{R} at n_{max} : 60 °C
 Electrical connection: Integrated controller with attached cable
 Number of blades : 6
 Balancing quality: G 6.3
 Protection class: IP44
 Motor protection: Integrated active temperature management
 Impeller : High Performance Composite Material, uncoated, black
 Conformity: CE
ErP-data
 Not subject to ErP regulations ($P_1 < 125$ W)
 *Rated data

Characteristic curve

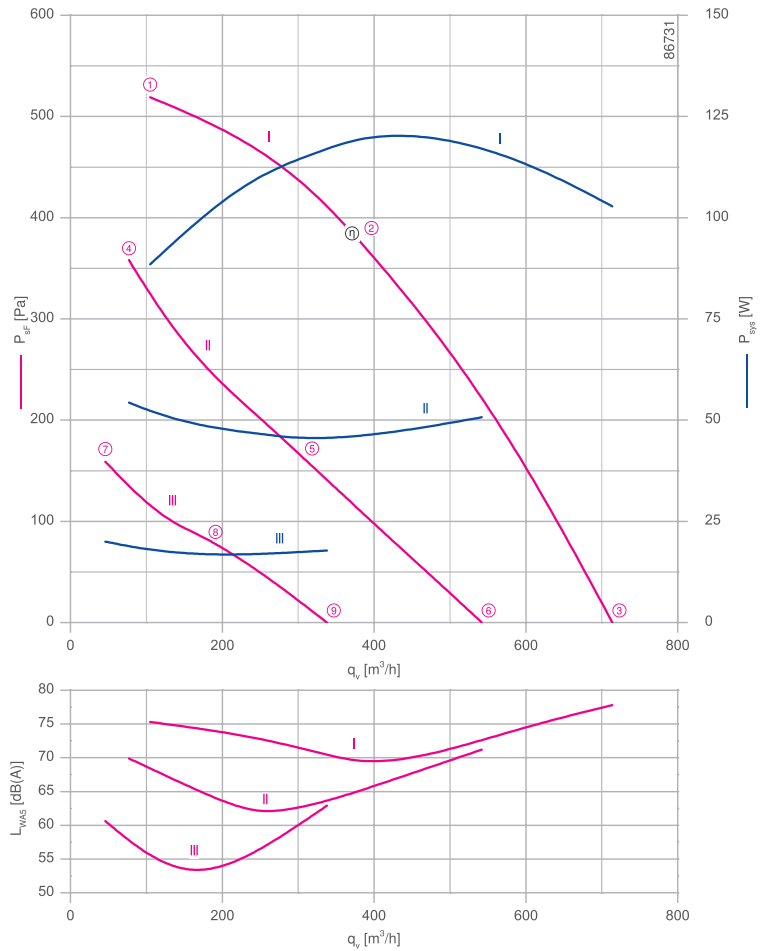

measured with inlet ring, without guard grille according to ISO 5801

- Inlet ring 00407897 Page 450
- Connection diagram KT00036A Page 547
- System components Page 448

Dimensions [mm]

Free-running motor impeller RH
in installation position H/Vu/Vo

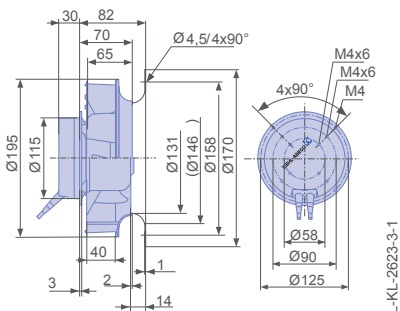

Performance data

Type	Characteristic curve	Speed	Operating point	Current	Motor input power	Suction side sound power level
		%		I [A]	P _{sys} [W]	L _{WA5} [dB]
RH19V-6IP.0B.1R	I	100	①	0.64	90	75
			②	0.82	120	70
			③	0.72	100	78
	II	60	④	0.42	55	70
			⑤	0.42	55	70
			⑥	0.38	50	71
	III	40	⑦	0.17	20	61
			⑧	0.17	20	61
			⑨	0.16	18	63

Current values determined at 230V

Fan ordering information

Design RH*

Installation position H/Vu/Vo



Type RH19V-6IP.0B.1R

Basic electronics

Article no. 113246

Weight [kg] 2.00

* Inlet ring not included

Control technology

Control module



➤ Page 464

Operating terminal



➤ Page 476

Expansion module



➤ Page 473