

Vpro-ECblue

for single phase alternating current, 200-277 V

RH22V-6IP



Description

Motor technology: EC
 Rated voltage U: 1-200-277 V*
 Rated frequency f: 50/60 Hz*
 Motor input power P: 0.14 kW*
 Rated current I: 1.05-0.77 A*
 Rated speed n: 3280 min⁻¹*
 Thermal class: THCL155*
 Min. permitted ambient temperature t_R: - 5 °C
 Max. permitted ambient temperature t_R at n_{max}: 60 °C
 Electrical connection: Integrated controller with attached cable
 Number of blades : 6
 Balancing quality: G 6.3
 Protection class: IP44
 Motor protection: Integrated active temperature management
 Impeller : High Performance Composite Material, uncoated, black
 Conformity: CE
ErP-data
 Not subject to ErP regulations (P_i < 125 W)
 *Rated data

Characteristic curve

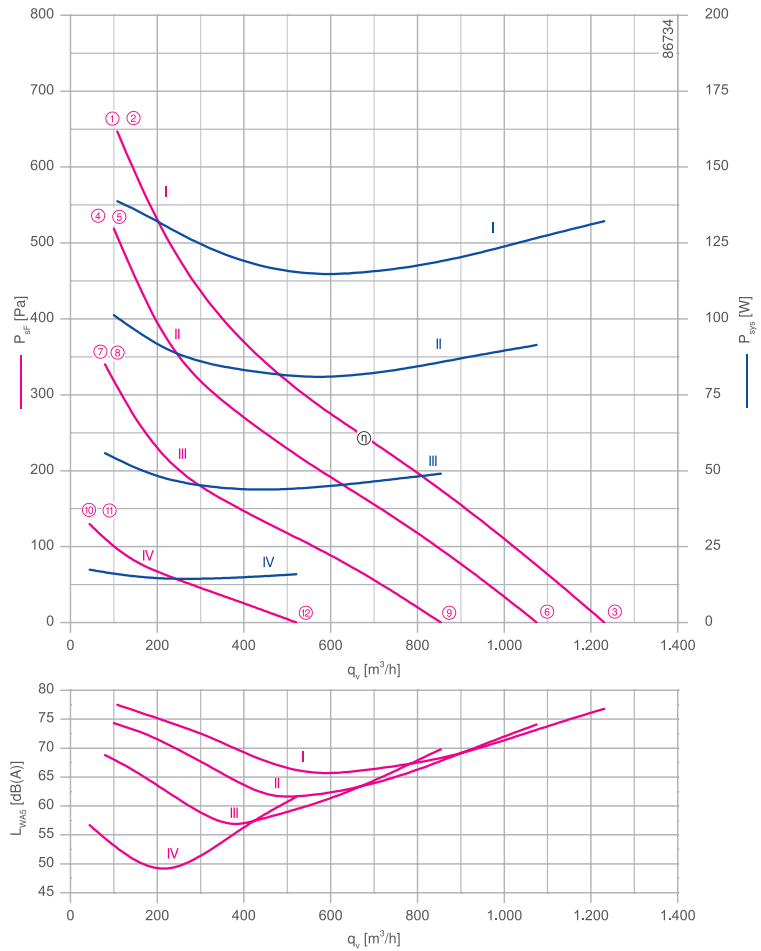

measured with inlet ring, without guard grille according to ISO 5801

- Inlet ring 00407899 Page 450
- Connection diagram KT00036A Page 547
- System components Page 448

Dimensions [mm]

Free-running motor impeller RH
in installation position H/Vu/Vo

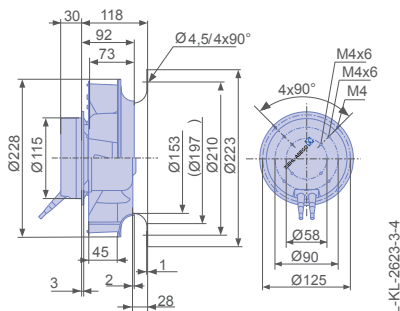

Performance data

Type	Characteristic curve	Speed %	Operating point	Current	Motor input power	Suction side sound power level
				I [A]	P _{sys} [W]	L _{WA5} [dB]
RH22V-6IP.0B.2R	I	100	①	0.94	140	78
			②	0.94	140	78
			③	0.88	130	77
	II	80	④	0.70	100	74
			⑤	0.70	100	74
			⑥	0.62	90	74
	III	60	⑦	0.40	55	69
			⑧	0.40	55	69
			⑨	0.36	50	70
	IV	40	⑩	0.19	17	57
			⑪	0.19	17	57
			⑫	0.18	16	62

Current values determined at 230V

Fan ordering information

Design RH*

Installation position H/Vu/Vo



Type RH22V-6IP.0B.2R

Basic electronics

Article no. 113249

Weight [kg] 2.20

* Inlet ring not included

Control technology

Control module



➤ Page 464

Operating terminal



➤ Page 476

Expansion module



➤ Page 473