

| | | | | | |
|----------------------|--------------------------|------------------------------|--------------------------------|--------------------------|----------------------------|
| Home | Catalogs | Distributors | Press Releases | Products | Contact Us |
|----------------------|--------------------------|------------------------------|--------------------------------|--------------------------|----------------------------|

[Control Knobs](#)

[RETURN](#)

Manufacturer of
CLAMP KNOBS

[PRINT](#) 

[Clamp Knobs](#)

[Industrial Components](#)

[Military Knobs](#)

[Transilluminated Knobs](#)

[Transilluminated Specs](#)

[OEM Division](#)

[About Us](#)

[Catalog PDF](#)

[Distributors](#)

[Events](#)

[Press Releases](#)

[Govt NSN Stock](#)

[Distributor Login](#)

[Rep Login](#)

[ISO-9001 Certification](#)



Description

| | |
|----------------------------|---------------|
| Knob Shape | 2-Prong Knob |
| Knob Style | T-Knob |
| Material | Thermoplastic |
| Insert | Steel Stud |
| Insert or Stud Measurement | English |

Dimension Chart

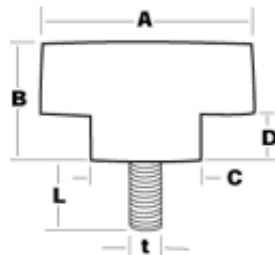

[SHOW METRIC SIZES](#)



Part-Family Table

Click on the part number you choose for complete part description and prices

| Part Number | A | B | C | D | t | L |
|--------------------------------|-------|-------|-------|-------|---------|-------|
| 052P20S-311810 | 1.970 | 0.940 | 0.590 | 0.350 | 5/16-18 | 1.000 |
| 052P11S-102450 | 1.100 | 0.510 | 0.430 | 0.120 | 10-24 | 0.500 |
| 052P11S-102475 | 1.100 | 0.510 | 0.430 | 0.120 | 10-24 | 0.750 |
| 052P11S-252010 | 1.100 | 0.510 | 0.430 | 0.120 | 1/4-20 | 1.000 |
| 052P15S-252010 | 1.570 | 0.790 | 0.590 | 0.310 | 1/4-20 | 1.000 |
| 052P15S-252015 | 1.570 | 0.790 | 0.590 | 0.310 | 1/4-20 | 1.500 |
| 052P15S-311812 | 1.570 | 0.790 | 0.590 | 0.310 | 5/16-18 | 1.250 |
| 052P20S-371615 | 1.970 | 0.940 | 0.590 | 0.350 | 3/8-16 | 1.500 |
| 052P23S-371610 | 2.360 | 1.180 | 0.750 | 0.470 | 3/8-16 | 1.000 |
| 052P11S-252050 | 1.100 | 0.510 | 0.430 | 0.120 | 1/4-20 | 0.500 |

Contact Us

Request Information

Request a Quote

| | | | | | | |
|--------------------------------|-------|-------|-------|-------|---------|-------|
| 052P11S-252012 | 1.100 | 0.510 | 0.430 | 0.120 | 1/4-20 | 1.250 |
| 052P15S-311850 | 1.500 | 0.790 | 0.590 | 0.310 | 5/16-18 | 0.500 |
| 052P15S-252050 | 1.500 | 0.790 | 0.590 | 0.310 | 1/4-20 | 0.500 |
| 052P15S-311810 | 1.500 | 0.790 | 0.590 | 0.310 | 5/16-18 | 1.000 |
| 052P20S-252050 | 2.000 | 0.940 | 0.590 | 0.350 | 1/4-20 | 0.500 |
| 052P20S-252010 | 2.000 | 0.940 | 0.590 | 0.350 | 1/4-20 | 1.000 |
| 052P20S-311850 | 2.000 | 0.940 | 0.590 | 0.350 | 5/16-18 | 0.500 |
| 052P23S-252075 | 2.360 | 1.180 | 0.750 | 0.470 | 1/4-20 | 0.750 |
| 052P23S-252015 | 2.360 | 1.180 | 0.750 | 0.470 | 1/4-20 | 1.500 |
| 052P23S-311850 | 2.360 | 1.180 | 0.750 | 0.470 | 5/16-18 | 0.500 |
| 052P23S-311810 | 2.360 | 1.180 | 0.750 | 0.470 | 5/16-18 | 1.000 |
| 052P23S-311815 | 2.360 | 1.180 | 0.750 | 0.470 | 5/16-18 | 1.500 |
| 052P23S-371675 | 2.360 | 1.180 | 0.750 | 0.470 | 3/8-16 | 0.750 |
| 052P23S-371615 | 2.360 | 1.180 | 0.750 | 0.470 | 3/8-16 | 1.500 |
| 052P20S-311815 | 2.0 | .94 | .59 | .35 | 5/16-18 | 1.5 |



EHC Search:

Search



Beyond control knobs . . . Components and assemblies within your reach.



Electronic Hardware Corporation · 320 Broad Hollow Road, Farmingdale, NY 11735
Phone: 631-752-1950 Fax: 631-752-1971 www.ehcknobs.com Email: sales@ehcknobs.com 1-800-752-1680

Associated Companies: EHC · SSI
Facilities in New York, California, United Kingdom and Shanghai, China

