



October 2014

## 2N3904 / MMBT3904 / PZT3904 NPN General-Purpose Amplifier

### Description

This device is designed as a general-purpose amplifier and switch. The useful dynamic range extends to 100 mA as a switch and to 100 MHz as an amplifier.

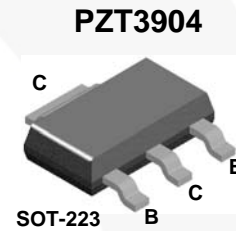
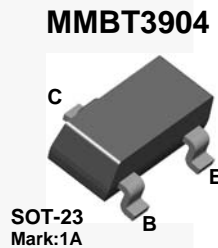

### Ordering Information

| Part Number | Marking | Package    | Packing Method | Pack Quantity |
|-------------|---------|------------|----------------|---------------|
| 2N3904BU    | 2N3904  | TO-92 3L   | Bulk           | 10000         |
| 2N3904TA    | 2N3904  | TO-92 3L   | Ammo           | 2000          |
| 2N3904TAR   | 2N3904  | TO-92 3L   | Ammo           | 2000          |
| 2N3904TF    | 2N3904  | TO-92 3L   | Tape and Reel  | 2000          |
| 2N3904TFR   | 2N3904  | TO-92 3L   | Tape and Reel  | 2000          |
| MMBT3904    | 1A      | SOT-23 3L  | Tape and Reel  | 3000          |
| PZT3904     | 3904    | SOT-223 4L | Tape and Reel  | 2500          |

2N3904 / MMBT3904 / PZT3904 — NPN General-Purpose Amplifier

## Absolute Maximum Ratings<sup>(1), (2)</sup>

Stresses exceeding the absolute maximum ratings may damage the device. The device may not function or be operable above the recommended operating conditions and stressing the parts to these levels is not recommended. In addition, extended exposure to stresses above the recommended operating conditions may affect device reliability. The absolute maximum ratings are stress ratings only. Values are at  $T_A = 25^\circ\text{C}$  unless otherwise noted.

| Symbol         | Parameter  | Value      | Unit             |
|----------------|--|------------|------------------|
| $V_{CEO}$      | Collector-Emitter Voltage                        | 40         | V                |
| $V_{CBO}$      | Collector-Base Voltage                           | 60         | V                |
| $V_{EBO}$      | Emitter-Base Voltage                             | 6.0        | V                |
| $I_C$          | Collector Current - Continuous                   | 200        | mA               |
| $T_J, T_{STG}$ | Operating and Storage Junction Temperature Range | -55 to 150 | $^\circ\text{C}$ |

### Notes:

1. These ratings are based on a maximum junction temperature of  $150^\circ\text{C}$ .
2. These are steady-state limits. Fairchild Semiconductor should be consulted on applications involving pulsed or low-duty cycle operations.

## Thermal Characteristics

Values are at  $T_A = 25^\circ\text{C}$  unless otherwise noted.

| Symbol          | Parameter                               | Maximum |                         |                        | Unit                       |
|-----------------|---|---------|-------------------------|------------------------|----------------------------|
|                 |   | 2N3904  | MMBT3904 <sup>(3)</sup> | PZT3904 <sup>(4)</sup> |                            |
| $P_D$           | Total Device Dissipation                | 625     | 350                     | 1,000                  | mW                         |
|                 | Derate Above $25^\circ\text{C}$         | 5.0     | 2.8                     | 8.0                    | $\text{mW}/^\circ\text{C}$ |
| $R_{\theta JC}$ | Thermal Resistance, Junction to Case    | 83.3    |                         |                        | $^\circ\text{C}/\text{W}$  |
| $R_{\theta JA}$ | Thermal Resistance, Junction to Ambient | 200     | 357                     | 125                    | $^\circ\text{C}/\text{W}$  |

### Notes:

3. Device is mounted on FR-4 PCB 1.6 inch X 1.6 inch X 0.06 inch.
4. Device is mounted on FR-4 PCB 36 mm X 18 mm X 1.5 mm, mounting pad for the collector lead minimum  $6\text{ cm}^2$ .

## Electrical Characteristics

Values are at  $T_A = 25^\circ\text{C}$  unless otherwise noted.

| Symbol                                  | Parameter                            | Conditions   | Min. | Max. | Unit |
|---|--------------------------------------|--|------|------|------|
| <b>OFF CHARACTERISTICS</b>              |                                      |  |      |      |      |
| $V_{(BR)CEO}$                           | Collector-Emitter Breakdown Voltage  | $I_C = 1.0\text{ mA}, I_B = 0$   | 40   |      | V    |
| $V_{(BR)CBO}$                           | Collector-Base Breakdown Voltage     | $I_C = 10\text{ }\mu\text{A}, I_E = 0$   | 60   |      | V    |
| $V_{(BR)EBO}$                           | Emitter-Base Breakdown Voltage       | $I_E = 10\text{ }\mu\text{A}, I_C = 0$   | 6.0  |      | V    |
| $I_{BL}$                                | Base Cut-Off Current                 | $V_{CE} = 30\text{ V}, V_{EB} = 3\text{ V}$  |      | 50   | nA   |
| $I_{CEX}$                               | Collector Cut-Off Current            | $V_{CE} = 30\text{ V}, V_{EB} = 3\text{ V}$  |      | 50   | nA   |
| <b>ON CHARACTERISTICS<sup>(5)</sup></b> |                                      |  |      |      |      |
| $h_{FE}$                                | DC Current Gain                      | $I_C = 0.1\text{ mA}, V_{CE} = 1.0\text{ V}$   | 40   |      |      |
|   |                                      | $I_C = 1.0\text{ mA}, V_{CE} = 1.0\text{ V}$   | 70   |      |      |
|   |                                      | $I_C = 10\text{ mA}, V_{CE} = 1.0\text{ V}$  | 100  | 300  |      |
|   |                                      | $I_C = 50\text{ mA}, V_{CE} = 1.0\text{ V}$  | 60   |      |      |
|   |                                      | $I_C = 100\text{ mA}, V_{CE} = 1.0\text{ V}$   | 30   |      |      |
| $V_{CE(sat)}$                           | Collector-Emitter Saturation Voltage | $I_C = 10\text{ mA}, I_B = 1.0\text{ mA}$  |      | 0.2  | V    |
|   |                                      | $I_C = 50\text{ mA}, I_B = 5.0\text{ mA}$  |      | 0.3  |      |
| $V_{BE(sat)}$                           | Base-Emitter Saturation Voltage      | $I_C = 10\text{ mA}, I_B = 1.0\text{ mA}$  | 0.65 | 0.85 | V    |
|   |                                      | $I_C = 50\text{ mA}, I_B = 5.0\text{ mA}$  |      | 0.95 |      |
| <b>SMALL SIGNAL CHARACTERISTICS</b>     |                                      |  |      |      |      |
| $f_T$                                   | Current Gain - Bandwidth Product     | $I_C = 10\text{ mA}, V_{CE} = 20\text{ V},$<br>$f = 100\text{ MHz}$  | 300  |      | MHz  |
| $C_{obo}$                               | Output Capacitance                   | $V_{CB} = 5.0\text{ V}, I_E = 0,$<br>$f = 100\text{ kHz}$  |      | 4.0  | pF   |
| $C_{ibo}$                               | Input Capacitance                    | $V_{EB} = 0.5\text{ V}, I_C = 0,$<br>$f = 100\text{ kHz}$  |      | 8.0  | pF   |
| NF                                      | Noise Figure                         | $I_C = 100\text{ }\mu\text{A}, V_{CE} = 5.0\text{ V},$<br>$R_S = 1.0\text{ k}\Omega,$<br>$f = 10\text{ Hz to }15.7\text{ kHz}$ |      | 5.0  | dB   |
| <b>SWITCHING CHARACTERISTICS</b>        |                                      |  |      |      |      |
| $t_d$                                   | Delay Time                           | $V_{CC} = 3.0\text{ V}, V_{BE} = 0.5\text{ V}$<br>$I_C = 10\text{ mA}, I_{B1} = 1.0\text{ mA}$                                 |      | 35   | ns   |
| $t_r$                                   | Rise Time                            |  |      | 35   | ns   |
| $t_s$                                   | Storage Time                         | $V_{CC} = 3.0\text{ V}, I_C = 10\text{ mA},$<br>$I_{B1} = I_{B2} = 1.0\text{ mA}$  |      | 200  | ns   |
| $t_f$                                   | Fall Time                            |  |      | 50   | ns   |

**Note:**

5. Pulse test: pulse width  $\leq 300\text{ }\mu\text{s}$ , duty cycle  $\leq 2.0\%$ .

## Typical Performance Characteristics



Figure 1. Typical Pulsed Current Gain vs. Collector Current



Figure 2. Collector-Emitter Saturation Voltage vs. Collector Current

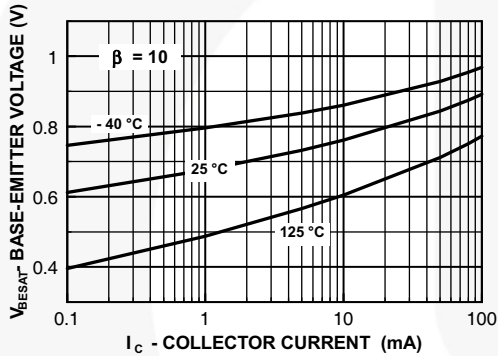

Figure 3. Base-Emitter Saturation Voltage vs. Collector Current



Figure 4. Base-Emitter On Voltage vs. Collector Current



Figure 5. Collector Cut-Off Current vs. Ambient Temperature

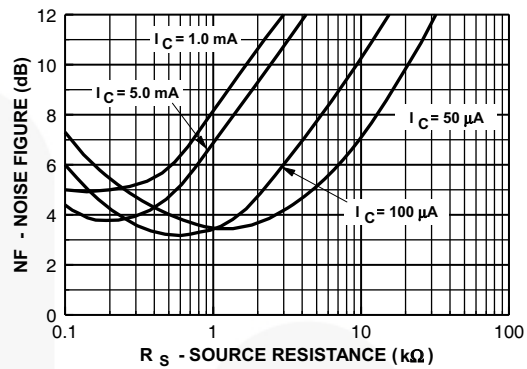

Figure 6. Capacitance vs. Reverse Bias Voltage

**Typical Performance Characteristics (Continued)**



**Figure 7. Noise Figure vs. Frequency**



**Figure 8. Noise Figure vs. Source Resistance**



**Figure 9. Current Gain and Phase Angle vs. Frequency**

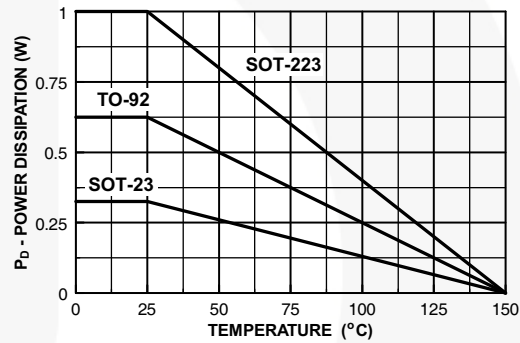

**Figure 10. Power Dissipation vs. Ambient Temperature**



**Figure 11. Turn-On Time vs. Collector Current**

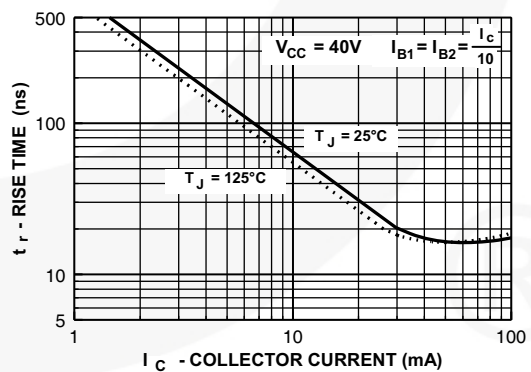

**Figure 12. Rise Time vs. Collector Current**

Typical Performance Characteristics (Continued)



Figure 13. Storage Time vs. Collector Current

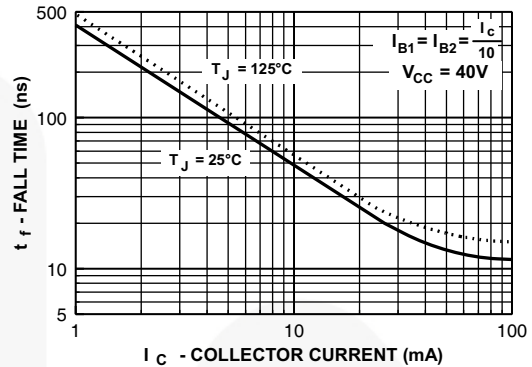

Figure 14. Fall Time vs. Collector Current



Figure 15. Current Gain

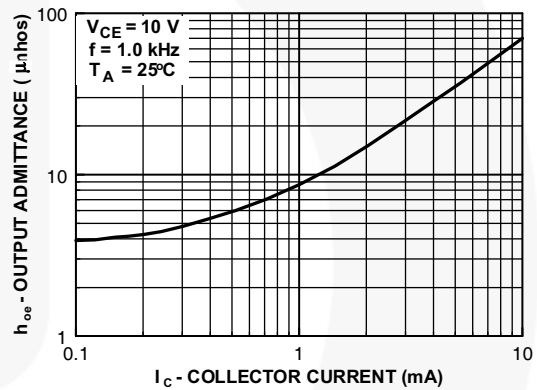

Figure 16. Output Admittance

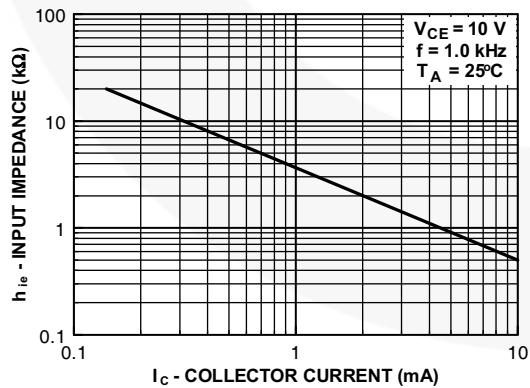

Figure 17. Input Impedance



Figure 18. Voltage Feedback Ratio

Test Circuits



Figure 19. Delay and Rise Time Equivalent Test Circuit



Figure 20. Storage and Fall Time Equivalent Test Circuit



NOTES: UNLESS OTHERWISE SPECIFIED

- A. DRAWING CONFORMS TO JEDEC MS-013, VARIATION AC.
- B. ALL DIMENSIONS ARE IN MILLIMETERS.
- C. DRAWING CONFORMS TO ASME Y14.5M-2009.
- D. DRAWING FILENAME: MKT-ZA03FREV3.
- E. FAIRCHILD SEMICONDUCTOR.



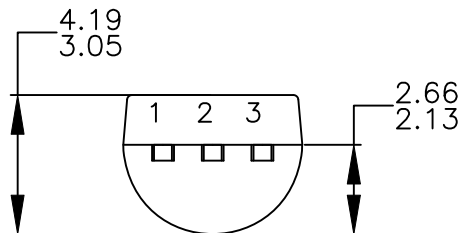
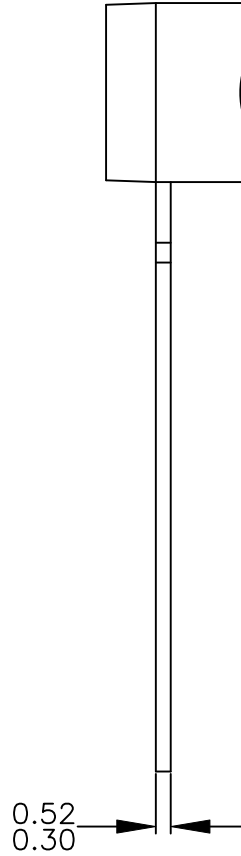
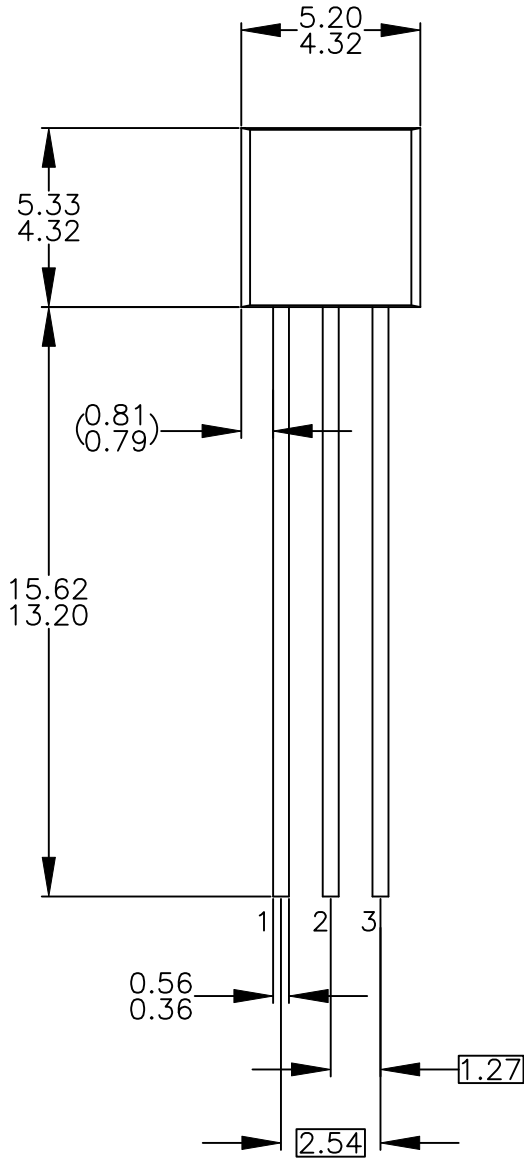

NOTES: UNLESS OTHERWISE SPECIFIED

- A) DRAWING WITH REFERENCE TO JEDEC TO-92 RECOMMENDATIONS.
- B) ALL DIMENSIONS ARE IN MILLIMETERS.
- C) DRAWING CONFORMS TO ASME Y14.5M-2009.
- D) DRAWING FILENAME: MKT-ZA03DREV4.



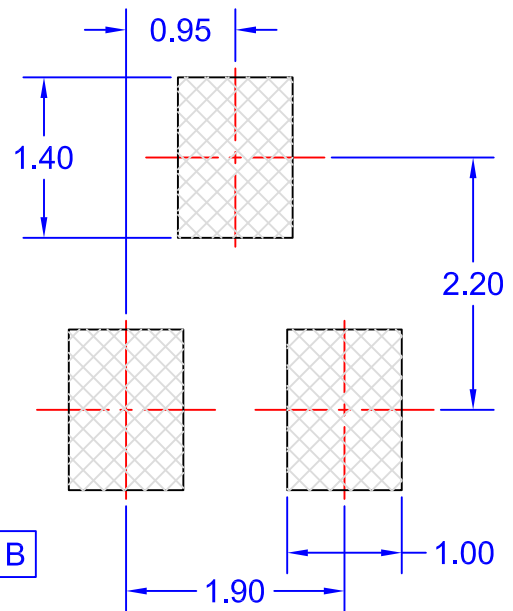
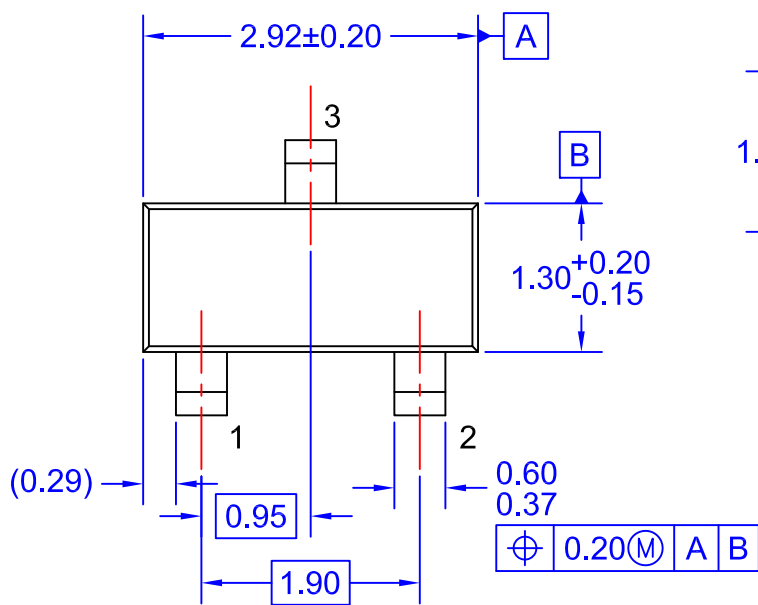

LAND PATTERN  
RECOMMENDATION

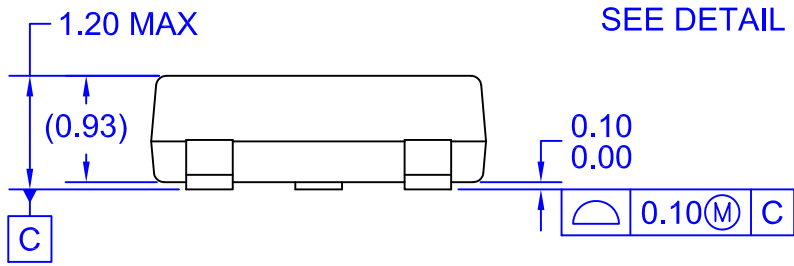

SEE DETAIL A

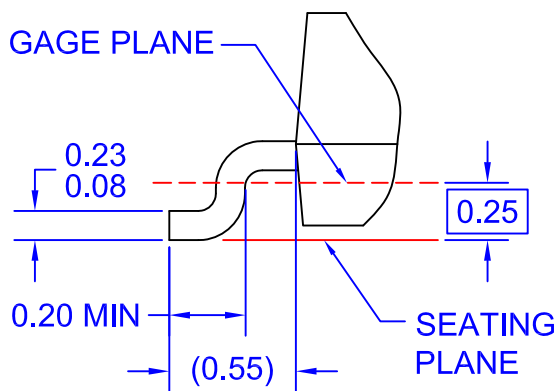
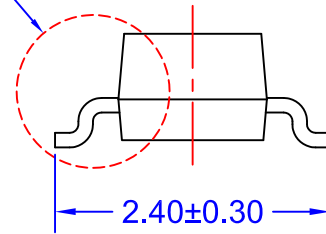

**DETAIL A**  
SCALE: 2X

NOTES: UNLESS OTHERWISE SPECIFIED

- A) REFERENCE JEDEC REGISTRATION TO-236, VARIATION AB, ISSUE H.
- B) ALL DIMENSIONS ARE IN MILLIMETERS.
- C) DIMENSIONS ARE INCLUSIVE OF BURRS, MOLD FLASH AND TIE BAR EXTRUSIONS.
- D) DIMENSIONING AND TOLERANCING PER ASME Y14.5M - 2009.
- E) DRAWING FILE NAME: MA03DREV12



THIS DRAWING IS THE PROPERTY OF FAIRCHILD SEMICONDUCTOR CORPORATION. NO USE THEREOF SHALL BE MADE OTHER THAN AS A REFERENCE FOR PROPOSALS AS SUBMITTED TO FAIRCHILD SEMICONDUCTOR CORPORATION FOR OBS TO BE EXECUTED IN CONFORMANCE WITH SUCH PROPOSALS UNLESS THE CONSENT OF SAID FAIRCHILD SEMICONDUCTOR CORPORATION HAS PREVIOUSLY BEEN OBTAINED. NO PART OF THIS DRAWING SHALL BE COPIED OR DUPLICATED OR ITS CONTENTS DISCLOSED. THE INFORMATION CONTAINED ON THIS DRAWING IS CONFIDENTIAL AND PROPRIETARY.

**APPROVED**  
July-14-2008

| REVISIONS |   |             |           |
|-----------|---|-------------|-----------|
| LTR       | DESCRIPTION   | DATE        | NAME/SITE |
| A         | RELEASE TO DOCUMENT CONTROL   | JAN.25,1996 | TL/FSCP   |
| 2         | CHG DWG TEMPLATE FR NATIONAL TO FAIRCHILD; CHG DIM STYLE FR DUAL INCH[MM] TO SINGLE, MM; CHG LD WID FR 0.74 <del>±0.03</del> TO 0.60-0.84; REMOVE PKG THICK DIM (1.6); CHG TOTAL PKG HT FR 1.8 <del>±0.05</del> TO 1.80 MAX; CHG FOOT LANDING DIM FR 0.91 MIN TO 0.60 MIN; CHG LD THICKNESS FR 0.35 <del>±0.03</del> TO 0.20-0.35; ADD DRAFT ANGLE OF MOLDED BODY TOP & BOT; CHG LD LGTH TO PKG EDGE DIM TO BASIC; CHG LD PITCH FR 2.29 BS TO 2.30 BS; CHG BODY WID FR 3.56 <del>±0.33</del> TO 3.30; CHG BODY LN FR 6.53 <del>±0.33</del> TO 6.30; CHG TOTAL PKG WID FR 6.94 <del>±0.33</del> TO 7.30; CHG PAD SIZE FR 0.99 MAX TO 0.95; CHG PAD PITCH FR 2.286 TO 2.30; CHG THERMAL TAB SIZE FR 3.28 MAX TO 3.25; CHG PAD SIZE FR 1.5 TO 1.90; CHG PAD SPACE FR 6.3 TO 6.10; CHG NOTE '2' TO 'A' W/O DATE; DEL NOTE ON LD FINISH; ADD NOTES B, C, D, E & F. | 12FEB08     | LZSC/FSCP |

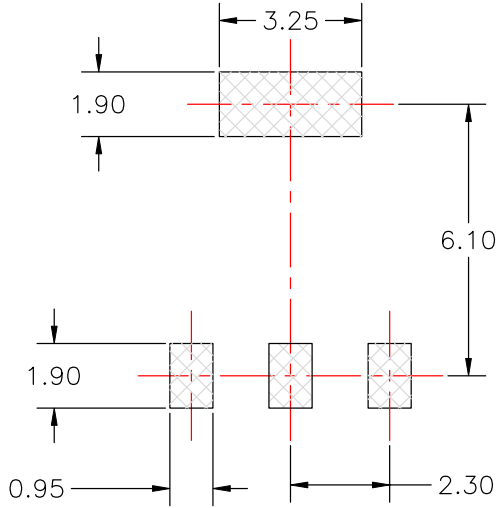
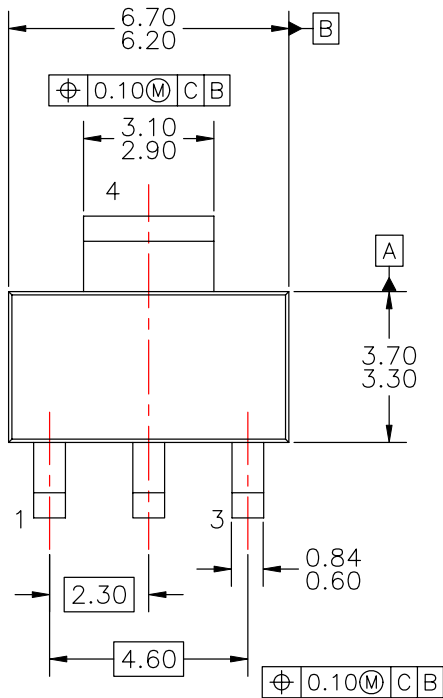

LAND PATTERN RECOMMENDATION

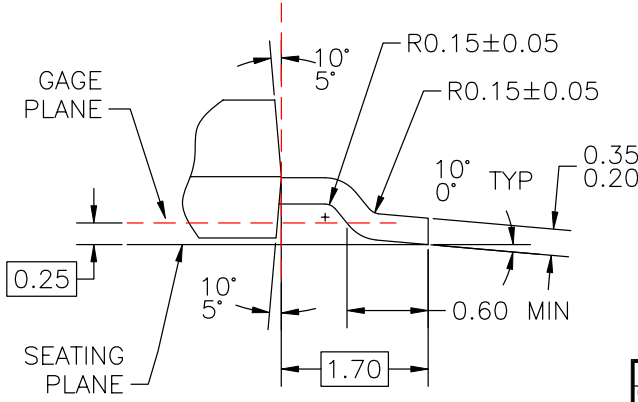
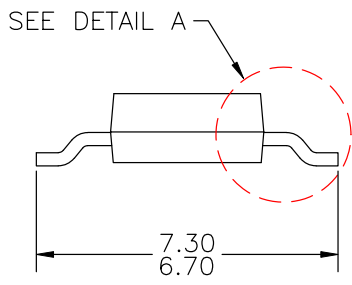
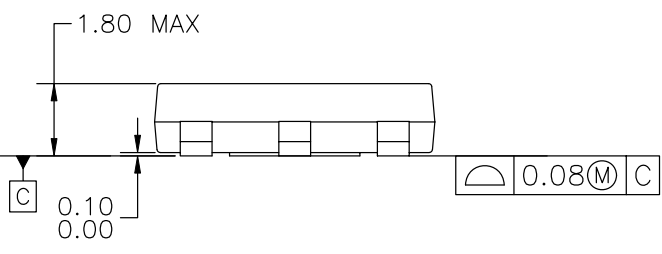

DETAIL A  
SCALE: 2:1





- NOTES: UNLESS OTHERWISE SPECIFIED
- A) DRAWING BASED ON JEDEC REGISTRATION TO-261, VARIATION AA.
  - B) DIMENSIONS ARE INCLUSIVE OF BURRS, MOLD FLASH AND TIE BAR EXTRUSIONS.
  - C) ALL DIMENSIONS ARE IN MILLIMETERS.
  - D) DRAWING CONFORMS TO ASME Y14.5M-1994.
  - E) LANDPATTERN NAME: SOT230P700X180-4BN
  - F) DRAWING FILENAME: MKT-MA04AREV2

|                                |           |   |
|--------------------------------|-----------|---|
| APPROVALS                      | DATE      | <b>FAIRCHILD</b><br>SEMICONDUCTOR™              |
| DRAWN:<br>J.U. COMPARATIVO JR. | 26FEB2008 |   |
| CHECKED:<br>L.Z. STA CRUZ      |           |   |
| APPROVED:<br>M.R. GESTOLE      |           |   |
| G.S. BAJE                      |           | <b>MOLDED PACKAGE</b><br><b>SOT-223, 4 LEAD</b> |
|                                |           | SCALE: 1:1                                      |
|                                |           | SIZE: A3  |
|                                |           | DRAWING NUMBER: MKT-MA04A                       |
|                                |           | REV: 2  |
|                                |           | FORMERLY: N/A                                   |
|                                |           | SHEET: 1 OF 1                                   |



### TRADEMARKS

The following includes registered and unregistered trademarks and service marks, owned by Fairchild Semiconductor and/or its global subsidiaries, and is not intended to be an exhaustive list of all such trademarks.

- |   |  |   |   |
|---|--|---|---|
| AccuPower™  | F-PFS™   | OPTOPLANAR®   |  |
| AttitudeEngine™   | FRFET®   |  | TinyBoost®  |
| Awinda®   | Global Power Resource <sup>SM</sup>            | Power Supply WebDesigner™   | TinyBuck®   |
| AX-CAP®*  | GreenBridge™                                   | PowerTrench®  | TinyCalc™   |
| BitSiC™   | Green FPS™                                     | PowerXS™  | TinyLogic®  |
| Build it Now™   | Green FPS™ e-Series™                           | Programmable Active Droop™  | TINYOPTO™   |
| CorePLUS™   | Gmax™  | QFET®   | TinyPower™  |
| CorePOWER™  | GTO™   | QS™   | TinyPWM™  |
| CROSSVOLT™  | IntelliMAX™                                    | Quiet Series™   | TinyWire™   |
| CTL™  | ISOPLANAR™                                     | RapidConfigure™   | TranSiC™  |
| Current Transfer Logic™   | Making Small Speakers Sound Louder and Better™ |  | TriFault Detect™  |
| DEUXPEED®   | MegaBuck™                                      | Saving our world, 1mW/W/kW at a time™   | TRUECURRENT®*   |
| Dual Cool™  | MICROCOUPLER™                                  | SignalWise™   | μSerDes™  |
| EcoSPARK®   | MicroFET™                                      | SmartMax™   |  |
| EfficientMax™   | MicroPak™                                      | SMART START™  | UHC®  |
| ESBC™   | MicroPak2™                                     | Solutions for Your Success™   | Ultra FRFET™  |
|  | MillerDrive™                                   | SPM®  | UniFET™   |
| Fairchild®  | MotionMax™                                     | STEALTH™  | VCX™  |
| Fairchild Semiconductor®  | MotionGrid®                                    | SuperFET®   | VisualMax™  |
| FACT Quiet Series™  | MTi®   | SuperSOT™-3   | VoltagePlus™  |
| FACT®   | MTx®   | SuperSOT™-6   | XS™   |
| FastvCore™  | MVN®   | SuperSOT™-8   | Xsens™  |
| FETBench™   | mWSaver®                                       | SupreMOS®   | 仙童®   |
| FPS™  | OptoHiT™                                       | SyncFET™  |   |
|   | OPTOLOGIC®                                     | Sync-Lock™  |   |

\* Trademarks of System General Corporation, used under license by Fairchild Semiconductor.

### DISCLAIMER

FAIRCHILD SEMICONDUCTOR RESERVES THE RIGHT TO MAKE CHANGES WITHOUT FURTHER NOTICE TO ANY PRODUCTS HEREIN TO IMPROVE RELIABILITY, FUNCTION, OR DESIGN. TO OBTAIN THE LATEST, MOST UP-TO-DATE DATASHEET AND PRODUCT INFORMATION, VISIT OUR WEBSITE AT [HTTP://WWW.FAIRCHILDSEMI.COM](http://www.fairchildsemi.com). FAIRCHILD DOES NOT ASSUME ANY LIABILITY ARISING OUT OF THE APPLICATION OR USE OF ANY PRODUCT OR CIRCUIT DESCRIBED HEREIN; NEITHER DOES IT CONVEY ANY LICENSE UNDER ITS PATENT RIGHTS, NOR THE RIGHTS OF OTHERS. THESE SPECIFICATIONS DO NOT EXPAND THE TERMS OF FAIRCHILD'S WORLDWIDE TERMS AND CONDITIONS, SPECIFICALLY THE WARRANTY THEREIN, WHICH COVERS THESE PRODUCTS.

### AUTHORIZED USE

Unless otherwise specified in this data sheet, this product is a standard commercial product and is not intended for use in applications that require extraordinary levels of quality and reliability. This product may not be used in the following applications, unless specifically approved in writing by a Fairchild officer: (1) automotive or other transportation, (2) military/aerospace, (3) any safety critical application – including life critical medical equipment – where the failure of the Fairchild product reasonably would be expected to result in personal injury, death or property damage. Customer's use of this product is subject to agreement of this Authorized Use policy. In the event of an unauthorized use of Fairchild's product, Fairchild accepts no liability in the event of product failure. In other respects, this product shall be subject to Fairchild's Worldwide Terms and Conditions of Sale, unless a separate agreement has been signed by both Parties.

### ANTI-COUNTERFEITING POLICY

Fairchild Semiconductor Corporation's Anti-Counterfeiting Policy. Fairchild's Anti-Counterfeiting Policy is also stated on our external website, [www.fairchildsemi.com](http://www.fairchildsemi.com), under Terms of Use

Counterfeiting of semiconductor parts is a growing problem in the industry. All manufacturers of semiconductor products are experiencing counterfeiting of their parts. Customers who inadvertently purchase counterfeit parts experience many problems such as loss of brand reputation, substandard performance, failed applications, and increased cost of production and manufacturing delays. Fairchild is taking strong measures to protect ourselves and our customers from the proliferation of counterfeit parts. Fairchild strongly encourages customers to purchase Fairchild parts either directly from Fairchild or from Authorized Fairchild Distributors who are listed by country on our web page cited above. Products customers buy either from Fairchild directly or from Authorized Fairchild Distributors are genuine parts, have full traceability, meet Fairchild's quality standards for handling and storage and provide access to Fairchild's full range of up-to-date technical and product information. Fairchild and our Authorized Distributors will stand behind all warranties and will appropriately address any warranty issues that may arise. Fairchild will not provide any warranty coverage or other assistance for parts bought from Unauthorized Sources. Fairchild is committed to combat this global problem and encourage our customers to do their part in stopping this practice by buying direct or from authorized distributors.

### PRODUCT STATUS DEFINITIONS

#### Definition of Terms

| Datasheet Identification | Product Status        | Definition  |
|--------------------------|-----------------------|---|
| Advance Information      | Formative / In Design | Datasheet contains the design specifications for product development. Specifications may change in any manner without notice.   |
| Preliminary              | First Production      | Datasheet contains preliminary data; supplementary data will be published at a later date. Fairchild Semiconductor reserves the right to make changes at any time without notice to improve design. |
| No Identification Needed | Full Production       | Datasheet contains final specifications. Fairchild Semiconductor reserves the right to make changes at any time without notice to improve the design.   |
| Obsolete                 | Not In Production     | Datasheet contains specifications on a product that is discontinued by Fairchild Semiconductor. The datasheet is for reference information only.  |

Rev. I77