

PROLINE G2 19-INCH RACK ANGLES

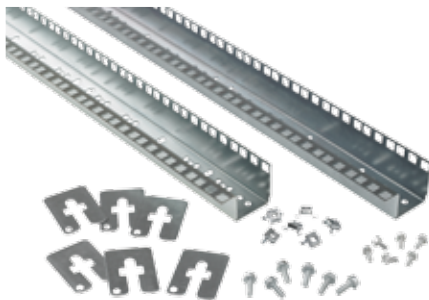

APPLICATION

19-in. Rack Angles can easily be mounted in a modular enclosure. Furnished in pairs, Rack Angles have two mounting surfaces (left and right) that serve as mounts for both rack equipment and rack accessories. Rack Angles can be attached to the frame in the front and/or the back. Adjustable Rack-Mounting Rails can be used to position Rack Angles anywhere within the modular enclosure frame.

FEATURES

- Comply with ANSI/EI A RS-310-D rack mounting standards
- Can be mounted directly to the enclosure frame or to a Grid Strap Network (Rail System) at almost any depth location
- Furnished in pairs and are available with tapped holes that directly accommodate 10-32 screws or square holes for use with cage nuts and M5, M6 or 10-32 screws

SPECIFICATIONS

- Tapped Rack Angles are 12 gauge (2.5mm) steel with 10-32 tapped holes
- Square-Hole Rack Angles are 14 gauge (1.75 mm) steel designed to accept metric or English cage nuts
- Attach directly into a 600-mm wide enclosure frame
- To mount in 800-mm wide frames, use frame reducing brackets (not included)
- 1200-mm frames require center uprights (not included) to mount in right or left section; 1600-mm frames require both center uprights and two sets of frame reducing brackets
- Optional rack mounted shelves, drawers, guides and pull-out shelves require two sets of Rack Angles or frame accessory brackets installed in the frame
- All mounting hardware to install Rack Angles is included (Hardware to attach items to the Rack Angles are either included with the item or purchased separately if necessary)

FINISH

Plated

LOAD RATING

- 20 lbs. (9.1 kg) per rack unit for equipment under 20 in. (508 mm) deep
- Equipment over 20 in. (508 mm) deep or over 20 lb. (9.1 kg) per rack unit requires rear support

ACCESSORIES

- Frame-Reducing Brackets
- Center Upright
- Rack Panels
- Pull-out Shelf
- Fixed Shelf
- Rack Angle Mounted Drawer
- Writing Surface
- Adjustable Rack-Mounting Rails
- Frame Accessory Bracket
- Guides
- Slides
- Filler Panel for Rack Angles
- Rack Angle Adapter Bracket
- Screw Package
- Cage Nut Package

BULLETIN: P40

Standard Product

Catalog Number	Fits Frame Height	Rack Units	Holder Type
P2RA19S6	600	8	SQUARE
P2RA19T6	600	8	TAPPED
P2RA19S8	800	13	SQUARE
P2RA19T8	800	13	TAPPED
P2RA19S10	1000	18	SQUARE
P2RA19T10	1000	18	TAPPED
P2RA19S12	1200	23	SQUARE
P2RA19T12	1200	23	TAPPED
P2RA19S14	1400	28	SQUARE
P2RA19T14	1400	28	TAPPED
P2RA19S16	1600	33	SQUARE
P2RA19T16	1600	33	TAPPED
P2RA19S18	1800	38	SQUARE
P2RA19T18	1800	38	TAPPED
P2RA19S20	2000	42	SQUARE
P2RA19T20	2000	42	TAPPED
P2RA19S22	2200	47	SQUARE
P2RA19T22	2200	47	TAPPED

Frame height dimensions are nominal mm.

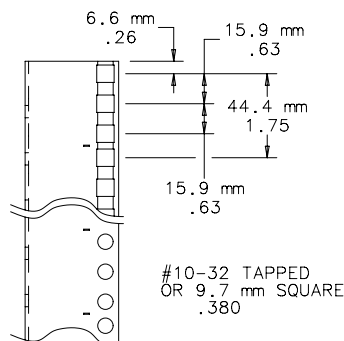
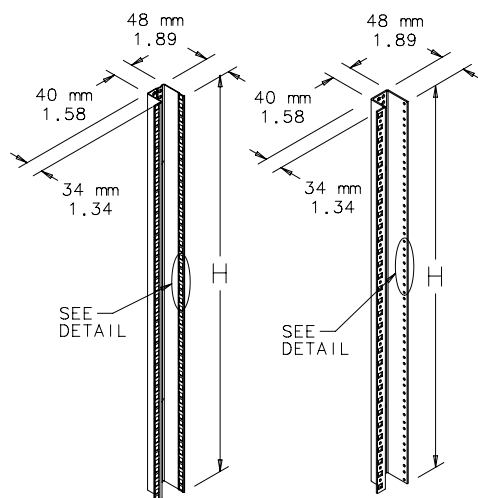

DETAIL

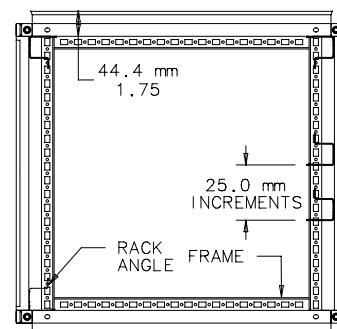

87798510

Model	Component	Type	Specialty	Height	Catalog Number
P2	R	A19	S	20	= P2RA19S20
PROLINE G2	Rack Accessory	A19 = 19" rack angle SFH = swing frame, heavy-duty	Blank = standard S = square (19" rack angle only) T = tapped (19" rack angle only)	mm 22 = 2200 20 = 2000 18 = 1800 16 = 1600 14 = 1400 12 = 1200 10 = 1000 8 = 800 6 = 600	

PROLINE G2 ADJUSTABLE RACK-MOUNTING RAILS



PROLINE G2 Adjustable Rack-Mounting Rails allow 19-in. Rack Angles to be positioned anywhere within the modular enclosure frame.

- Specifications:
- Includes two right-hand and two left-hand mounting rails
 - 12 gauge (2.5 mm) steel
 - Mounting hardware is included

Finish: Plated

BULLETIN: P40

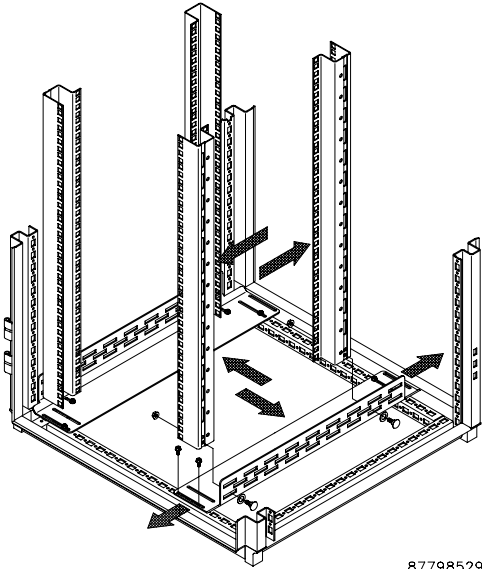

87798529

Standard Product

Catalog Number	Fits Frame Depth	Fits Frame Width
P2GARA4	400	---
P2GARA5	500	400
P2GARA6	600	---
P2GARA7	---	600
P2GARA8	800	---
P2GARA9	---	800
P2GARA10	1000	---
P2GARA11	---	1000
P2GARA13	---	1200
P2GARA15	---	1400
P2GARA17	---	1600
P2GARA19	---	1800

Frame Depth and Width dimensions are nominal mm.

PROLINE G2 FRAME-REDUCING BRACKETS

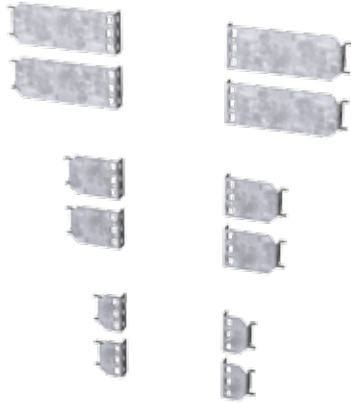

Frame-Reducing Brackets are used to reduce wider frames to 600mm, allowing 19-in. rack angles to fit.

Specifications:

- Can be used to left- or right-justify the rack-mounted equipment
- Furnished in sets of four
- 14 gauge (1.75 mm) steel
- Mounting hardware is included

Finish: Plated

BULLETIN: P40

Standard Product

Catalog Number	Fits Frame Width
P2AFRB8	800
P2AFRB10	1000

Frame width dimensions are nominal mm.

PROLINE G2 FRAME ACCESSORY BRACKETS



Frame Accessory Brackets mount directly to the PROLINE G2 frame and are used in place of rack angles to mount rack accessories such as shelves and pull-out shelves.

Specifications:

- Furnished in sets of four
- 14 gauge (1.75 mm) steel
- Mounting hardware is included

Finish: Plated

BULLETIN: P40

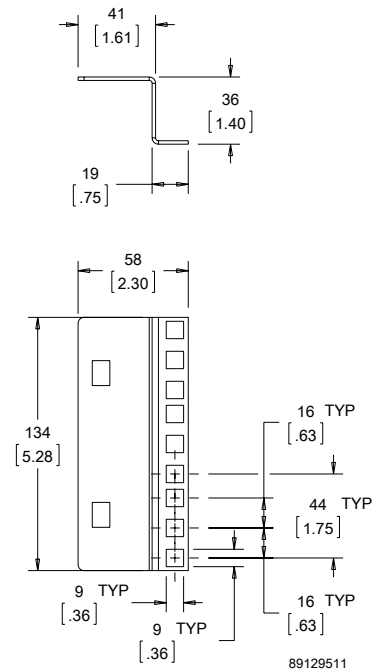

Standard Product

Catalog Number	Description
P2AFB19	Frame Accessory Bracket, 19in.

CAGE NUT PACKAGE

20 plated cage nuts are included in each package. Available in #10-32, #12-24, M5 and M6, these cage nuts fit all PROLINE rack angles with square holes.

BULLETIN: DACCY

Catalog Number	Description	Pkg. Qty.
P1032CN	10-32 thread	20
P1224CN	12-24 thread	20
PM5CN	Metric M5 thread	20
PM6CN	Metric M6 thread	20

SCREW PACKAGE

20 plated screws are included in each package. Screws attach rack panels to rack mounting angles. Available in #10-32, #12-24, M5 and M6.

BULLETIN: A80, DACCY, X20

Catalog Number	Description	Pkg. Qty.
AS1032	10-32 x .75	20
ES1224	12-24 x .5	20
ASM5	Metric M5 x 20	20
ASM6	Metric M6 x 16	20
ASM6250	Metric M6 x 16	250

Notes