

MALE-FEMALE ADAPTOR PUSH-ON	R125.791.501
	SERIES SMA

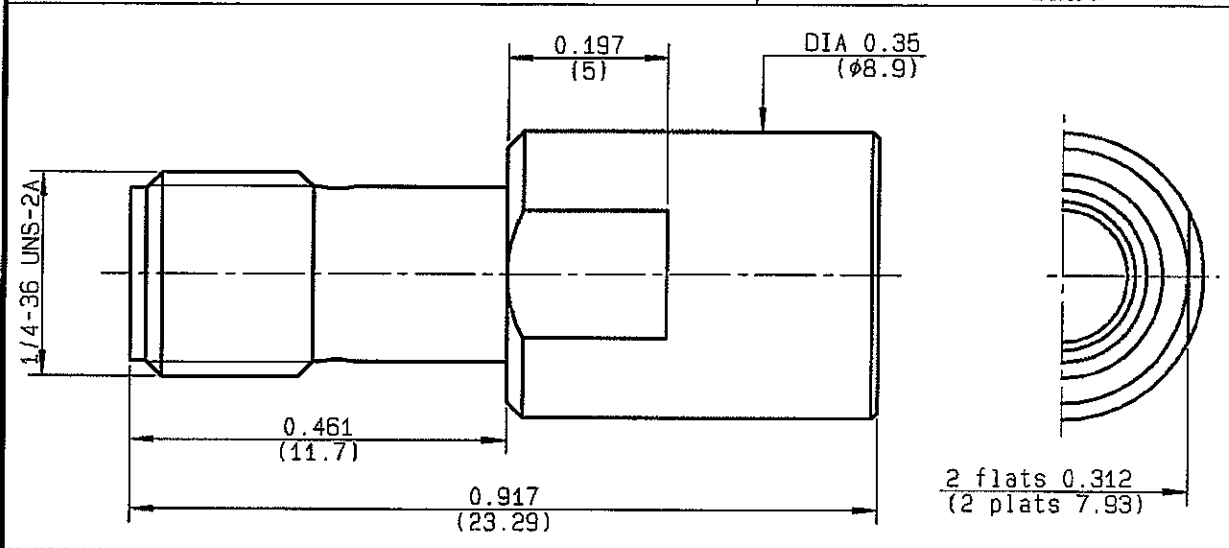

NOMINAL IMPEDANCE	50 Ω	CABLES :		
FREQUENCY RANGE	0-18 GHz			
TEMPERATURE RATING	-65/+165 °C			
V.S.W.R	1.08 + 0.01 x F(GHz)Maxi			
RF INSERTION LOSS	0.07 \sqrt{F} (GHz) dB Maxi			
VOLTAGE RATING	500 Veff Maxi			
DIELECTRIC WITHSTANDING VOLTAGE	1000 Veff Mini			
INSULATION RESISTANCE	5000 M Ω Mini		OTHERS CHARACTERISTICS	
HERMETIC SEAL	NA Atm.cm ³ /s		CABLE RETENTION	NA N Mini
LEAKAGE (pressurized only)	NA		CENTER CONTACT RETENTION	
MECHANICAL DURABILITY	500 Cycles	Axial force - mating end	27 N Mini	
WEIGHT	gr	Axial force - opposite end	27 N Mini	
SPECIFICATION		Torque	2.8 cm.N Mini	
		RECOMMENDED TORQUES		
		Mating	NA cm.N	
		Panel nut	NA cm.N	
		Clamp nut	NA cm.N	

CONNECTOR PARTS:	MATERIALS	FINISH	(all values are given in micrometers)
BODY	STAINLESS STEEL	PASSIVATED	
OUTER CONTACT	BERYLLIUM COPPER	NICKEL 2	
CENTER CONTACT	BERYLLIUM COPPER	GOLD 2.54 OVER NICKEL 2	
INSULATOR	PTFE	-	
GASKET		-	
OTHERS PIECES		-	

MASTRAND

ISSUE 0549 C	CREATION DATE 12/04/1994	FILE PART-NUMBER 94-0400-052
------------------------	------------------------------------	--



The information given here is subject to change without notice.
Design changes may be in order to improve the product.

Connect to the future