

EAO – Your Expert Partner for Human Machine Interfaces

84-8716.8620 - Switching element Halo Compact

84-8716.8620 - Switching element Halo Compact

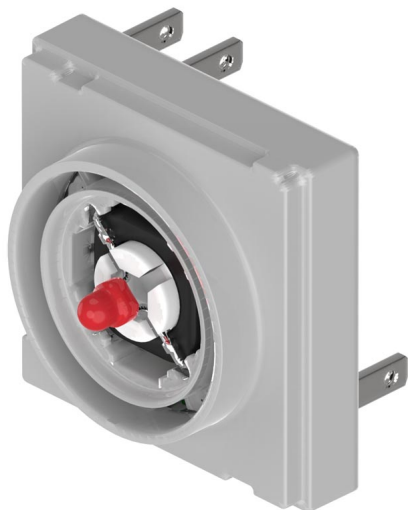

Attention: The preview is based on a sample product. This can differ from your current configuration.

Other Attributes

Weight 0.013 kg

Connection Method

Terminal Solder/Plug-in 2.8 x 0.8 mm

Switching element

Switching system Short-travel element
Contacts 1 NO
Switching current 0.1 A
Contact material gold-plated silver

Illumination

LED colour Bi-colour LED red/green

EAO – Your Expert Partner for Human Machine Interfaces

84-8716.8620 - Switching element Halo Compact

Dimensions

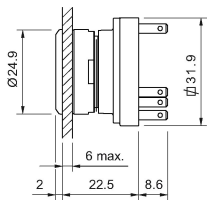

Wiring diagram



Component layout

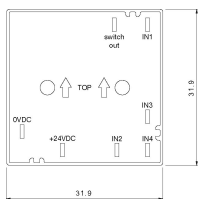

Legend

Contacts: NO = Normally open