

# CAMBLOCK

## 5mm Pitch Low Profile Terminal Block

- 2-12 pole interlocking
- Moulded in black  
UL94-V0 Flame retardant PA66
- Wire protector terminals
- Guided pin alignment
- 0.3-2 mm<sup>2</sup> (22-14 AWG)
-  us approved

CTB5202



### SPECIFICATION

Rating	16A/250V
Insulation resistance	5000MΩ/1000V
Withstand Voltage	AC1500V/1min
Contact Resistance	20mΩ (max)
Working Temperature	-33°C to 120+°C
Mouldings	UL94-V0 Flame retardant PA66
Pin/Terminal	Nickel plated brass
Wire Protector	Stainless steel
Screw/Torque	M2.5 Steel, Nickel Plated 0.4Nm
Recommended PCB hole size	ø1.3mm

TYPE NO.	POLES	LENGTH
CTB5202/2	2	10mm
CTB5202/3	3	15mm
CTB5202/4	4	20mm
CTB5202/5	5	25mm
CTB5202/6	6	30mm
CTB5202/7	7	35mm
CTB5202/8	8	40mm
CTB5202/9	9	45mm
CTB5202/10	10	50mm
CTB5202/11	11	55mm
CTB5202/12	12	60mm

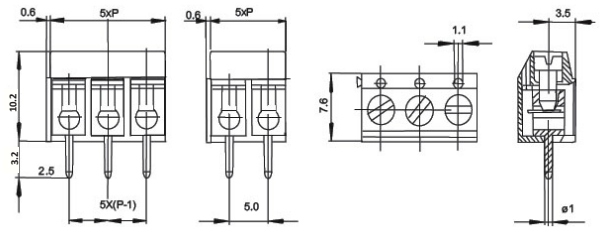

## 5mm Pitch Low Profile 90° Terminal Block

- 2-12 pole interlocking
- Moulded in black  
UL94V-0 PA
- Guided pin alignment
- Wire protector terminals
- 0.3-2 mm<sup>2</sup> (22-14 AWG)
-  us approved

CTB5252



### SPECIFICATION

Rating	16A/250V
Insulation resistance	5000MΩ/1000V
Withstand Voltage	AC1500V/1min
Contact Resistance	20mΩ (max)
Working Temperature	-33°C to 120+°C
Mouldings	UL94-V0 Flame retardant PA66
Pin/Terminal	Nickel plated brass
Wire Protector	Stainless steel
Screw/Torque	M2.5 Steel, Nickel Plated 0.4Nm
Recommended PCB hole size	ø1.3mm

TYPE NO.	POLES	LENGTH
CTB5252/2	2	10mm
CTB5252/3	3	15mm
CTB5252/4	4	20mm
CTB5252/5	5	25mm
CTB5252/6	6	30mm
CTB5252/7	7	35mm
CTB5252/8	8	40mm
CTB5252/9	9	45mm
CTB5252/10	10	50mm
CTB5252/11	11	55mm
CTB5252/12	12	60mm

