

<p align="center">Connectors for KNX bus coupler units</p> <p>0.6 ... 0.8 mm Ø 22 ... 20 AWG "sol."</p> <p>320 V/ 4 kV/2 6 A</p>	<p align="center">Description</p>	
---	--	--

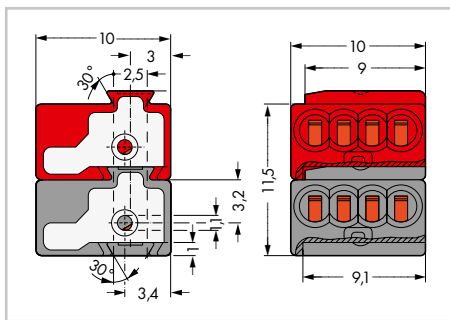

The KNX bus system is the intelligent solution to simplify existing building installation control. Instead of many different conventional wiring styles, the KNX bus system offers a flexible general solution for all applications in the field of switching, controlling, measuring, monitoring and signaling.

The decentralized KNX system consists of active and intelligent modules. The system can be customized using the different KNX components.

For example, pairs of sensors/actuators control:

- lighting
- window blinds
- heating/ventilation
- energy management systems
- information display/transmission

Command data is transmitted via a twisted-pair bus cable, which is connected to the sensors and actuators via WAGO push-wire connectors.

Sensors transmit commands as "telegrams" via the bus to the actuators, which record the information and act on the commands. To ensure that only fixed transmitters can trigger reactions in the fixed receivers, the "telegram" is provided with an address. The allocation (= addressing) is stipulated during programming.

The bus system is divided into "lines" (segments). The bus lines can be wired at will acc. to the line, star or tree topology. WAGO connectors connect the different branches to one another in the junction boxes.

If the installation will be extended later on, new components can be added to the existing bus without any problems. If rooms, floors or buildings are to be used differently one day, the installations can remain unchanged. It is only necessary to reprogram the allocation of actuators to sensors.

Color	Item No.	Pack. Unit
Connectors for KNX bus coupler units, mounted, with test slot		
	243-211	250
	243-212	250