

# Flush-type connector - SACCBP-MS-4CON-M16/1,0-PUR SCO - 1419399

Please be informed that the data shown in this PDF Document is generated from our Online Catalog. Please find the complete data in the user's documentation. Our General Terms of Use for Downloads are valid (<http://phoenixcontact.com/download>)



Flush-type plug, shielded, 4-pos., M12, A-coded, rear/screw mounting with M16 thread, with 1 m cable, 4 x 0.34 mm<sup>2</sup>

### Why buy this product

- Pre-assembled with cables in various standard lengths for immediate use
- Customer-specific assemblies and cable lengths can be supplied
- Sealed on the cable side for optimum tightness of seal
- For high transmission safety: shield connection to the housing with optional EMC nut



### Key Commercial Data

|                                      |   |
|--------------------------------------|---|
| Packing unit                         | 1 STK   |
| GTIN                                 | <br>4 046356 533249 |
| Weight per Piece (excluding packing) | 71.4 g  |
| Custom tariff number                 | 85444290  |
| Country of origin                    | Germany   |

### Technical data

#### Dimensions

|                 |     |
|-----------------|-----|
| Length of cable | 1 m |
|-----------------|-----|

#### Ambient conditions

|                                 |   |
|---------------------------------|---|
| Ambient temperature (operation) | -25 °C ... 85 °C (Plug / socket)                |
|                                 | -40 °C ... 85 °C (without mechanical actuation) |
| Degree of protection            | IP67  |

#### General

|      |  |
|------|--|
| Note | The electrical and mechanical data specified assume that the connector pair is correctly locked and mounted. If the connector is unlocked and if |
|------|--|

# Flush-type connector - SACCBP-MS-4CON-M16/1,0-PUR SCO - 1419399

## Technical data

### General

|                             |   |
|-----------------------------|---|
|                             | there is a danger of contamination, the connector must be sealed using a protective cap > IP54. Influences arising from litz wires, cables or PCB assembly must also be taken into consideration. |
| Rated current at 40°C       | 4 A   |
| Rated voltage               | 250 V   |
| Rated surge voltage         | 2.5 kV  |
| Number of positions         | 4   |
| Insulation resistance       | ≥ 100 MΩ  |
| Coding                      | A - standard  |
| Standards/regulations       | M12 connector IEC 61076-2-101   |
| Status display              | No  |
| Overvoltage category        | II  |
| Degree of pollution         | 3   |
| Connection method           | Individual wires  |
| Insertion/withdrawal cycles | > 100   |
| Torque                      | 3 Nm ... 4 Nm (Installation-side)   |
| Mounting type               | Rear mounting M16 x 1.5 With flat nut   |

### Material

|  |                              |
|--|------------------------------|
| Flammability rating according to UL 94 | V0                           |
| Contact material                       | CuZn                         |
| Contact surface material               | Au                           |
| Contact carrier material               | PA 66                        |
| Material, knurls                       | Zinc die-cast, nickel-plated |
| Sealing material                       | NBR                          |

### Cable

|                                    |                              |
|------------------------------------|------------------------------|
| Cable type                         | PUR halogen-free black       |
| Cable abbreviation                 | Li9Y-V1-C-V1-11Y             |
| Conductor cross section            | 0.34 mm <sup>2</sup>         |
| AWG signal line                    | 22                           |
| Conductor structure signal line    | 7x 0.25 mm                   |
| Core diameter including insulation | 1.2 mm ±0.07 mm              |
| Thickness, insulation              | 0.21 mm                      |
| Wire colors                        | brown, white, blue, black    |
| Overall twist                      | 4 wires, twisted             |
| Shielding                          | Tinned copper braided shield |
| Optical shield covering            | 85 %                         |
| External sheath, color             | black-gray RAL 7021          |
| External cable diameter            | 5.90 mm                      |
| Cable weight                       | 47 kg/km                     |

# Flush-type connector - SACCBP-MS-4CON-M16/1,0-PUR SCO - 1419399

## Technical data

### Cable

|                                 |   |
|---------------------------------|---|
| Outer sheath, material          | PUR   |
| Conductor material              | Bare Cu litz wires                              |
| Standards/specifications        | M12 connector IEC 61076-2-101                   |
| Insulation resistance           | $\geq 20 \text{ M}\Omega\cdot\text{km}$         |
| Conductor resistance            | $\leq 57.6 \text{ m}\Omega/\text{m}$            |
| Nominal voltage, cable          | 300 V   |
| Test voltage, cable             | 2000 V AC                                       |
| Ambient temperature (operation) | -40 °C ... 85 °C (cable, fixed installation)    |
|                                 | -25 °C ... 85 °C (cable, flexible installation) |

### Standards and Regulations

|  |                 |
|--|-----------------|
| Standard designation                   | M12 connector   |
| Standards/regulations                  | IEC 61076-2-101 |
| Flammability rating according to UL 94 | V0              |

## Drawings

Dimensional drawing

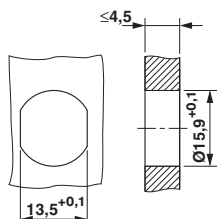

Schematic diagram

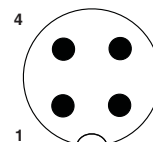

Pin assignment of M12 male connector, 4-pos., A-coded, view of connector side

Housing cutout for M16 fastening thread, mounting panel with feed-through hole (alternatively with surface as protection against rotation)

Cable cross section

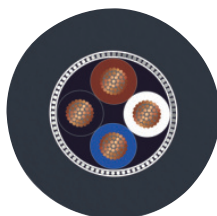

PUR halogen-free black [PUR]

Dimensional drawing

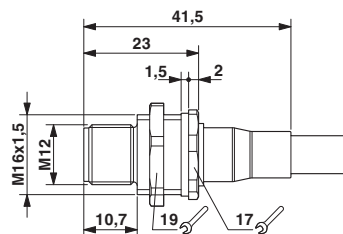

M12 flush-type connector

# Flush-type connector - SACCBP-MS-4CON-M16/1,0-PUR SCO - 1419399

Circuit diagram

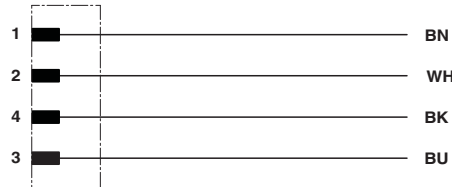

Contact assignment of the M12 plugs

## Classifications

### eCl@ss

|            |          |
|------------|----------|
| eCl@ss 4.0 | 27140815 |
| eCl@ss 4.1 | 27140815 |
| eCl@ss 5.0 | 27143423 |
| eCl@ss 5.1 | 27143423 |
| eCl@ss 6.0 | 27279220 |
| eCl@ss 7.0 | 27440103 |
| eCl@ss 8.0 | 27440103 |
| eCl@ss 9.0 | 27440102 |

### ETIM

|          |          |
|----------|----------|
| ETIM 2.0 | EC001297 |
| ETIM 3.0 | EC002061 |
| ETIM 4.0 | EC002061 |
| ETIM 5.0 | EC002061 |

### UNSPSC

|               |          |
|---------------|----------|
| UNSPSC 6.01   | 31251501 |
| UNSPSC 7.0901 | 31251501 |
| UNSPSC 11     | 31251501 |
| UNSPSC 12.01  | 31251501 |
| UNSPSC 13.2   | 39121413 |

## Approvals

Approvals

---

Approvals

EAC / EAC

---

# Flush-type connector - SACCBP-MS-4CON-M16/1,0-PUR SCO - 1419399

## Approvals

Ex Approvals

---

Approvals submitted

---

## Approval details

EAC

EAC

## Accessories

Accessories

Plug for cable screw gland

Screw plug - SACC-M16-SEALING PLUG SET - 1453368



M16 screw plug for unused M12 housing cutouts

---

## Protective cap

Sealing cap - PROT-M12 FS - 1560251



M12 sealing cap for unoccupied M12 plugs of the sensor/actuator cable, flush-type plugs and I/O devices in the field

---

Sealing cap - PROT-M12 FS-M - 1430488



M12 metal sealing cap for unoccupied M12 plugs of the sensor/actuator cable, flush-type plugs and I/O devices in the field

---

## Seal

## Flush-type connector - SACCBP-MS-4CON-M16/1,0-PUR SCO - 1419399

### Accessories

Flat gasket - SACC-M16-SEAL CLM - 1430394



M16 flat gasket, for rear mounting of M12 flush-type connectors with M16 fastening thread

---

Phoenix Contact 2016 © - all rights reserved  
<http://www.phoenixcontact.com>