

Flush-type connector - SACC-DSI-MINMS-5CON-UNF/1,0 - 1453799

Please be informed that the data shown in this PDF Document is generated from our Online Catalog. Please find the complete data in the user's documentation. Our General Terms of Use for Downloads are valid (<http://phoenixcontact.com/download>)



Sensor/actuator flush-type plug, 5-pos., 7/8", rear mounting with 7/8" fastening thread, with 1.0 m PE litz wire, 5 x 0.75 mm²



Key Commercial Data

Packing unit	1 STK
GTIN	 4 046356 557818
Weight per Piece (excluding packing)	123.7 g
Custom tariff number	85366990
Country of origin	Germany
Note	Made to Order (non-returnable)

Technical data

Dimensions

Length of cable	1 m
-----------------	-----

Ambient conditions

Ambient temperature (operation)	-40 °C ... 85 °C (Plug)
Degree of protection	IP67

General

Rated current at 40°C	9 A
Rated voltage	250 V
Number of positions	5
Insulation resistance	≥ 100 MΩ
Status display	No
Overvoltage category	II
Degree of pollution	3
Connection method	Individual wires

Flush-type connector - SACC-DSI-MINMS-5CON-UNF/1,0 - 1453799

Technical data

General

Mounting type	Rear mounting 7/8"
---------------	--------------------

Material

Flammability rating according to UL 94	HB
Contact material	CuZn
Contact surface material	Au
Contact carrier material	PUR
Material, knurls	Zinc die-cast, nickel-plated

Cable

Cable type	PVC litz wire
Conductor cross section	0.75 mm ²
AWG signal line	18
Conductor structure signal line	24x 0.20 mm
Core diameter including insulation	2.7 mm
Thickness, insulation	0.85 mm (Core insulation)
Wire colors	brown, white, blue, black, green-yellow
Material conductor insulation	PVC
Ambient temperature (operation)	-40 °C ... 85 °C (cable, fixed installation)

Standards and Regulations

Connection in acc. with standard	CUL
Flammability rating according to UL 94	HB

Drawings

Dimensional drawing

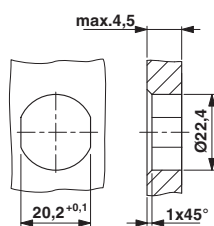

Schematic diagram

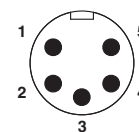

Connector pin assignment

Housing cutout

Flush-type connector - SACC-DSI-MINMS-5CON-UNF/1,0 - 1453799

Circuit diagram



Dimensional drawing

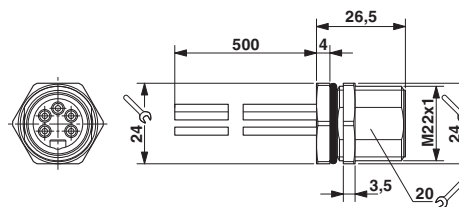

7/8" flush-type plug

Classifications

eCl@ss

eCl@ss 4.0	27140815
eCl@ss 4.1	27140815
eCl@ss 5.0	27143423
eCl@ss 5.1	27143423
eCl@ss 6.0	27143423
eCl@ss 7.0	27449001
eCl@ss 8.0	27440103
eCl@ss 9.0	27440102

ETIM

ETIM 4.0	EC002061
ETIM 5.0	EC002061

UNSPSC

UNSPSC 6.01	31251501
UNSPSC 7.0901	31251501
UNSPSC 11	31251501
UNSPSC 12.01	31251501
UNSPSC 13.2	31251501

Approvals

Approvals

Approvals

UL Recognized / cUL Recognized / EAC / EAC / EAC

Ex Approvals

Approvals submitted

Flush-type connector - SACC-DSI-MINMS-5CON-UNF/1,0 - 1453799

Approvals

Approval details

UL Recognized 

cUL Recognized 

EAC

EAC

EAC
