

VOLEX RESERVES THE RIGHT TO ALTER NON-CRITICAL DIMENSIONS WITHOUT NOTICE.

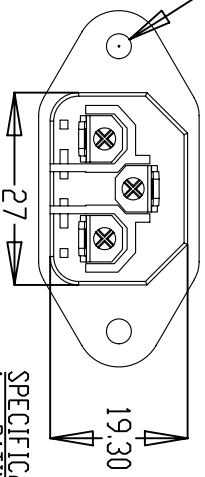

**SPECIFICATIONS**  
 1. RATING: 10A @ 250V MAX. AC (EUROPE)  
 15A @ 250V MAX. AC (NORTH AMERICA)  
 2. MATERIALS: INSULATOR = THERMOPLASTIC  
 CONTACTS = TIN PLATED BRASS

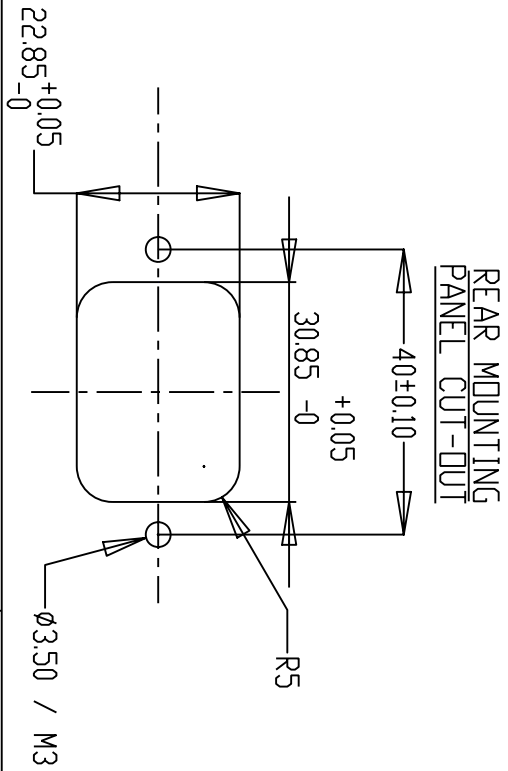
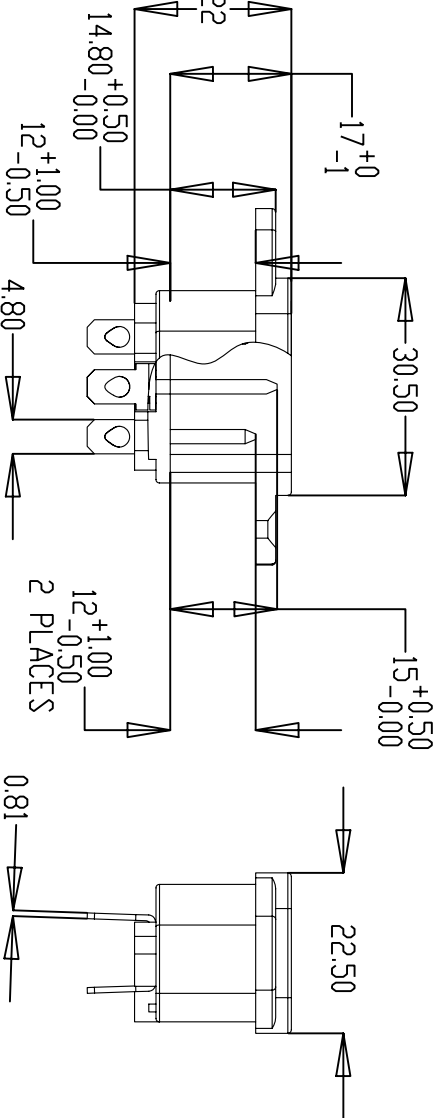
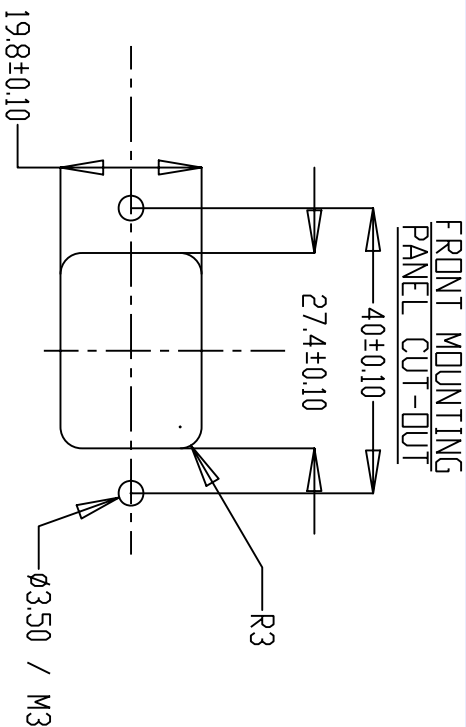
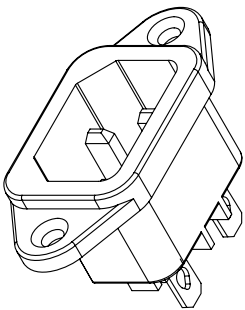
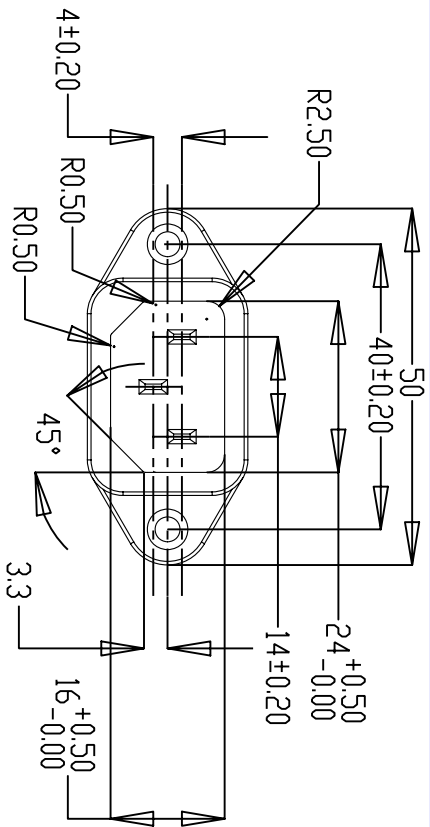
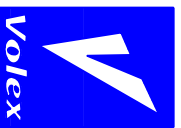

FORM IN71-07 REV.A

- Indianapolis, IN
- Conover, N.C.
- Tijuana, Mexico
- Hermosillo, MX
- Kanata, Canada

**Proprietary Notice:**

This document is the property of Volex Incorporated. The information contained herein is not to be disclosed to anyone without the express written consent of Volex Inc.

REV	1	C.U.D - NEW RELEASE		DATE	8/22/07
SCALE:	1:1	ECD:	N/A	ITEM DESCRIPTION	PANEL MOUNT C-14
APPROVED	STC	DRAWN BY	STC	DATE:	8/22/07
PART NO.	17252A 0 B1				