

Ceramic, Commercial Grade, GoldMax, 2200 pF, 10%, 100 V, X7R, Lead Spacing = 5.08mm

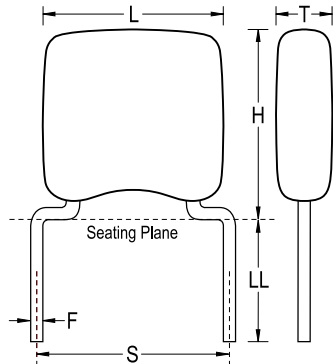

Dimensions

L	3.81mm MAX
H	5.08mm MAX
T	2.54mm MAX
S	5.08mm NOM
LL	7mm MIN
F	0.51mm NOM

Packaging Specifications

Packaging:	Bulk, Bag
Packaging Quantity:	500

General Information

Style:	Radial
Series:	GoldMax
Description:	GoldMax, Commercial Standard
RoHS:	Yes
Termination:	Tin
Failure Rate:	N/A

Specifications

Capacitance:	2200 pF
Capacitance Tolerance:	10%
Voltage DC:	100 VDC
Temperature Range:	-55/+125C
Temperature Coefficient:	X7R
Dissipation Factor:	2.5%
Aging Rate:	3% Loss/Decade Hour
Insulation Resistance:	100 GOhms
Dielectric Strength:	250 V