



## LM006 WiFi 802.11 b/g/n Adapter

Host Controller Interface (HCI) via USB Interface

Product

LM006

Part No

See Last Page

Revised

25/JAN/2017



### Features

- WiFi 802.11 b/g/n
- Operates in 2.4 GHz Frequency bands
- Plug and Play (Linux, MAC OSX and Windows XP – 10 compatible)
- Up to 150Mbps Data Transfer Rate
- 1x1 SISO technology improves effective throughput and range over existing 802.11 b/g products
- 802.11e-compatible bursting and I standards
- BPSK, QPSK, 16 QAM and 64 QAM modulation schemes
- WEP, TKIP, and AES, WPA and WPA2 encryption schemes
- Fully-featured software utility for easy configuration and management
- Can be setup as a ad-hoc network via peer to peer communications
- Small convenient size
- FCC, CE/ R&TTE and TELEC certified solution
- RoHS, REACH and WEEE compliant

### Overview

The LM006 802.11n 150Mbps WiFi USB adapter is a convenient Plug & Play USB 2.0 solution that brings wireless networking to your laptop or desktop PC. With transfer rates of up to 150 Mbps you can connect to a wireless network at home, at the office or in any wireless hotspot.

Now you can stay connected wherever you are and wherever you go. Its small form factor (23mm long) means you can leave it connected to your laptop even when stored away.

The adapter supports the features and functional compliance of IEEE 802.11n, e and i standards. The adapter is designed to provide good performance with minimum power consumption and enhance the advantages of a robust system while being cost effective.

The LM006 is compatible with other 802.11b / 802.11g or 802.11n WiFi compliant devices such as wireless router, access point or adapter.



## LM006 WiFi 802.11 b/g/n Adapter

### Host Controller Interface (HCI) via USB Interface

Product  
Part No

LM006  
See Last Page

## General Specification

### Wireless

Wireless Standard	802.11 b/g/n, 802.3, and 802.3u
Module Type	Host Controller Interface (HCI)
OS Compatibility	Linux, MAC OSX and Windows XP – 10
Security	WEP, TKIP, AES, WPA and WPA2
Network Architecture	Ad hoc mode (Peer-to-Peer) and Infrastructure mode

### Hardware

Chipset	Realtek
Antenna	Onboard Chip Antenna
Interfaces	USB 2.0 (Full Speed)

### RF Characteristics

Tx Output Power	(+/- 2dBm): 14dBm@11n, 17dBm@11b, 14dBm@11g
Rx Sensitivity	11Mbps -80dBm@8%,54Mbps -70dBm@10%,130Mbps -64dBm@10%
Range (in open space)	Up to 180m
Current Consumption	Transmit: average 305 mA Receive: average 190 mA
Data Transfer Rate	1,2,5.5,6,11,12,18,22,24,30,36,48,54,60,90,120 Mbps to a maximum of 150Mbps
Frequency	2.4GHz ISM Band
Modulation Scheme	BPSK/ QPSK/ 16-QAM/ 64-QAM
Spread Spectrum	IEEE 802.11b: DSSS (Direct Sequence Spread Spectrum) IEEE 802.11g/n: OFDM (Orthogonal Frequency Division Multiplexing)

### Physical Characteristics

Operating Temperature	0°C to +50°C ambient temperature
Storage Temperature	-10°C to +70°C ambient temperature
Humidity	5% to 90% maximum (non-condensing)
Dimensions (L x W x H)	23.44mm x 14.40mm x 5.80mm
Weight	2.2 g
Certifications	FCC, CE/ R&TTE and TELEC certified solution
Compliance	RoHS, REACH and WEEE



## LM006 WiFi 802.11 b/g/n Adapter

Host Controller Interface (HCI) via USB Interface

Product  
Part No

LM006  
See Last Page

### Physical Dimensions

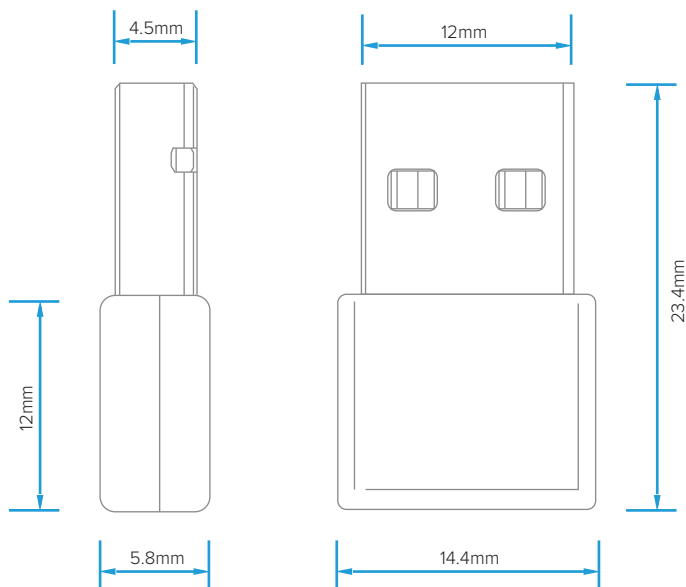
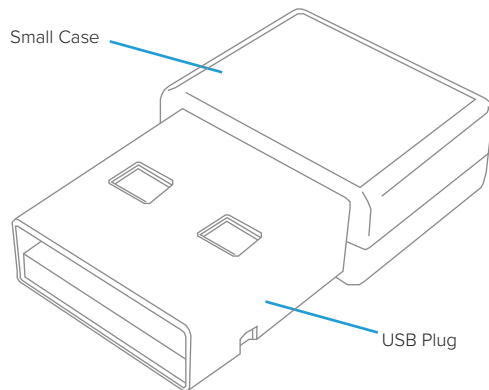



## LM006 WiFi 802.11 b/g/n Adapter

Host Controller Interface (HCI) via USB Interface

Product  
Part No

LM006  
See Below

### LM006 Packaging Options



006-1004

#### SRP - Single Retail Pack

1 x LM006 WiFi USB Adapter

- See our website to download any applicable Product Software, Manuals and Notes - <http://www.lm-technologies.com/downloads>