

PLEASE CHECK WWW.MOLEX.COM FOR LATEST PART INFORMATION

Part Number: [0768290006](#)
Status: **Active**
Overview: Mega-Fit® Power Connectors
Description: Mega-Fit™ Vertical Header, Through Hole, 5.70mm Pitch, Dual Row, 6 Circuits, Tin, Glow Wire Capable, Black

Documents:

| | |
|--|--|
| 3D Model | Application Specification AS-76823-100 (PDF) |
| Drawing (PDF) | Packaging Specification PK-31301-976 (PDF) |
| Product Specification PS-76823-100 (PDF) | RoHS Certificate of Compliance (PDF) |

Agency Certification

| | |
|-----|---------|
| CSA | LR19980 |
| UL | E29179 |

General

| | |
|----------------|--|
| Product Family | PCB Headers |
| Series | 76829 |
| Application | Power, Wire-to-Board |
| Overview | Mega-Fit® Power Connectors |
| Product Name | Mega-Fit® |
| UPC | 887191454207 |

Physical

| | |
|--------------------------------|--------------------------------|
| Breakaway | No |
| Circuits (Loaded) | 6 |
| Circuits (maximum) | 6 |
| Color - Resin | Black |
| First Mate / Last Break | No |
| Flammability | 94V-0 |
| Glow-Wire Compliant | Yes |
| Keying to Mating Part | Yes |
| Lock to Mating Part | Yes |
| Mated Height | 16.78mm |
| Material - Metal | Copper |
| Material - Plating Mating | Tin |
| Material - Plating Termination | Tin |
| Material - Resin | High Temperature Thermoplastic |
| Net Weight | 3.553/g |
| Number of Rows | 2 |
| Orientation | Vertical |
| PCB Locator | Yes |
| PCB Retention | Yes |
| PCB Thickness - Recommended | 1.57mm, 2.36mm |
| Packaging Type | Tray |
| Pitch - Mating Interface | 5.70mm |
| Pitch - Termination Interface | 5.70mm |
| Plating min - Mating | 1.524µm |
| Plating min - Termination | 1.270µm |
| Polarized to Mating Part | Yes |
| Polarized to PCB | Yes |
| Shrouded | Yes |
| Surface Mount Compatible (SMC) | Yes |
| Temperature Range - Operating | -40°C to +105°C |
| Termination Interface: Style | Through Hole |
| Unmated Height | 14.03mm |

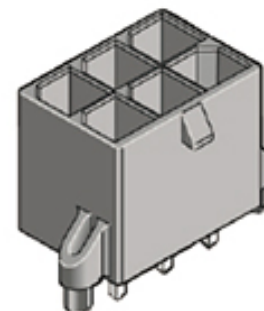

Series image - Reference only

EU ELV

Not Relevant

EU RoHS

Compliant
REACH SVHC

Not Contained Per -
ED/21/2016 (20 June
2016)

Halogen-Free
Status

Low-Halogen

**Need more information on product
environmental compliance?**

Email productcompliance@molex.com
Please visit the [Contact Us](#) section for any
non-product compliance questions.

China ROHS
ELV

Green Image
Not Relevant

Search Parts in this Series

[76829](#) Series

Mates With

Mega-Fit® Male Crimp Housing [171692](#) ,
[170001](#)

Electrical

| | |
|-------------------------------|-------|
| Current - Maximum per Contact | 23.0A |
| Voltage - Maximum | 600V |

Solder Process Data

| | |
|--|----------|
| Duration at Max. Process Temperature (seconds) | 030 |
| Lead-free Process Capability | SMC&WAVE |
| Max. Cycles at Max. Process Temperature | 001 |
| Process Temperature max. C | 260 |

Material Info**Reference - Drawing Numbers**

| | |
|---------------------------|---------------|
| Application Specification | AS-76823-100 |
| Packaging Specification | PK-31301-976 |
| Product Specification | PS-76823-100 |
| Sales Drawing | SD-76829-0100 |

This document was generated on 07/29/2016

PLEASE CHECK WWW.MOLEX.COM FOR LATEST PART INFORMATION