

3.1 EPIC® D A - V I N C I H - A

Tüllengehäuse / Hood / Capot

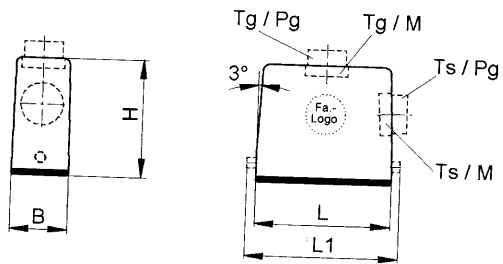
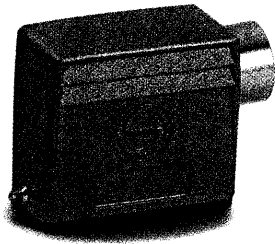

EPIC® H-A Gehäuse: Tüllengehäuse (Kabeleingang seitlich, Bolzen für Längsbügel)

EPIC® H-A housings: hood (side entry, bolts for single locking lever)

Boîtiers EPIC® H-A: capot (sortie latérale, ergots pour simple levier)

H-A 10

Artikel part article	Art.Nr. part No. N° art.	Art.Nr.: EP part No.: EP N° art.: EP	PG	M	L	L1	L2	L3	L4	B	B1	B2	B3	B4	B5	H	H1	H2	S	d
H-A 10 TS 16	10445000*	70463000	16																	
H-A 10 TS 21	10445500*		21		63	73				29,5										53,3
H-A 10 TS M20	19445000	79463000		20																
H-A 10 TS M25	19445500			25	63	73				29,5										53,3

Einsätze / Inserts / Inserts: 1.1: H-A 10 / 1.2: STA 14 / 1.6: H-D 15

Deckel / Cover / Couvercle: 5.1: H-A 10

Kabelverschraubung / Cable gland / Presse-étoupe: 4.1 PG / 4.2 Metr.

H-A 16

Artikel part article	Art.Nr. part No. N° art.	Art.Nr.: EP part No.: EP N° art.: EP	PG	M	L	L1	L2	L3	L4	B	B1	B2	B3	B4	B5	H	H1	H2	S	d
H-A 16 TS 16	10564000*	70493000	16																	
H-A 16 TS 21	10564500*	-	21		79	89				29,5										58,3
H-A 16 TS M20	19564000	79493000		20																
H-A 16 TS M25	19564500	-		25	79	89				29,5										58,3

Einsätze / Inserts / Inserts: 1.1: H-A 16 / 1.2: STA 20 / 1.6: H-D 25

Deckel / Cover / Couvercle: 5.1: H-A 16

Kabelverschraubung / Cable gland / Presse-étoupe: 4.1 PG / 4.2 Metr.

4114980

4115004

4.2 EPIC® CERTOSA M

411 4980

411 5004

Kabelverschraubungen metrisch / Cable glands metric thread / Presse-étoupes pas métrique

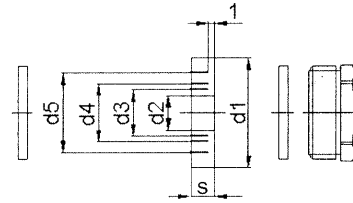
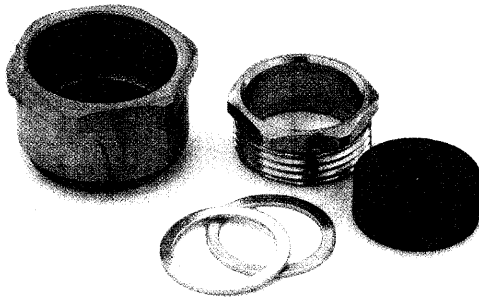

EPIC® CM-M

Artikel part article	Art.Nr. part No. N° art.	M	d1	d2	Kabel Ø cable Ø câble Ø	d3	Kabel Ø cable Ø câble Ø	d4	Kabel Ø cable Ø câble Ø	d5	Kabel Ø cable Ø câble Ø	S	SW mm opening of the spanner ouverture de clef	VPE packing unit condition- nement
CM-M12	71201000	12	10	5	4-6							5	15	5
CM-M16	71201100	16	13,8	3	2-4	6	5-7	9	8-10			5,5	19	5
CM-M20	71201200	20	17,6	4	3-5	7	6-8	10	9-11	13	12-14	6	23	5
CM-M25	71201300	25	22,6	8,5	7,5-9,5	11,5	10-12,5	14,5	13,5-15,5	17,5	16,5-18,5	7,5	28	5
CM-M32	71201400	32	29,6	16	15-17	19	18-20	22	21-23	25	24-26	9,5	36	5
CM-M40	71201500	40	37,6	23	22-24	26	25-27	29	28-30	32	31-33	12	46	5
CM-M50	71201600	50	47,6	30	29-31	33	32-34	36	35-37	39	38-40	14	55	5

Material / material / matière: Metall, Messing vernickelt / metal, brass, nickel plated / métallique, laiton nickelage

Schutzart / protection class / degré de protection: IP 54 (DIN 46320)

Temperaturbereich / temperature range / gamme de température: -40° C – +125° C

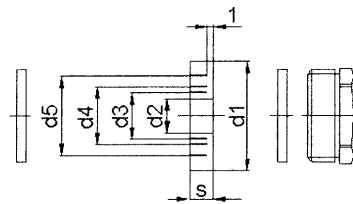
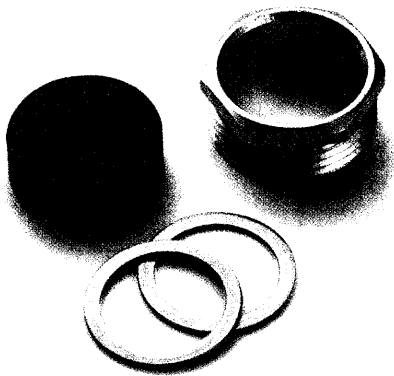

EPIC® SM-M

Artikel part article	Art.Nr. part No. N° art.	M	d1	d2	Kabel Ø cable Ø câble Ø	d3	Kabel Ø cable Ø câble Ø	d4	Kabel Ø cable Ø câble Ø	d5	Kabel Ø cable Ø câble Ø	S	SW mm opening of the spanner ouverture de clef	VPE packing unit condition- nement
SM-M12	71200000	12	10	5	4-6							5	12	5
SM-M16	71200100	16	13,8	3	2-4	6	5-7	9	8-10			5,5	16	5
SM-M20	71200200	20	17,6	4	3-5	7	6-8	10	9-11	13	12-14	6	20	5
SM-M25	71200300	25	22,6	8,5	7,5-9,5	11,5	10,5-12,5	14,5	13,5-15,5	17,5	16,5-18,5	7,5	25	5
SM-M32	71200400	32	29,6	16	15-17	19	18-20	22	21-23	25	24-26	9,5	32	5
SM-M40	71200500	40	37,6	23	22-24	26	25-27	29	23-28	32	31-33	12	40	5
SM-M50	71200600	50	47,6	30	29-31	33	32-34	36	35-37	39	38-40	14	50	5

Material / material / matière: Metall, Messing vernickelt / metal, brass, nickel plated / métallique, laiton nickelage

Schutzart / protection class / degré de protection: IP 54 (DIN 46320)

Temperaturbereich / temperature range / gamme de température: -40° C – +125° C