

# CONNECTORS TWIST-LOCK TYPE

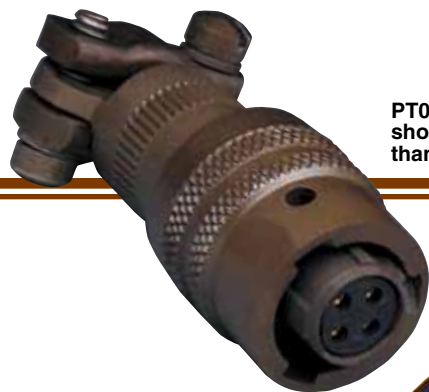

PT06F8-4S,  
shown smaller  
than actual size.



PT06F10-6S,  
shown actual size.

**Integral  
Solder  
Contacts  
Included**

## PT Series

- ✓ Rugged Aluminum Shells
- ✓ Rated to 125°C (257°F)
- ✓ Strain-Relief Cable Clamp
- ✓ Secure Solder Contacts
- ✓ #20 AWG Wire Size
- ✓ High-Conductivity Gold-Plated Contacts

**MALE**  
PT01F

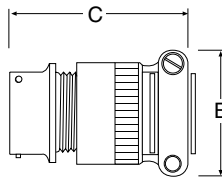
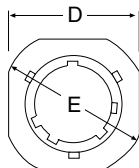

**FEMALE**  
PT06F

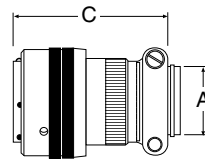
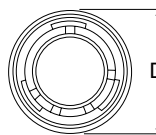

The OMEGA® PT Series connectors provide an efficient method of connecting pressure transducers to associated instrumentation with multiconductor cable. The solder contacts are designed to provide positive connections for signal or power circuitry. The connectors come in a selection of operating temperature ranges to meet most industrial applications.

### SPECIFICATIONS

**Insulation Resistance @ 25°C (77°F):**  
5000 MΩ min

**Voltage Drop:** #20 contact, #20 wire,  
at 7.5 A, 55 mV max

#### ENVIRONMENTALLY PROTECTED MODELS

**Air Pressure:** 30 psi (2 bar)  
at -55°C (-67°F)

**Durability:** 500 cycles of coupling  
and uncoupling

**Shells:** Aluminum alloy, 0.0003  
cadmium plate with olive drab chromate

**Insulators:** Neoprene on all, except  
silicone on PCS06E10-6S

**Contacts:** High-conductivity copper  
alloy, 0.000050 gold over copper

#### Dimensions: mm (inch)

MODEL NO.	A DIA. MIN	B MAX	C MAX	D MAX	E ±0.020
PT01F8-4P	5.94 (0.234)	21.03 (0.828)	48.82 (1.922)	21.03 (0.828)	23.83 (0.938)
PT01F10-6P	7.54 (0.297)	22.63 (0.891)	48.82 (1.922)	24.23 (0.954)	26.97 (1.062)
PT06F8-4S	5.94 (0.234)	21.03 (0.828)	46.43 (1.828)	19.05 (0.750)	—
PT06F10-6S	7.54 (0.297)	22.63 (0.891)	46.43 (1.828)	21.82 (0.859)	—

### To Order

MODEL NO.	NO. OF CONTACTS	TEMPERATURE RANGE	FEATURES
PT01F8-4P	4 male	-55 to 125°C (-67 to 257°F)	Environmentally protected
PT01F10-6P	6 male	-55 to 125°C (-67 to 257°F)	Environmentally protected
PT06A10-6S	6 female	-55 to 125°C (-67 to 257°F)	Indoor use
PT06F8-4S	4 female	-55 to 125°C (-67 to 257°F)	Indoor use
PT06F8-4SG	4 female	-55 to 125°C (-67 to 257°F)	Internal sealing gland
PT06F10-6S	6 female	-55 to 125°C (-67 to 257°F)	Indoor use
PTS06A10-6S	6 female	-55 to 150°C (-67 to 302°F)	Extended temperature range
PCS06E10-6S	6 female	-55 to 204°C (-67 to 399°F)	High temperature

**Note:** "P" suffix denotes male pins; "S" suffix denotes female sockets.

**Ordering Example:** PT01F8-4P, 4 contacts, male, and PT06F8-4S, 4 contacts, female.