



Is Now Part of



**ON Semiconductor®**

To learn more about ON Semiconductor, please visit our website at  
[www.onsemi.com](http://www.onsemi.com)

ON Semiconductor and the ON Semiconductor logo are trademarks of Semiconductor Components Industries, LLC dba ON Semiconductor or its subsidiaries in the United States and/or other countries. ON Semiconductor owns the rights to a number of patents, trademarks, copyrights, trade secrets, and other intellectual property. A listing of ON Semiconductor's product/patent coverage may be accessed at [www.onsemi.com/site/pdf/Patent-Marking.pdf](http://www.onsemi.com/site/pdf/Patent-Marking.pdf). ON Semiconductor reserves the right to make changes without further notice to any products herein. ON Semiconductor makes no warranty, representation or guarantee regarding the suitability of its products for any particular purpose, nor does ON Semiconductor assume any liability arising out of the application or use of any product or circuit, and specifically disclaims any and all liability, including without limitation special, consequential or incidental damages. Buyer is responsible for its products and applications using ON Semiconductor products, including compliance with all laws, regulations and safety requirements or standards, regardless of any support or applications information provided by ON Semiconductor. "Typical" parameters which may be provided in ON Semiconductor data sheets and/or specifications can and do vary in different applications and actual performance may vary over time. All operating parameters, including "Typicals" must be validated for each customer application by customer's technical experts. ON Semiconductor does not convey any license under its patent rights nor the rights of others. ON Semiconductor products are not designed, intended, or authorized for use as a critical component in life support systems or any FDA Class 3 medical devices or medical devices with a same or similar classification in a foreign jurisdiction or any devices intended for implantation in the human body. Should Buyer purchase or use ON Semiconductor products for any such unintended or unauthorized application, Buyer shall indemnify and hold ON Semiconductor and its officers, employees, subsidiaries, affiliates, and distributors harmless against all claims, costs, damages, and expenses, and reasonable attorney fees arising out of, directly or indirectly, any claim of personal injury or death associated with such unintended or unauthorized use, even if such claim alleges that ON Semiconductor was negligent regarding the design or manufacture of the part. ON Semiconductor is an Equal Opportunity/Affirmative Action Employer. This literature is subject to all applicable copyright laws and is not for resale in any manner.

## NDT3055 N-Channel Enhancement Mode Field Effect Transistor

### General Description

These N-Channel enhancement mode power field effect transistors are produced using Fairchild's proprietary, high cell density, DMOS technology. This very high density process is especially tailored to minimize on-state resistance and provide superior switching performance. These devices are particularly suited for low voltage applications such as DC motor control and DC/DC conversion where fast switching, low in-line power loss, and resistance to transients are needed.

### Features

- 4 A, 60 V.  $R_{DS(ON)} = 0.100 \Omega @ V_{GS} = 10 \text{ V}$ .
- High density cell design for extremely low  $R_{DS(ON)}$ .
- High power and current handling capability in a widely used surface mount package.

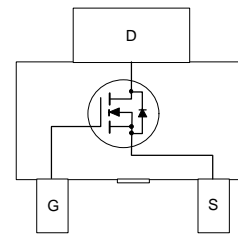
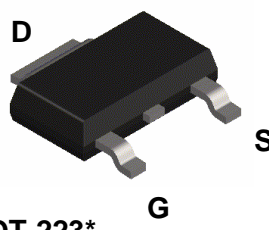
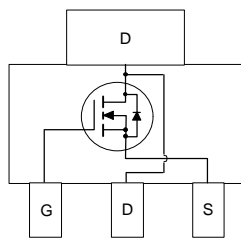
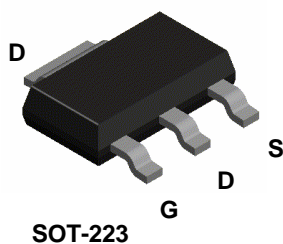

### Absolute Maximum Ratings $T_A = 25^\circ\text{C}$ unless otherwise noted

| Symbol         | Parameter                                    | NDT3055    | Units            |
|----------------|--|------------|------------------|
| $V_{DSS}$      | Drain-Source Voltage                         | 60         | V                |
| $V_{GSS}$      | Gate-Source Voltage - Continuous             | $\pm 20$   | V                |
| $I_D$          | Maximum Drain Current - Continuous (Note 1a) | 4          | A                |
|                | - Pulsed                                     | 25         |                  |
| $P_D$          | Maximum Power Dissipation (Note 1a)          | 3          | W                |
|                | (Note 1b)                                    | 1.3        |                  |
|                | (Note 1c)                                    | 1.1        |                  |
| $T_J, T_{STG}$ | Operating and Storage Temperature Range      | -65 to 150 | $^\circ\text{C}$ |

### THERMAL CHARACTERISTICS

|                 |   |    |                    |
|-----------------|---|----|--------------------|
| $R_{\theta JA}$ | Thermal Resistance, Junction-to-Ambient (Note 1a) | 42 | $^\circ\text{C/W}$ |
| $R_{\theta JC}$ | Thermal Resistance, Junction-to-Case (Note 1)     | 12 | $^\circ\text{C/W}$ |

\* Order option J23Z for cropped center drain lead.

**Electrical Characteristics** ( $T_A = 25\text{ }^\circ\text{C}$  unless otherwise noted)

| Symbol  | Parameter   | Conditions  | Min   | Typ   | Max  | Units                |
|---|---|---|---|-------|------|----------------------|
| <b>OFF CHARACTERISTICS</b>                                    |   |   |   |       |      |                      |
| $BV_{DSS}$  | Drain-Source Breakdown Voltage                        | $V_{GS} = 0\text{ V}, I_D = 250\text{ }\mu\text{A}$   | 60  |       |      | V                    |
| $\Delta BV_{DSS}/\Delta T_J$                                  | Breakdown Voltage Temp. Coefficient                   | $I_D = 250\text{ }\mu\text{A}$ , Referenced to $25\text{ }^\circ\text{C}$                         |   | 63    |      | mV/ $^\circ\text{C}$ |
| $I_{DSS}$   | Zero Gate Voltage Drain Current                       | $V_{DS} = 48\text{ V}, V_{GS} = 0\text{ V}$<br>$T_J = 125\text{ }^\circ\text{C}$                  |   |       | 10   | $\mu\text{A}$        |
|   |   |   |   |       | 100  | $\mu\text{A}$        |
| $I_{GSSF}$  | Gate - Body Leakage, Forward                          | $V_{GS} = 20\text{ V}, V_{DS} = 0\text{ V}$   |   |       | 100  | nA                   |
| $I_{GSSR}$  | Gate - Body Leakage, Reverse                          | $V_{GS} = -20\text{ V}, V_{DS} = 0\text{ V}$  |   |       | -100 | nA                   |
| <b>ON CHARACTERISTICS</b> (Note 2)                            |   |   |   |       |      |                      |
| $V_{GS(th)}$  | Gate Threshold Voltage                                | $V_{DS} = V_{GS}, I_D = 250\text{ }\mu\text{A}$<br>$T_J = 125\text{ }^\circ\text{C}$              | 2   | 3     | 4    | V                    |
|   |   |   | 1.5   | 2.4   | 3    |                      |
| $R_{DS(on)}$  | Static Drain-Source On-Resistance                     | $V_{GS} = 10\text{ V}, I_D = 4\text{ A}$<br>$T_J = 125\text{ }^\circ\text{C}$                     |   | 0.084 | 0.1  | $\Omega$             |
|   |   |   |   | 0.14  | 0.18 |                      |
| $I_{D(on)}$   | On-State Drain Current                                | $V_{GS} = 10\text{ V}, V_{DS} = 10\text{ V}$  | 15  |       |      | A                    |
| $g_{FS}$  | Forward Transconductance                              | $V_{DS} = 15\text{ V}, I_D = 4\text{ A}$  |   | 6     |      | S                    |
| <b>DYNAMIC CHARACTERISTICS</b>                                |   |   |   |       |      |                      |
| $C_{iss}$   | Input Capacitance                                     | $V_{DS} = 30\text{ V}, V_{GS} = 0\text{ V},$<br>$f = 1.0\text{ MHz}$                              |   | 250   |      | pF                   |
| $C_{oss}$   | Output Capacitance                                    |   |   | 100   |      | pF                   |
| $C_{rss}$   | Reverse Transfer Capacitance                          |   |   | 30    |      | pF                   |
| <b>SWITCHING CHARACTERISTICS</b> (Note 2)                     |   |   |   |       |      |                      |
| $t_{D(on)}$   | Turn - On Delay Time                                  | $V_{DD} = 25\text{ V}, I_D = 1.2\text{ A},$<br>$V_{GS} = 10\text{ V}, R_{GEN} = 50\text{ }\Omega$ |   | 10    | 25   | ns                   |
| $t_r$   | Turn - On Rise Time                                   |   |   | 18    | 50   |                      |
| $t_{D(off)}$  | Turn - Off Delay Time                                 |   |   | 37    | 65   |                      |
| $t_f$   | Turn - Off Fall Time                                  |   |   | 30    | 60   |                      |
| $Q_g$   | Total Gate Charge                                     |   | $V_{DS} = 40\text{ V}, I_D = 4\text{ A},$<br>$V_{GS} = 10\text{ V}$ |       | 9    |                      |
| $Q_{gs}$  | Gate-Source Charge                                    |   |   | 2.3   |      |                      |
| $Q_{gd}$  | Gate-Drain Charge                                     |   |   | 2.6   |      |                      |
| <b>DRAIN-SOURCE DIODE CHARACTERISTICS AND MAXIMUM RATINGS</b> |   |   |   |       |      |                      |
| $I_S$   | Maximum Continuous Drain-Source Diode Forward Current |   |   |       | 2.5  | A                    |
| $V_{SD}$  | Drain-Source Diode Forward Voltage                    | $V_{GS} = 0\text{ V}, I_S = 2.5\text{ A}$ (Note 2)  |   | 0.85  | 1.2  | V                    |

Notes:

- $R_{\theta JA}$  is the sum of the junction-to-case and case-to-ambient thermal resistance where the case thermal reference is defined as the solder mounting surface of the drain pins.  $R_{\theta JC}$  is guaranteed by design while  $R_{\theta CA}$  is determined by the user's board design.

Typical  $R_{\theta JA}$  using the board layouts shown below on FR-4 PCB in a still air environment:

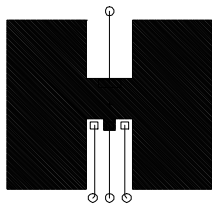

a.  $42\text{ }^\circ\text{C/W}$  when mounted on a  $1\text{ in}^2$  pad of 2oz Cu.



b.  $95\text{ }^\circ\text{C/W}$  when mounted on a  $0.066\text{ in}^2$  pad of 2oz Cu.



c.  $110\text{ }^\circ\text{C/W}$  when mounted on a  $0.00123\text{ in}^2$  pad of 2oz Cu.

Scale 1 : 1 on letter size paper

- Pulse Test: Pulse Width  $\leq 300\mu\text{s}$ , Duty Cycle  $\leq 2.0\%$

## Typical Electrical Characteristics

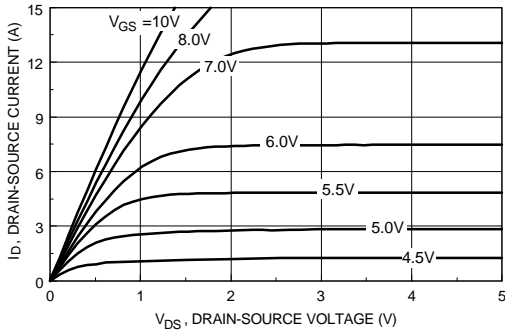

Figure 1. On-Region Characteristics.

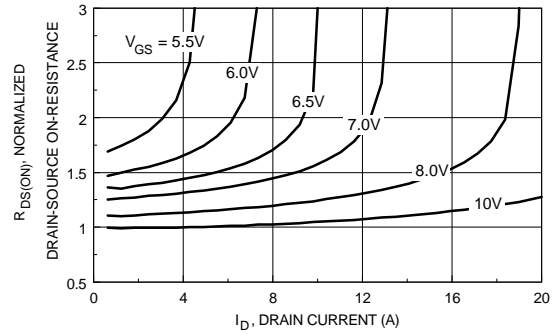

Figure 2. On-Resistance Variation with Drain Current and Gate Voltage.

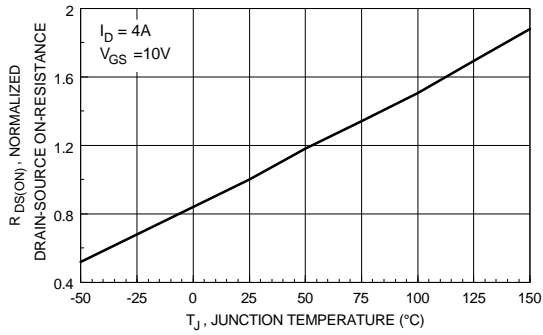

Figure 3. On-Resistance Variation with Temperature.

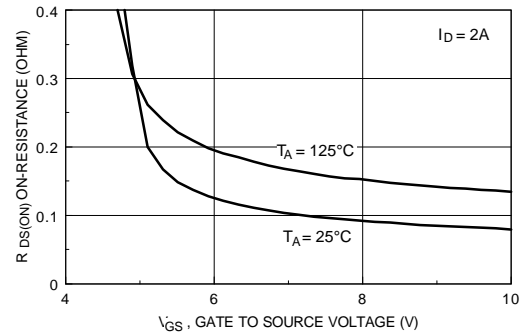

Figure 4. On-Resistance Variation with Gate-to-Source Voltage.

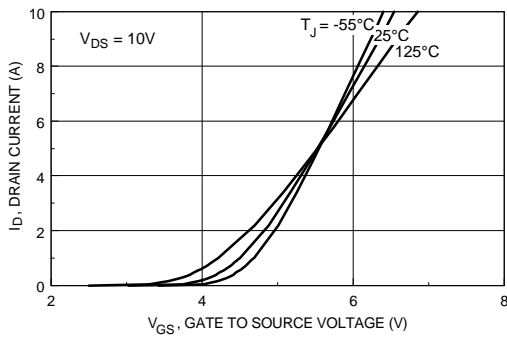

Figure 5. Transfer Characteristics.

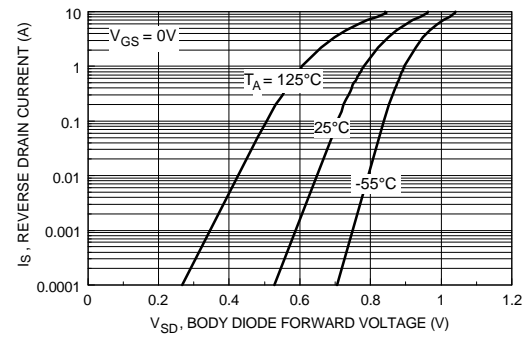

Figure 6. Body Diode Forward Voltage Variation with Current and Temperature.

## Typical Electrical Characteristics (continued)

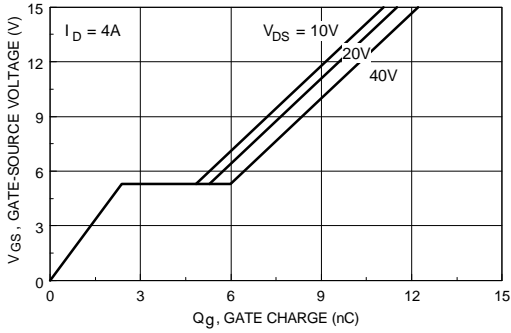

Figure 7. Gate Charge Characteristics.

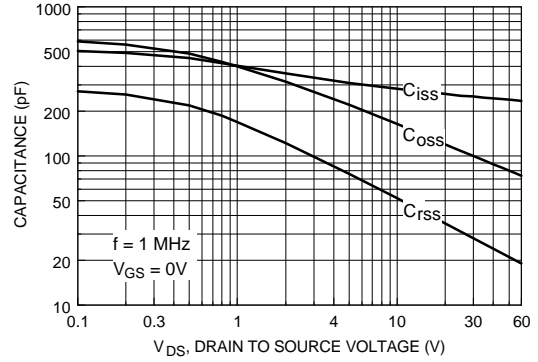

Figure 8. Capacitance Characteristics.

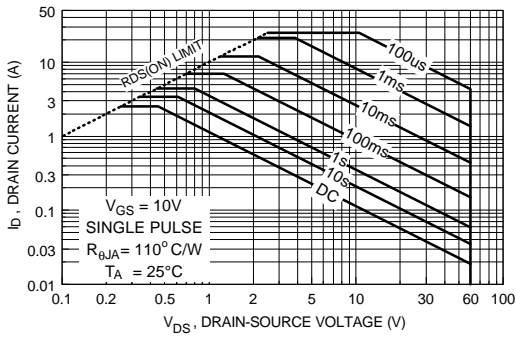

Figure 9. Maximum Safe Operating Area.

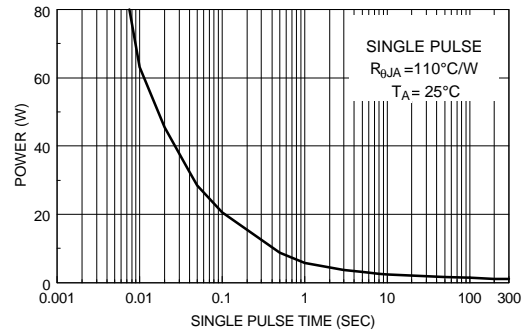

Figure 10. Single Pulse Maximum Power Dissipation.

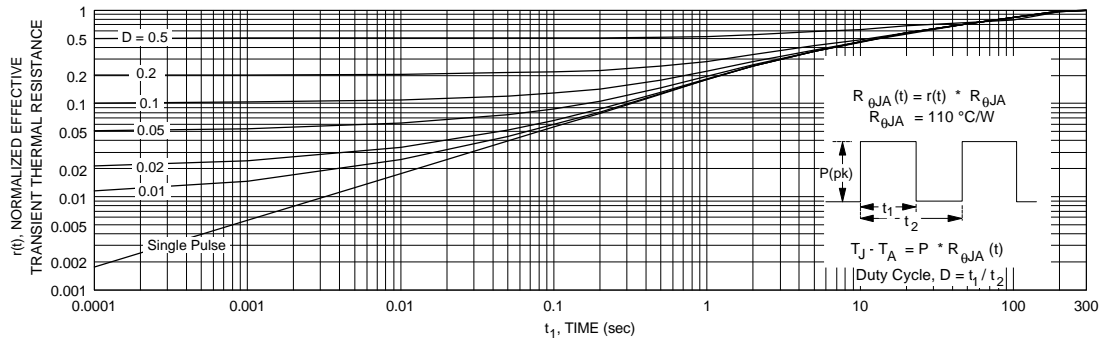
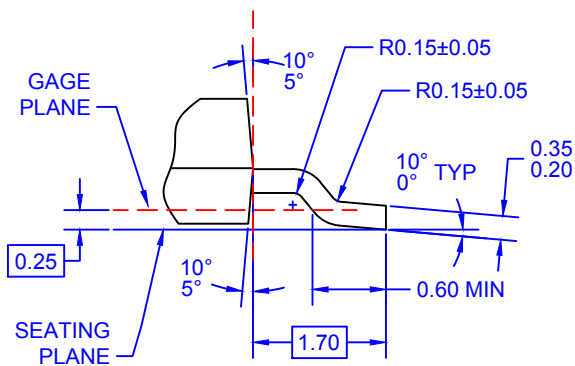

Figure 11. Transient Thermal Response Curve.

Thermal characterization performed using the conditions described in note 1c.  
Transient thermal response will change depending on the circuit board design.



LAND PATTERN RECOMMENDATION



DETAIL A  
SCALE: 2:1

- NOTES: UNLESS OTHERWISE SPECIFIED  
 A) DRAWING BASED ON JEDEC REGISTRATION TO-261C, VARIATION AA.  
 B) ALL DIMENSIONS ARE IN MILLIMETERS.  
 C) DIMENSIONS DO NOT INCLUDE BURRS OR MOLD FLASH. MOLD FLASH OR BURRS DOES NOT EXCEED 0.10MM.  
 D) DIMENSIONING AND TOLERANCING PER ASME Y14.5M-2009.  
 E) LANDPATTERN NAME: SOT230P700X180-4BN  
 F) DRAWING FILENAME: MKT-MA04AREV3



ON Semiconductor and  are trademarks of Semiconductor Components Industries, LLC dba ON Semiconductor or its subsidiaries in the United States and/or other countries. ON Semiconductor owns the rights to a number of patents, trademarks, copyrights, trade secrets, and other intellectual property. A listing of ON Semiconductor's product/patent coverage may be accessed at [www.onsemi.com/site/pdf/Patent-Marking.pdf](http://www.onsemi.com/site/pdf/Patent-Marking.pdf). ON Semiconductor reserves the right to make changes without further notice to any products herein. ON Semiconductor makes no warranty, representation or guarantee regarding the suitability of its products for any particular purpose, nor does ON Semiconductor assume any liability arising out of the application or use of any product or circuit, and specifically disclaims any and all liability, including without limitation special, consequential or incidental damages. Buyer is responsible for its products and applications using ON Semiconductor products, including compliance with all laws, regulations and safety requirements or standards, regardless of any support or applications information provided by ON Semiconductor. "Typical" parameters which may be provided in ON Semiconductor data sheets and/or specifications can and do vary in different applications and actual performance may vary over time. All operating parameters, including "Typicals" must be validated for each customer application by customer's technical experts. ON Semiconductor does not convey any license under its patent rights nor the rights of others. ON Semiconductor products are not designed, intended, or authorized for use as a critical component in life support systems or any FDA Class 3 medical devices or medical devices with a same or similar classification in a foreign jurisdiction or any devices intended for implantation in the human body. Should Buyer purchase or use ON Semiconductor products for any such unintended or unauthorized application, Buyer shall indemnify and hold ON Semiconductor and its officers, employees, subsidiaries, affiliates, and distributors harmless against all claims, costs, damages, and expenses, and reasonable attorney fees arising out of, directly or indirectly, any claim of personal injury or death associated with such unintended or unauthorized use, even if such claim alleges that ON Semiconductor was negligent regarding the design or manufacture of the part. ON Semiconductor is an Equal Opportunity/Affirmative Action Employer. This literature is subject to all applicable copyright laws and is not for resale in any manner.

## PUBLICATION ORDERING INFORMATION

### LITERATURE FULFILLMENT:

Literature Distribution Center for ON Semiconductor  
19521 E. 32nd Pkwy, Aurora, Colorado 80011 USA  
**Phone:** 303-675-2175 or 800-344-3860 Toll Free USA/Canada  
**Fax:** 303-675-2176 or 800-344-3867 Toll Free USA/Canada  
**Email:** [orderlit@onsemi.com](mailto:orderlit@onsemi.com)

**N. American Technical Support:** 800-282-9855 Toll Free  
USA/Canada  
**Europe, Middle East and Africa Technical Support:**  
Phone: 421 33 790 2910  
**Japan Customer Focus Center**  
Phone: 81-3-5817-1050

**ON Semiconductor Website:** [www.onsemi.com](http://www.onsemi.com)  
**Order Literature:** <http://www.onsemi.com/orderlit>  
For additional information, please contact your local  
Sales Representative