

**PLEASE CHECK WWW.MOLEX.COM FOR LATEST PART INFORMATION**

**Part Number:** [0747260001](#)  
**Status:** **Active**  
**Overview:** SFP+ and SFP Interconnect Solutions  
**Description:** SFP Cage Lightpipe Cover Assembly, 1-by-1, Rear Mount

**Documents:**

[Drawing \(PDF\)](#) [RoHS Certificate of Compliance \(PDF\)](#)  
[Packaging Specification PK-74726-001 \(PDF\)](#)

**General**

Product Family	EMI Cages
Series	<a href="#">74726</a>
Application	N/A
Comments	Rear mount lightpipe location
Component Type	Lightpipe
Overview	<a href="#">SFP+ and SFP Interconnect Solutions</a>
Product Name	SFP
UPC	822348616657
Use With	<a href="#">74737</a>

**Physical**

EMI Panel / Bezel Mount	N/A
Light Pipes per Port	N/A
Material - Metal	N/A
Net Weight	0.300/g
Orientation	Horizontal
Packaging Type	Tray
Port Configuration	1x1
Rear Legs	0
Termination Interface: Style	N/A
Thermal Height	N/A
Thermal Solutions	N/A

**Solder Process Data**

Lead-freeProcess Capability	N/A
Process Temperature max. C	070

**Material Info**

**Reference - Drawing Numbers**

Packaging Specification	PK-74726-001
Sales Drawing	SD-74726-001

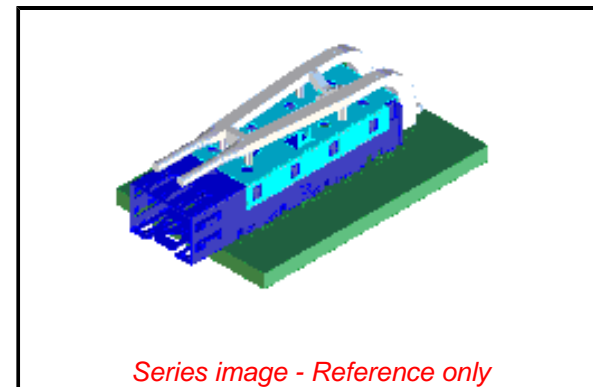

*Series image - Reference only*

**EU ELV**

**Not Relevant**

**EU RoHS**

**Compliant**

**REACH SVHC**

Not Contained Per -  
ED/21/2016 (20 June  
2016)

**Halogen-Free**

**Status**

**Not Low-Halogen**

**Need more information on product  
environmental compliance?**

Email [productcompliance@molex.com](mailto:productcompliance@molex.com)  
Please visit the [Contact Us](#) section for any  
non-product compliance questions.

China ROHS	Green Image
ELV	Not Relevant
RoHS Phthalates	Not Contained

**Search Parts in this Series**

[74726 Series](#)

**PLEASE CHECK WWW.MOLEX.COM FOR LATEST PART INFORMATION**