

## Base strip - MC 0,5/ 4-G-2,5 - 1881464

Please be informed that the data shown in this PDF Document is generated from our Online Catalog. Please find the complete data in the user's documentation. Our General Terms of Use for Downloads are valid (<http://phoenixcontact.com/download>)

Header, nominal current: 4 A, rated voltage (III/2): 160 V, number of positions: 4, pitch: 2.5 mm, Color: green, Contact surface: Tin, mounting: Wave soldering

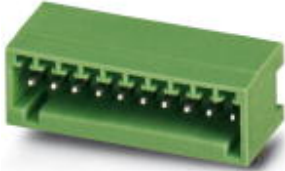

The figure shows a 10-position version of the product

### Why buy this product

- Well-known mounting principle allows worldwide use



### Key Commercial Data

|                                      |   |
|--------------------------------------|---|
| Packing unit                         | 1 STK   |
| Minimum order quantity               | 50 STK  |
| GTIN                                 | <br>4 017918 156701 |
| GTIN                                 | 4017918156701   |
| Weight per Piece (excluding packing) | 1.110 g   |
| Custom tariff number                 | 85366930  |
| Country of origin                    | Germany   |

### Technical data

#### Dimensions

|                       |          |
|-----------------------|----------|
| Length                | 10.1 mm  |
| Pitch                 | 2.5 mm   |
| Dimension a           | 7.50 mm  |
| Width                 | 11.90 mm |
| Constructional height | 8.1 mm   |
| Height                | 11.9 mm  |

## Base strip - MC 0,5/ 4-G-2,5 - 1881464

### Technical data

#### Dimensions

|                          |              |
|--------------------------|--------------|
| Length of the solder pin | 3.8 mm       |
| Pin dimensions           | 0,8 x 0,8 mm |
| Hole diameter            | 1.2 mm       |

#### General

|  |              |
|--|--------------|
| Range of articles                      | MC 0,5/...-G |
| Insulating material group              | I            |
| Rated surge voltage (III/3)            | 1.5 kV       |
| Rated surge voltage (III/2)            | 2.5 kV       |
| Rated surge voltage (II/2)             | 2.5 kV       |
| Rated voltage (III/3)                  | 80 V         |
| Rated voltage (III/2)                  | 160 V        |
| Rated voltage (II/2)                   | 320 V        |
| Connection in acc. with standard       | EN-VDE       |
| Nominal current I <sub>N</sub>         | 4 A          |
| Maximum load current                   | 4 A          |
| Insulating material                    | PA           |
| Flammability rating according to UL 94 | V0           |
| Color                                  | green        |
| Number of positions                    | 4            |

#### Standards and Regulations

|  |        |
|--|--------|
| Connection in acc. with standard       | EN-VDE |
|  | CUL    |
| Flammability rating according to UL 94 | V0     |

#### Environmental Product Compliance

|            |   |
|------------|---|
| China RoHS | Environmentally friendly use period: unlimited = EFUP-e |
|            | No hazardous substances above threshold values          |

### Drawings

# Base strip - MC 0,5/ 4-G-2,5 - 1881464

Diagram

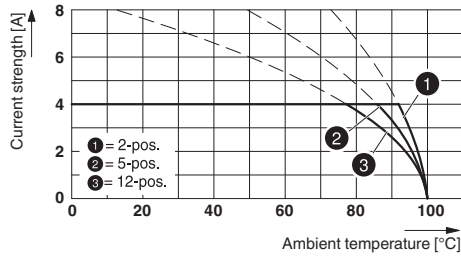

Drilling diagram

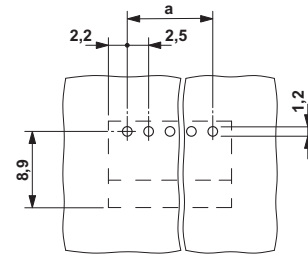

Type: FK-MC 0,5/...-ST-2,5 with MC 0,5/...-G-2,5

Diagram

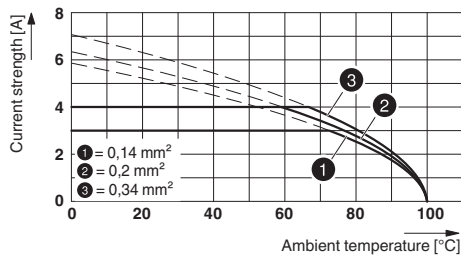

Dimensional drawing

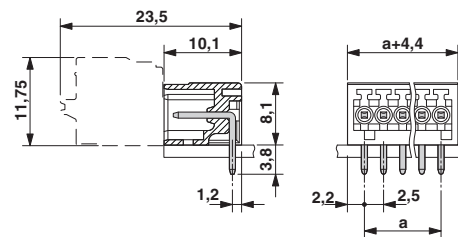

Type: FK-MC 0,5/...-ST-2,5 with MC 0,5/...-G-2,5

## Classifications

eCl@ss

|            |          |
|------------|----------|
| eCl@ss 4.0 | 272607xx |
| eCl@ss 4.1 | 27260701 |
| eCl@ss 5.0 | 27260701 |
| eCl@ss 5.1 | 27260701 |
| eCl@ss 6.0 | 27260704 |
| eCl@ss 7.0 | 27440402 |
| eCl@ss 8.0 | 27440402 |
| eCl@ss 9.0 | 27440402 |

ETIM

|          |          |
|----------|----------|
| ETIM 3.0 | EC001121 |
| ETIM 4.0 | EC002637 |
| ETIM 5.0 | EC002637 |
| ETIM 6.0 | EC002637 |

# Base strip - MC 0,5/ 4-G-2,5 - 1881464

## Classifications

### UNSPSC

|               |          |
|---------------|----------|
| UNSPSC 6.01   | 30211810 |
| UNSPSC 7.0901 | 39121409 |
| UNSPSC 11     | 39121409 |
| UNSPSC 12.01  | 39121409 |
| UNSPSC 13.2   | 39121409 |

## Approvals

### Approvals

#### Approvals

UL Recognized / VDE Gutachten mit Fertigungsüberwachung / cUL Recognized / IECCE CB Scheme / CCA / EAC / cULus Recognized

#### Ex Approvals

### Approval details

|                    |   |   |              |
|--------------------|---|---|--------------|
| UL Recognized      |  | <a href="http://database.ul.com/cgi-bin/XYV/template/LISEXT/1FRAME/index.htm">http://database.ul.com/cgi-bin/XYV/template/LISEXT/1FRAME/index.htm</a> | FILE E 60425 |
|                    |   |   | B            |
| Nominal current IN |   |   | 4 A          |
| Nominal voltage UN |   |   | 125 V        |

|   |   |   |          |
|---|---|---|----------|
| VDE Gutachten mit Fertigungsüberwachung |  | <a href="http://www.vde.com/en/Institute/OnlineService/VDE-approved-products/Pages/Online-Search.aspx">http://www.vde.com/en/Institute/OnlineService/VDE-approved-products/Pages/Online-Search.aspx</a> | 40013394 |
|   |   |   |          |
| Nominal current IN                      |   |   | 4 A      |
| Nominal voltage UN                      |   |   | 80 V     |

|                    |   |   |              |
|--------------------|---|---|--------------|
| cUL Recognized     |  | <a href="http://database.ul.com/cgi-bin/XYV/template/LISEXT/1FRAME/index.htm">http://database.ul.com/cgi-bin/XYV/template/LISEXT/1FRAME/index.htm</a> | FILE E 60425 |
|                    |   |   | B            |
| Nominal current IN |   |   | 4 A          |

## Base strip - MC 0,5/ 4-G-2,5 - 1881464

### Approvals

|                    |       |
|--------------------|-------|
|                    | B     |
| Nominal voltage UN | 125 V |

|                    |   |   |                |
|--------------------|---|---|----------------|
| IECEE CB Scheme    |  | <a href="http://www.iecee.org/">http://www.iecee.org/</a> | DE1-56068-B1B2 |
| Nominal current IN | 4 A   |   |                |
| Nominal voltage UN | 80 V  |   |                |

|                    |                |
|--------------------|----------------|
| CCA                | CCA/ DE1 34250 |
| Nominal current IN | 4 A            |
| Nominal voltage UN | 80 V           |

|     |  |         |
|-----|--|---------|
| EAC |  | B.01742 |
|-----|--|---------|

|                  |   |   |
|------------------|---|---|
| cULus Recognized |  | <a href="http://database.ul.com/cgi-bin/XYV/template/LISEXT/1FRAME/index.htm">http://database.ul.com/cgi-bin/XYV/template/LISEXT/1FRAME/index.htm</a> |
|------------------|---|---|

### Accessories

Accessories

Coding element

Coding profile - CP-MC 0,5 - 1881435

Coding profile, is inserted into the groove in the header, red insulating material



Labeled terminal marker

## Base strip - MC 0,5/ 4-G-2,5 - 1881464

### Accessories

Marker card - SK 2,54/2,8:FORTL.ZAHLEN - 0804853



Marker card, Card, white, labeled, Horizontal: Consecutive numbers 1 - 10, 11 - 20, etc. up to 91 - 99, Mounting type: Adhesive, for terminal block width: 2.54 mm, Lettering field: 2.54 x 2.8 mm

---

### Additional products

Printed-circuit board connector - FK-MC 0,5/ 4-ST-2,5 - 1881341



Plug component, nominal current: 4 A, rated voltage (III/2): 160 V, number of positions: 4, pitch: 2.5 mm, connection method: Push-in spring connection, Color: green, Contact surface: Tin