

X-Lok Field Installable | Installation Instruction

Female Connector Type

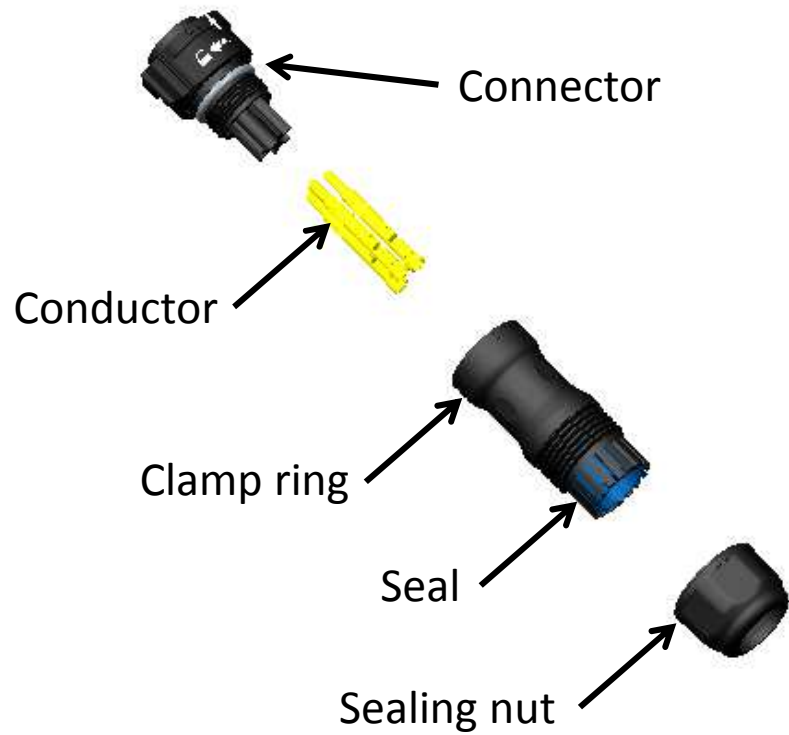

Male Connector Type

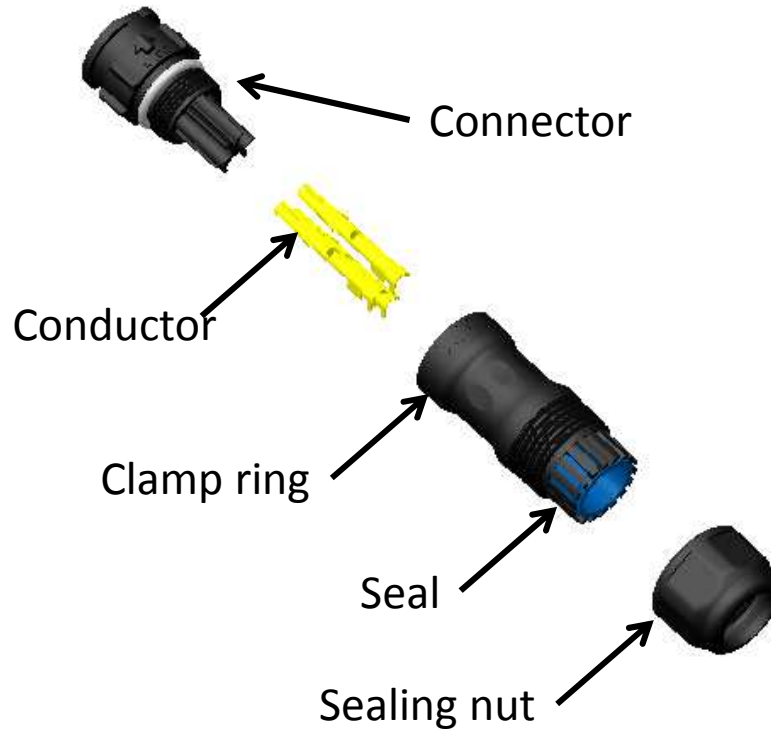

X-Lok Field Installable | Installation Instruction

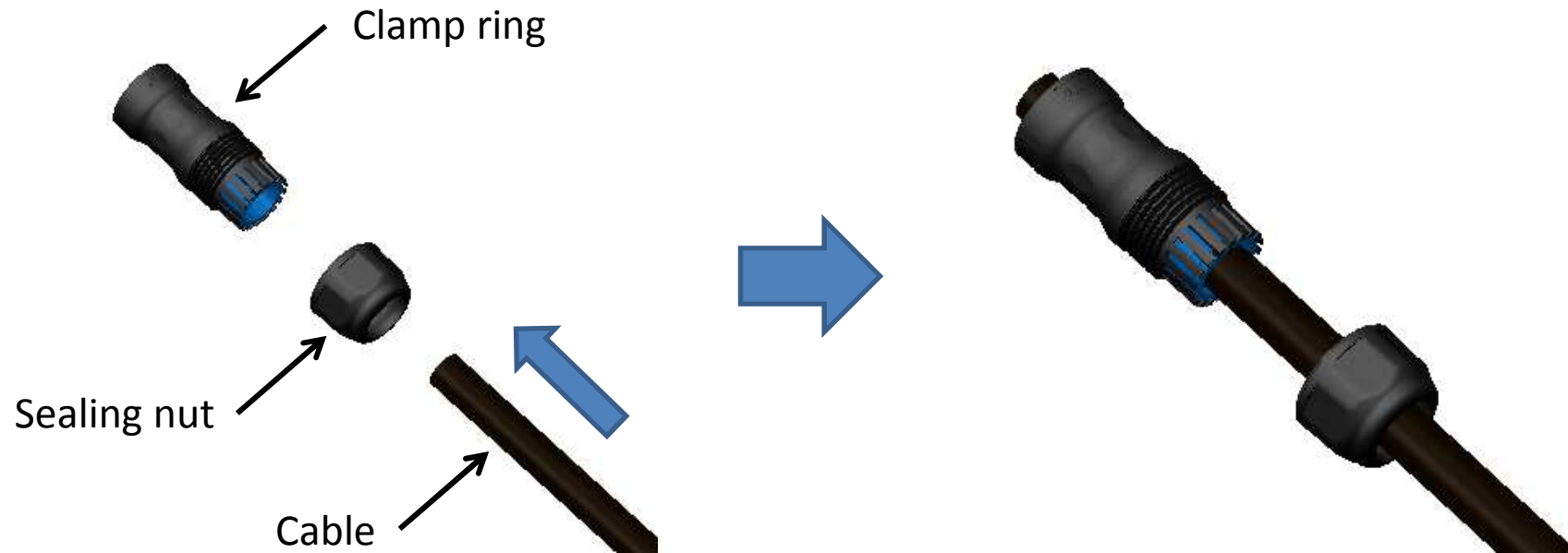

1. Insert the stripped cable through sealing nut

2. Insert the stripped cable through clamp ring

X-Lok Field Installable | Installation Instruction

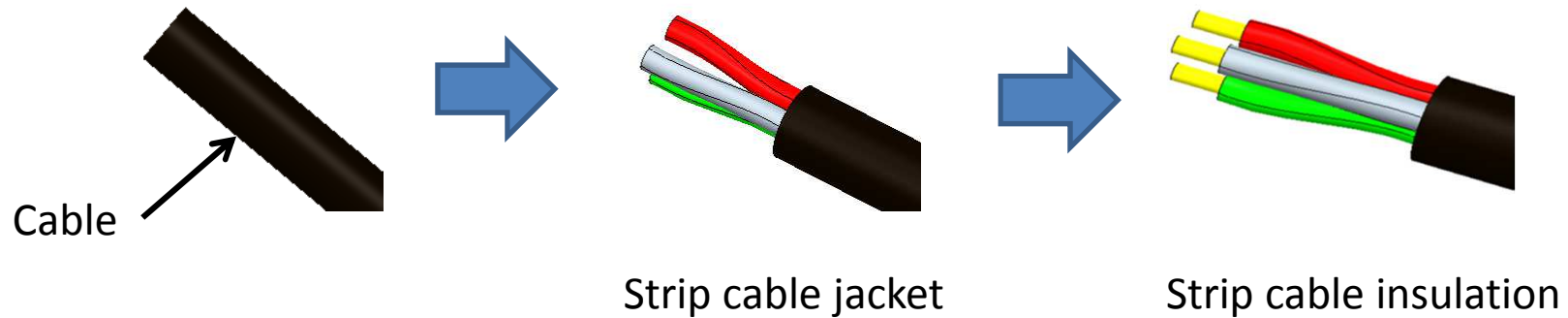

Cable Processing Instruction

Terminal Type	Strip Insulation Length (A)	Strip Jacket Length (B)
5A	3.5~4	16~18
10A	5~5.5	16~18
20A	5~5.5	18~20

Unit : mm

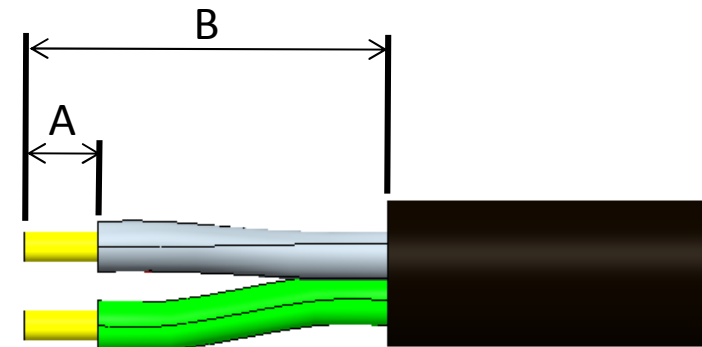

注意:未依照線材加工尺寸，線材與Seal結合不正確，會產生防水功能失效。

Note: Please follow above cable processing instruction . Waterproof failure may caused by incorrect wire and seal assembly .

X-Lok Field Installable | Installation Instruction

Quality Check for Strip cable insulation

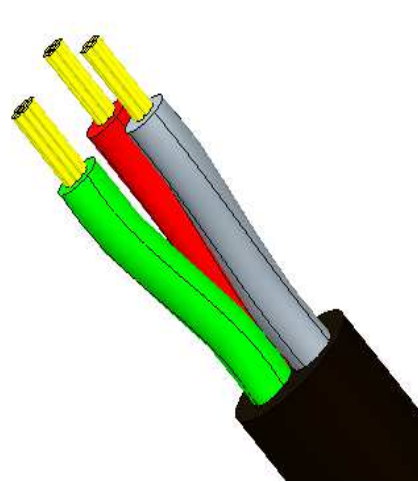

Good

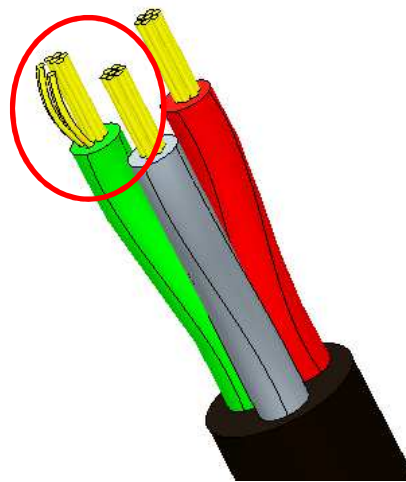

NG

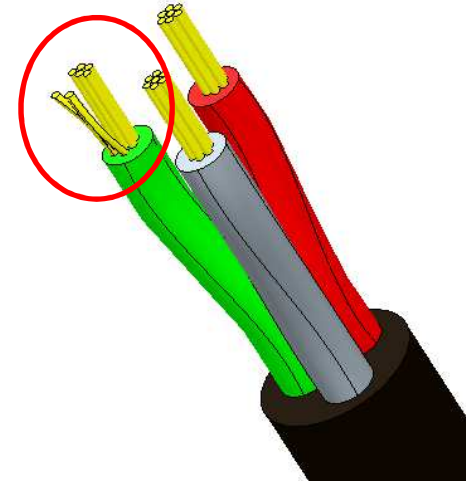

NG

X-Lok Field Installable | Installation Instruction



Push crimp contact into opening of crimping tool

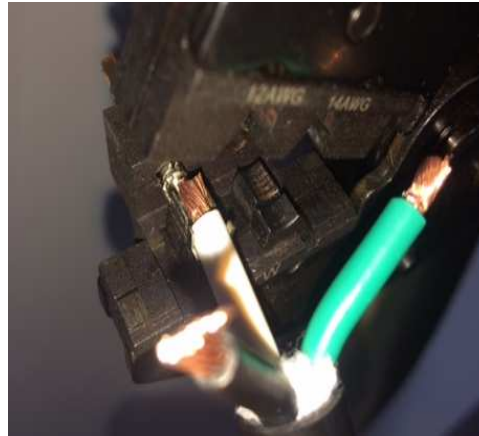

Insert stripped wire into the funnel shaped end of the crimp contact



Squeeze handles of crimping tool together and connect contact to wire

Terminal Type	Tool NO
5A	ASST-C-05-W-A
10A	ASST-C-10-W-B
20A	ASST-C-20-W-C

X-Lok Field Installable | Installation Instruction

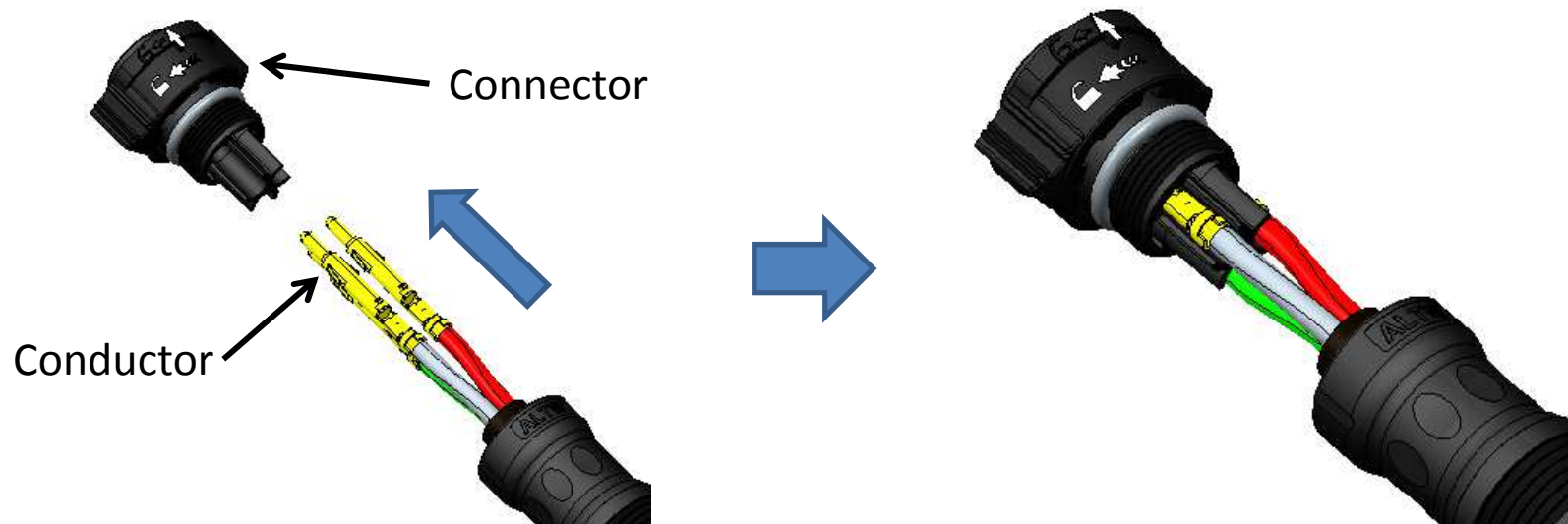

Place the conductor to correct contact and push it until you hear it click

注意：端子安裝後，不可以退出。請依據需求wire 顏色，安裝到適當孔。

Note: Once conductor is assembled, disassembly is not allowed. Please cross check the wire color with contact before assembly.

X-Lok Field Installable | Installation Instruction

Quality check for conductor installation



Good



NG

X-Lok Field Installable | Installation Instruction

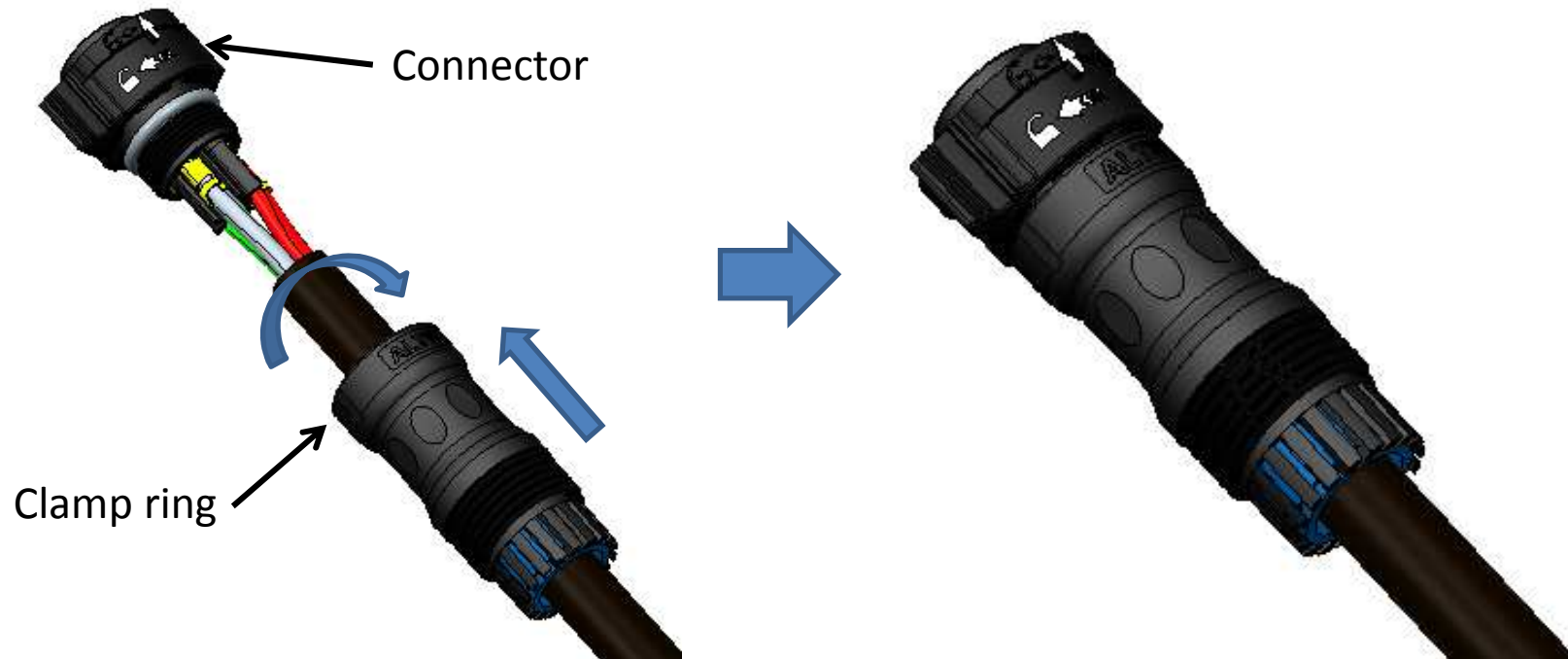

Screw the clamp ring and connector

Clamping ring Torque: 6~8kgf.cm(0.58~0.78N.m)

X-Lok Field Installable | Installation Instruction

Quality check for Conductor installation

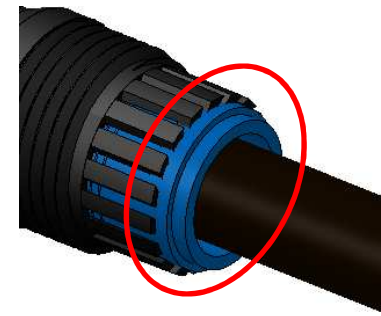
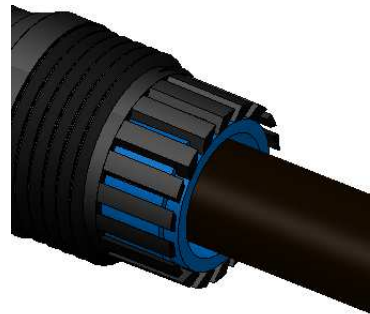
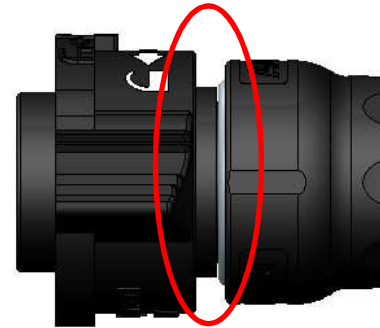
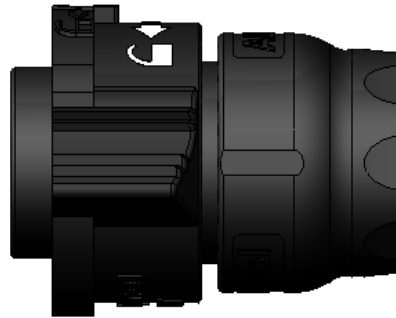

Seal aligns the Clamp ring face

Good

NG

X-Lok Field Installable | Installation Instruction

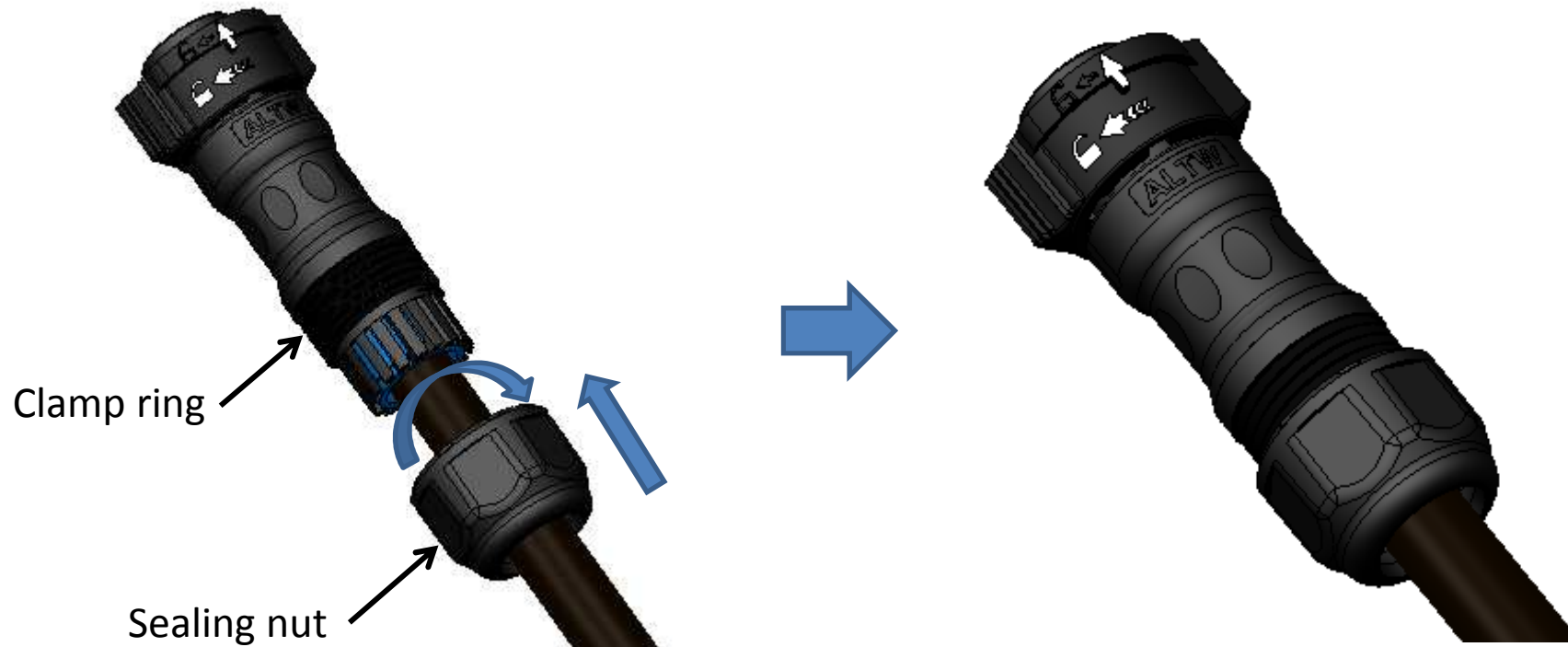

Screw the sealing nut to the clamp ring

Seal Nut Torque: 6~8kgf.cm(0.58~0.78N.m)

X-Lok Field Installable_Crimp | Installation Instruction

Suggestion for Conductor and wire connection

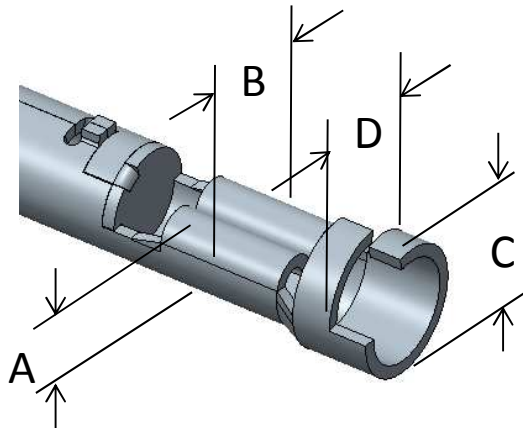

Terminal Type	Wire AWG	Conductor clip		Insulation clip	
		High(A)	Width(B)	High(C)	Width(D)
5A	22AWG	0.95	1.60	NA	NA
	20AWG	1.05	1.60	NA	NA
10A	18AWG	1.60	2.30	2.30	2.90
	16AWG	1.80	2.35	2.75	2.90
20A	14AWG	2.35	3.50	3.80	4.00
	12AWG	2.70	3.60	4.20	4.20

Unit : mm

Terminal Type	Wire AWG	Test tension Kg
5A	22#	3.6
	20#	4.5
10A	18#	4.5
	16#	6.8
20A	14#	11.3
	12#	15.9

注意：未依照尺寸加工，會影響電流傳輸效能。建議購改標準工具。

Note: Conduction performance may be effected with incorrect assembly . Suggest to purchase the ALTW standard tool .

X-Lok Field Installable_Crimp | Installation Instruction

Seal usage information

Type	Color	Max Cable OD	Min Coble OD
B Size	Red	6.0mm	5.0mm
	Yellow	8.0mm	6.0mm
	Blue	10.0mm	8.0mm
C Size	Red	8.0mm	6.0mm
	Yellow	10.0mm	8.0mm
	Blue	12.0mm	10.0mm
D Size	Red	10.0mm	8.0mm
	Yellow	12.0mm	10.0mm
	Blue	14.0mm	12.0mm

注意:選擇不適當Seal，防水性能會降低或失效。Cable OD 過大，會產生Cable 不容易穿過Seal

Note: Inappropriate choice of seal will lead the waterproof failure. Oversized cable OD will be difficult to through the seal.

X-Lok Field Installable_Crimp | Installation Instruction

Cable formal specification

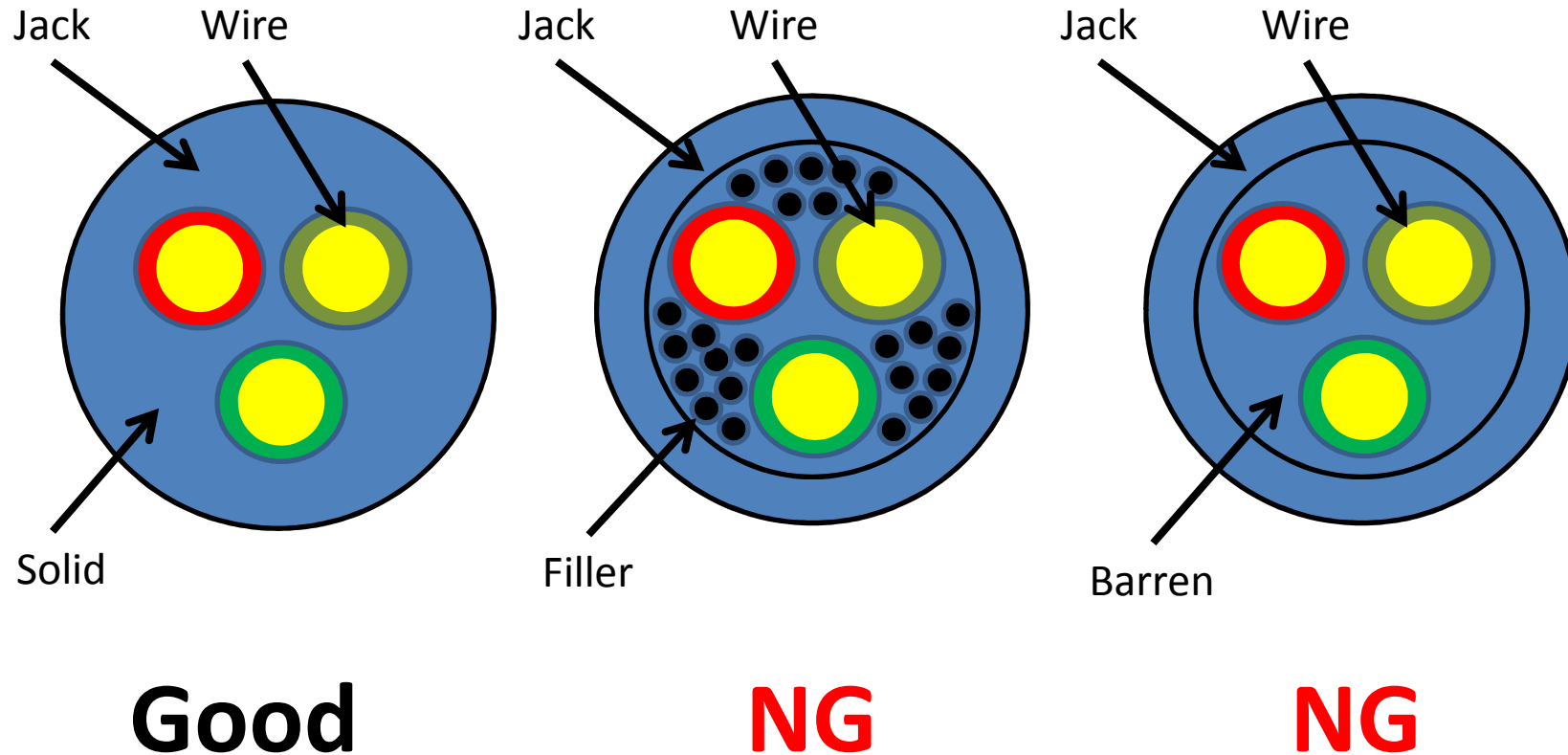

注意:選擇不適當Cable 規格，防水性能會降低或失效。
Note: Inappropriate choice of cable will lead the waterproof failure.

X-Lok Field Installable_Crimp | Installation Instruction

Connector mating information

- 1.外觀上面符號對準，連接器需要平行對插。
1. Please align the arrow symbol and mating the connector in parallel.

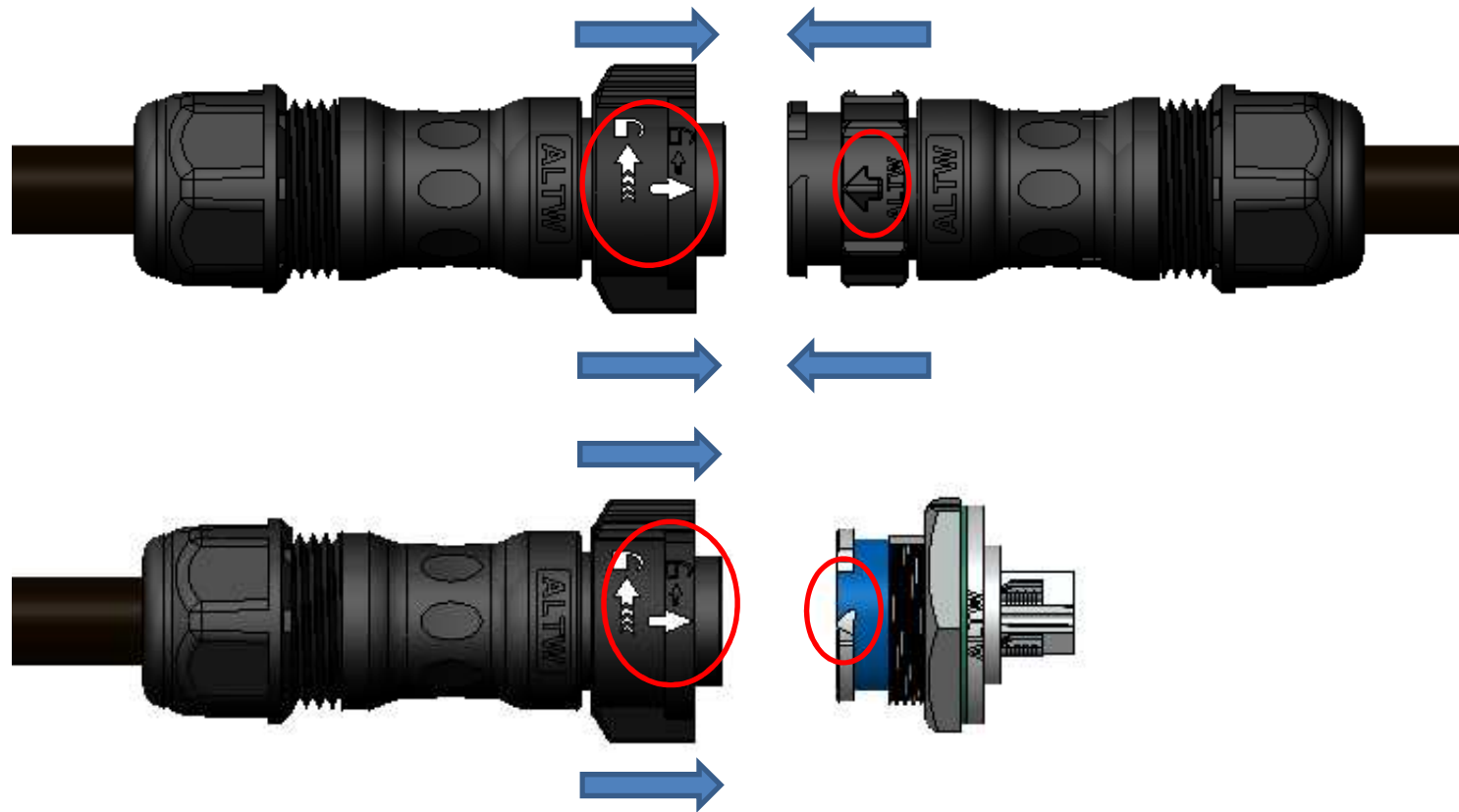
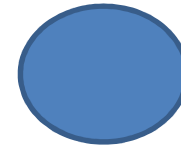

X-Lok Field Installable_Crimp | Installation Instruction

Connector mating information

1. 不可以將連接器非平行對插。
1. Do not mating the connector non-parallel.

