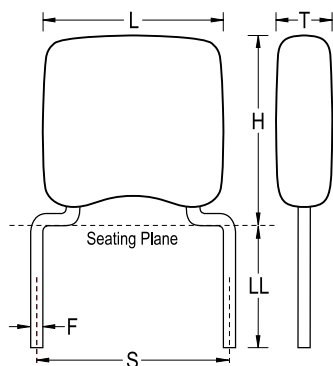

Ceramic, Commercial Grade, GoldMax, 2.2 uF, 20%, 50 V, Z5U, Lead Spacing = 5.08mm

**Dimensions**

L	7.11mm MAX
H	9.14mm MAX
T	4.07mm MAX
S	5.08mm NOM
LL	7mm MIN
F	0.51mm NOM

Packaging Specifications

Packaging:	Bulk, Bag
Packaging Quantity:	250

General Information

Style:	Radial
Series:	GoldMax
Description:	GoldMax, Commercial Standard
RoHS:	Yes
Termination:	Tin
Failure Rate:	N/A

Specifications

Capacitance:	2.2 uF
Capacitance Tolerance:	20%
Voltage DC:	50 VDC
Temperature Range:	+10/+85C
Temperature Coefficient:	Z5U
Dissipation Factor:	10%
Aging Rate:	7% Loss/Decade Hour
Insulation Resistance:	50 MOhms
Dielectric Strength:	125 V