

**60**mm sq.

# San Ace 60



## General Specifications

- Material ..... Frame: Plastics (Flammability: UL94V-0),  
Impeller: Plastics (Flammability: UL94V-1)
- Expected Life ..... Refer to specifications (L10:Survival rate:90% at 60°C ,  
rated voltage, and continuously run in a free air state)
- Lead Wire ..... ⊕red ⊖black or blue (Sensor) yellow
- Storage Temperature ..... -30°C to +70°C (Non-condensing)

**60×60×15**mm (Mass : 60g) **9P**type

## Specifications

The following nos. **have pulse sensors and ribs.**

| Model No.           | Rated Voltage [V] | Operating Voltage Range [V] | Rated Current [A] | Rated Input [W] | Rated Speed [min <sup>-1</sup> ] | Max. Airflow [m <sup>3</sup> /min] [CFM] | Max. Static Pressure [Pa] [inchH <sub>2</sub> O] | SPL [dB(A)] | Operating Temperature [°C] | Expected Life [h] |
|---------------------|-------------------|-----------------------------|-------------------|-----------------|----------------------------------|--|--|-------------|----------------------------|-------------------|
| <b>109P0605H701</b> | 5                 | 4.5 to 5.5                  | 0.26              | 1.30            | 4,100                            | 0.40 14.1                                | 38.2 0.153                                       | 32          | -20 to +70                 | 60,000/60°C       |
| <b>109P0605M701</b> |                   |                             | 0.15              | 0.75            | 3,100                            | 0.30 10.6                                | 22.6 0.091                                       | 25          |                            |                   |
| <b>109P0612K701</b> | 12                | 10.2 to 13.8                | 0.26              | 3.12            | 6,500                            | 0.62 21.9                                | 99.3 0.399                                       | 45          | -20 to +60                 | 40,000/60°C       |
| <b>109P0612S701</b> |                   |                             | 0.15              | 1.80            | 5,000                            | 0.48 17.0                                | 58.8 0.236                                       | 36          |                            |                   |
| <b>109P0612H701</b> |                   | 7 to 13.8                   | 0.09              | 1.08            | 4,100                            | 0.40 14.1                                | 38.2 0.153                                       | 32          |                            |                   |
| <b>109P0612M701</b> |                   |                             | 0.07              | 0.84            | 3,100                            | 0.30 10.6                                | 22.6 0.091                                       | 25          |                            |                   |
| <b>109P0612B701</b> | 10.2 to 13.8      | 0.05                        | 0.6               | 2,200           | 0.21 7.42                        | 11.7 0.047                               | 21   | -20 to +70  | 60,000/60°C                |                   |
| <b>109P0624J701</b> | 24                | 14 to 27.6                  | 0.14              | 3.36            | 6,200                            | 0.61 21.5                                | 86.5 0.347                                       | 44          | -20 to +60                 | 40,000/60°C       |
| <b>109P0624S701</b> |                   |                             | 0.08              | 1.92            | 5,000                            | 0.48 16.9                                | 58.8 0.236                                       | 36          |                            |                   |
| <b>109P0624H701</b> |                   | 20.4 to 27.6                | 0.06              | 1.44            | 4,100                            | 0.40 14.1                                | 38.2 0.153                                       | 32          |                            |                   |
| <b>109P0624M701</b> |                   |                             | 0.04              | 0.96            | 3,100                            | 0.30 10.6                                | 22.6 0.091                                       | 25          |                            |                   |

Models without sensors or with lock sensors are available as options. Please refer to the index (p. 467).

## Dimensions (unit: mm)

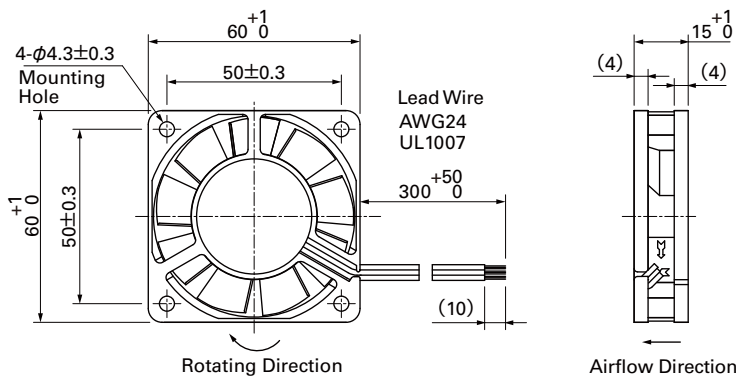

## Reference Dimensions of Mounting Holes and Vent opening (unit: mm)

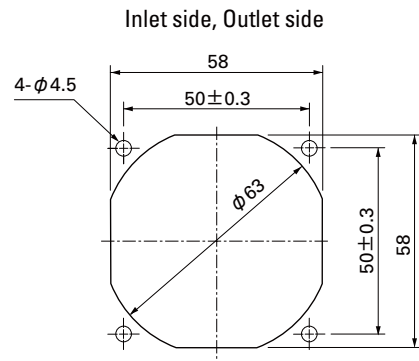

## Options (unit: mm)

### Finger Guards

Model : 109-139E Surface treatment : Nickel-chrome plating (silver)  
: 109-139H : Cation electropainting (black)

Inlet side, Outlet side

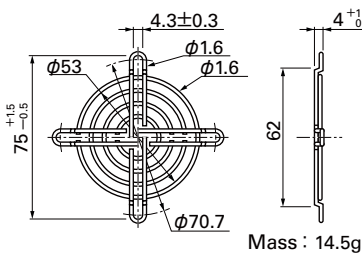

### Resin Finger Guards

Model : 109-1003G

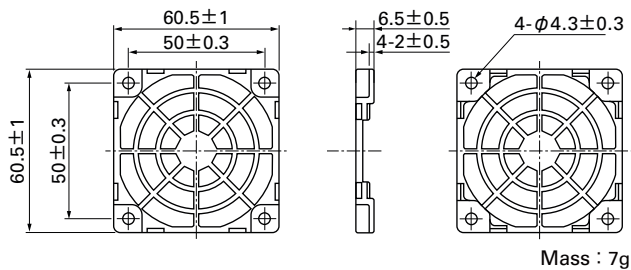

**Resin Filter Kits**

Model : 109-1003F13 (13PPI), 109-1003F20 (20PPI)  
 : 109-1003F30 (30PPI), 109-1003F40 (40PPI)

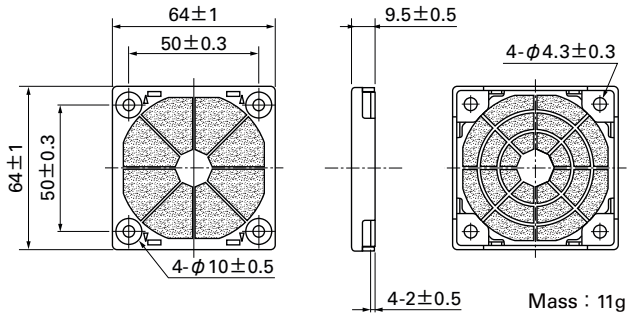

**Airflow - Static Pressure Characteristics**

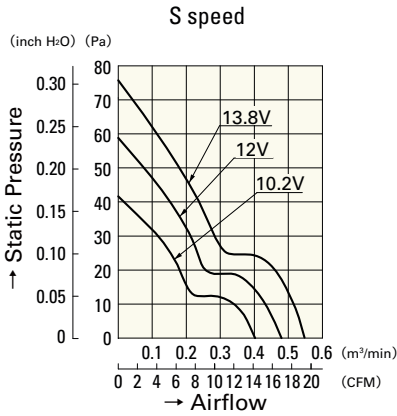

**109P0612S701**

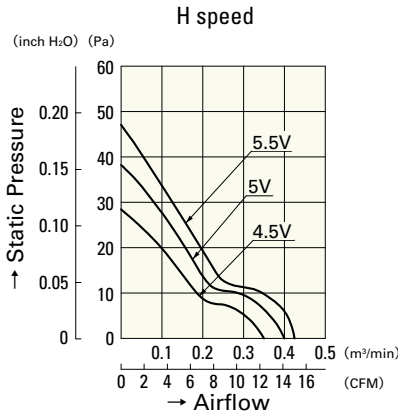

**109P0605H701**

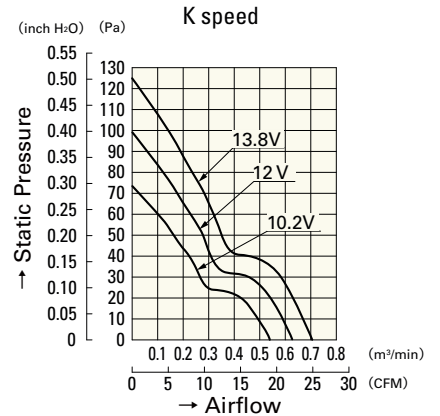

**109P0612K701**

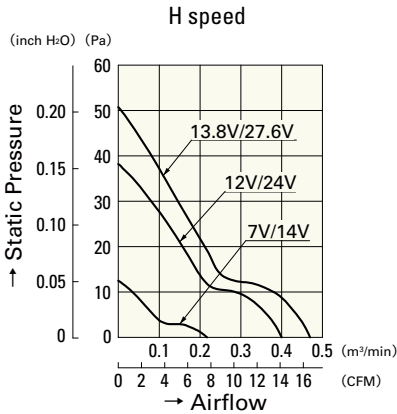

**109P0612H701**  
**109P0624H701**

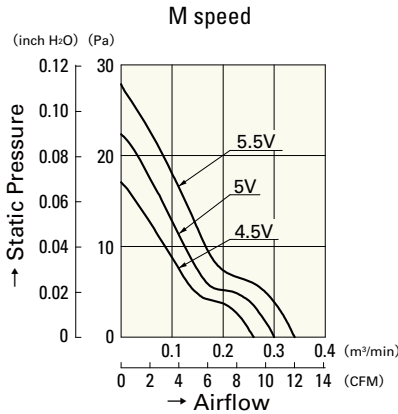

**109P0605M701**

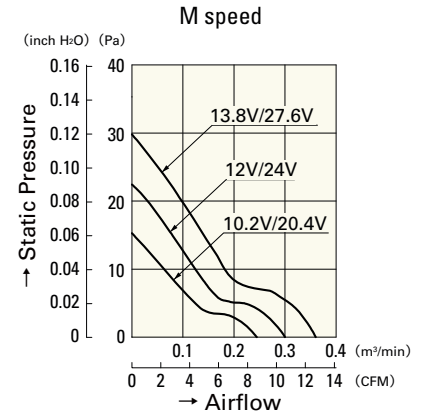

**109P0612M701**  
**109P0624M701**

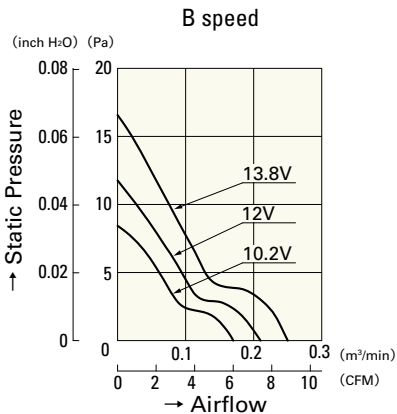

**109P0612B701**

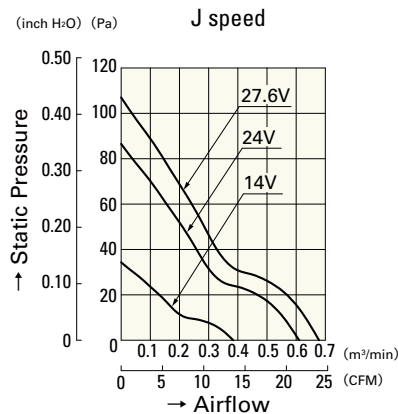

**109P0624J701**

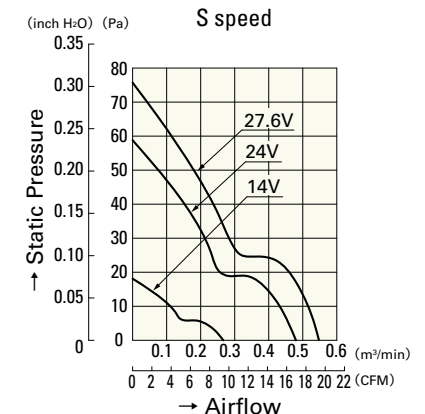

**109P0624S701**