

RJ45 socket insert - VS-08-BU-RJ45/LP-1 - 1688586

Please be informed that the data shown in this PDF Document is generated from our Online Catalog. Please find the complete data in the user's documentation. Our General Terms of Use for Downloads are valid (<http://phoenixcontact.com/download>)

RJ45 socket insert, 1x, for PCB assembly, CAT5, 8-pos., shielded, with angled solder pins



Key Commercial Data

Packing unit	5 STK
Minimum order quantity	5 STK
GTIN	 4 017918 622350
GTIN	4017918622350
Weight per Piece (excluding packing)	12.500 g
Custom tariff number	85366990
Country of origin	China

Technical data

Mechanical characteristics

Number of positions	8
Number of slots	1
Connection profile	RJ45
Insertion/withdrawal cycles	≥ 750
Connection method	Solder connection
Degree of protection	IP20

Ambient conditions

Ambient temperature (operation)	-40 °C ... 85 °C
---------------------------------	------------------

Material data

Flammability rating according to UL 94	V0
Contact carrier material	Thermoplastic
Contact material	Copper alloy
Contact surface material	Gold over nickel

RJ45 socket insert - VS-08-BU-RJ45/LP-1 - 1688586

Technical data

Electrical characteristics

Number of positions	8
Transmission characteristics (category)	CAT5 (IEC 11801:2002)
Rated current	1.5 A
Overvoltage category	II
Degree of pollution	2
Rated voltage (III/3)	150 V

Standards and Regulations

Flammability rating according to UL 94	V0
--	----

Environmental Product Compliance

China RoHS	Environmentally friendly use period: unlimited = EFUP-e
	No hazardous substances above threshold values

Drawings

Schematic diagram

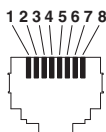

Dimensional drawing

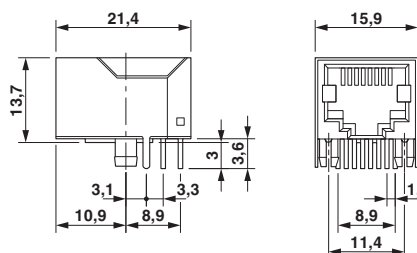

RJ45 socket insert

Drilling diagram

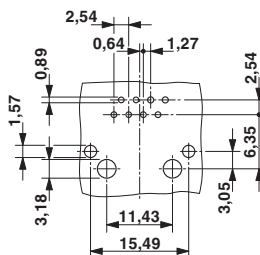

Drilling diagram

Classifications

eCl@ss

eCl@ss 4.0	27140816
eCl@ss 4.1	27260701

RJ45 socket insert - VS-08-BU-RJ45/LP-1 - 1688586

Classifications

eCl@ss

eCl@ss 5.0	27260701
eCl@ss 5.1	27260701
eCl@ss 6.0	27260705
eCl@ss 7.0	27440309
eCl@ss 8.0	27440205
eCl@ss 9.0	27440205

ETIM

ETIM 2.0	EC000438
ETIM 3.0	EC000438
ETIM 4.0	EC000438
ETIM 5.0	EC000438
ETIM 6.0	EC000438

UNSPSC

UNSPSC 6.01	30211923
UNSPSC 7.0901	39121522
UNSPSC 11	39121522
UNSPSC 12.01	39121522
UNSPSC 13.2	39121522

Approvals

Approvals

Approvals

EAC

Ex Approvals

Approval details

EAC		B.01742
-----	--	---------

Accessories

Accessories

Panel mounting frame

RJ45 socket insert - VS-08-BU-RJ45/LP-1 - 1688586

Accessories

Panel mounting frames - VS-08-A-RJ45/LP-1-IP 20 - 1688641



RJ45 panel mounting frame, 1x, IP20, for PCB assembly, for socket inserts, without mounting screws

Panel mounting frames - VS-08-A-RJ45/LP-1-IP67 - 1689446



RJ45 panel mounting frame, IP67, for PCB connection, for square panel cutout, with grommet, without mounting screws, color: gray

Panel mounting frames - VS-08-A-RJ45/LP-1-IP67-BK - 1658655



RJ45 panel mounting frame, IP67, for PCB connection, for square panel cutout, with grommet, without mounting screws, color: black

Panel mounting frames - VS-08-A-S-RJ45/LP-1-IP67 - 1652884



RJ45 panel mounting frame, IP67, irradiated for welding applications, for PCB connection, for square panel cutout, with grommet, without mounting screws
