

Flush-type connector - SACC-E-M8FS-8CON-M10/0,5 - 1424231

Please be informed that the data shown in this PDF Document is generated from our Online Catalog. Please find the complete data in the user's documentation. Our General Terms of Use for Downloads are valid (<http://phoenixcontact.com/download>)



Sensor/actuator flush-type socket, 8-pos., M8, front/screw mounting with M10 fastening thread, with 0.5 m TPE litz wire, 8 x 0.14 mm²

Why buy this product

- Pre-assembled with litz wires for immediate use
- Customer-specific assemblies and litz wire lengths available
- Sealed on the litz wire side for optimum leak-tightness
- Standard pin assignments and codings for signal transmission with a uniform design-in design

Key Commercial Data

| | |
|--------------------------------------|---------------|
| Packing unit | 1 STK |
| GTIN | |
| GTIN | 4046356712439 |
| Weight per Piece (excluding packing) | 16.500 g |
| Custom tariff number | 85366990 |
| Country of origin | Germany |

Technical data

Dimensions

| | |
|-----------------|-------|
| Length of cable | 0.5 m |
|-----------------|-------|

Ambient conditions

| | |
|---------------------------------|------------------|
| Ambient temperature (operation) | -25 °C ... 85 °C |
| Degree of protection | IP67 |

General

| | |
|-----------------------|---------|
| Rated current at 40°C | 1.5 A |
| Rated voltage | 30 V AC |
| | 30 V DC |

Flush-type connector - SACC-E-M8FS-8CON-M10/0,5 - 1424231

Technical data

General

| | |
|-----------------------|------------------------------|
| Number of positions | 8 |
| Insulation resistance | ≥ 100 MΩ |
| Coding | A - standard |
| Standards/regulations | M8 connector IEC 61076-2-104 |
| Status display | No |
| Overvoltage category | II |
| Degree of pollution | 3 |
| Connection method | Individual wires |
| Mounting type | Front mounting M10 |

Material

| | |
|--|------------------------------|
| Flammability rating according to UL 94 | HB |
| Contact material | Cu alloy |
| Contact surface material | Au |
| Contact carrier material | PA 66 |
| Material, knurls | Zinc die-cast, nickel-plated |

Cable

| | |
|---------------------------------|--|
| Cable type | PVC litz wire |
| AWG signal line | 26 |
| Wire colors | white, brown, green, yellow, gray, pink, blue, red |
| Conductor material | Tin-plated Cu litz wires |
| Standards/specifications | M8 connector IEC 61076-2-104 |
| Ambient temperature (operation) | -25 °C ... 85 °C (cable, fixed installation) |

Standards and Regulations

| | |
|--|-----------------|
| Standard designation | M8 connector |
| Standards/regulations | IEC 61076-2-104 |
| Flammability rating according to UL 94 | HB |

Environmental Product Compliance

| | |
|------------|---|
| China RoHS | Environmentally Friendly Use Period = 50 |
| | For details about hazardous substances go to tab "Downloads", Category "Manufacturer's declaration" |

Drawings

Flush-type connector - SACC-E-M8FS-8CON-M10/0,5 - 1424231

Dimensional drawing

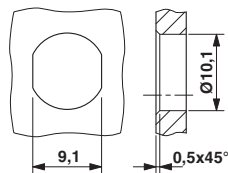

Schematic diagram

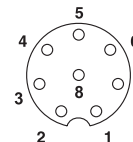

M8 plug pin assignment, 8-pos., view of pin side

Mounting panel with feed-through hole

Dimensional drawing

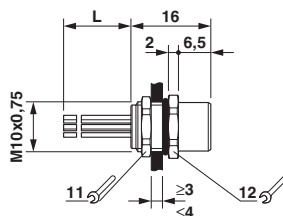

M8 flush-type socket

Classifications

eCl@ss

| | |
|------------|----------|
| eCl@ss 4.0 | 27250313 |
| eCl@ss 4.1 | 27250313 |
| eCl@ss 5.0 | 27143423 |
| eCl@ss 5.1 | 27143423 |
| eCl@ss 6.0 | 27143423 |
| eCl@ss 7.0 | 27449001 |
| eCl@ss 8.0 | 27440103 |
| eCl@ss 9.0 | 27440102 |

ETIM

| | |
|----------|----------|
| ETIM 3.0 | EC002061 |
| ETIM 4.0 | EC002635 |
| ETIM 5.0 | EC002061 |
| ETIM 6.0 | EC002061 |

UNSPSC

| | |
|---------------|----------|
| UNSPSC 6.01 | 31251501 |
| UNSPSC 7.0901 | 31251501 |
| UNSPSC 11 | 31251501 |
| UNSPSC 12.01 | 31251501 |
| UNSPSC 13.2 | 39121413 |

Flush-type connector - SACC-E-M8FS-8CON-M10/0,5 - 1424231

Approvals

Approvals

Approvals

EAC

Ex Approvals

Approval details

| | | |
|-----|---|---------|
| EAC |  | B.01742 |
|-----|---|---------|
