



Product Change Notification (PCN)

PCN Number	502824	Date Issued	June 29, 2017
Reason for Change	Change to Product		
Change Type Description	This letter is to inform you that changes are being made to the part(s) identified in this Notice. The change may affect the fit, form, function or appearance of the parts, or it may result in a change to the specification. The pictures below show an example of the possible differences.		
Assessment of Change	Product will be fully qualified before it is shipped. Qualification reports are available upon request.		
Internal Molex Qualification Date	September 05, 2017		
Sample Availability Date (Changed Part)	September 05, 2017		
Planned Implementation Date	January 01, 2018		
Method of Identifying Change	New part number		

RELEASED

Before Change

Product Impact

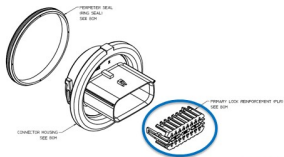

Current TPA

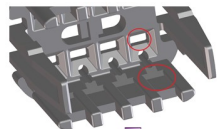

Improved TPA

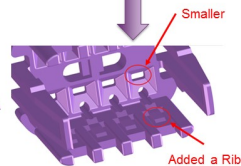

After Change

Overview

- Molex is modifying the MX150 Twist Lock TPA to minimize the blade tip movement
- Product impact
 - TPA hole size reduction & added rib to TPA stub
- Part number impact
 - Current 34840-30xx will be **obsolete**, replaced by 34840-34xx
 - Current 34840-40xx will be **obsolete**, replaced by 34840-44xx
 - Current 34840-60xx will be **obsolete**, replaced by 34840-64xx
 - Current 34840-80xx will be **obsolete**, replaced by 34840-84xx
 - **Current part numbers will be obsolete after Implementation Date**
- PPAP and samples available upon request
- Last time buy date is lead time before Implementation Date
- Last time ship date subject to change due to various methods of transit and stock availability in supply chain hubs



Product Change Notification (PCN)

You may address any technical inquiries regarding this PCN by sending E-mail to pcn_coordinator@molex.com or your Local Sales Engineer.

Note: While responding, please retain "**PCN Notification:502824**" in the e-mail Subject line for faster response.

RELEASED

Molex, LLC
2222 Wellington Court
Lisle, IL 60532
TEL: 630-969-4747
www.molex.com