

## STAKAP 2 grau/grey

Industrial Connectors:Rectangular connectors ST-series:Surface mounted socket

### Product description

Description	Surface mounted socket with cast baseplate
Type	STAKAP 2 grau/grey
Order No.	930 329-106
Type of contact	female
Number of contacts	2 + PE
Conductor size	max. 1.5 mm <sup>2</sup>
Housing Color	grey
Contact bearer color	black

### Drawing

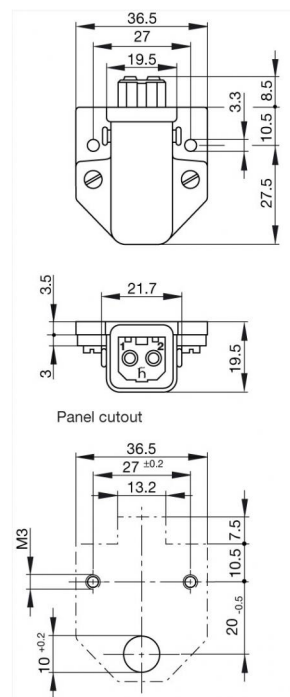

### Technical data

Pin dimensions	2 mm
Rated voltage	AC/DC 250 V
Rated current	DC 10 A / AC 16 A
Contact resistance	≤ 5 mOhm
Type of termination	screws

### Material

Contact material	Cu Zn
Contact surface material	Sn
Contact bearer material	PA

Housing material	PA
<b>Environmental conditions</b>	
Protection class (IEC 60529)	IP 54
Pollution severity	3
Temperature range	-30 °C to +90 °C
<b>Inflammability class</b>	
Housing	UL 94 HB
Contact bearer	UL 94 V-0
<b>Approvals</b>	
UL	UL
<b>Packing unit</b>	
Packaging unit	100 pieces
<b>Scope of delivery and accessories</b>	
Accessories to order separately	safety brackets STASI 2, order no. 732 044-000