

Ceramic, GoldMax, 2200 pF, 10%, 50 V, X7R, GoldMax, Commercial Standard, Lead Spacing = 5.08mm

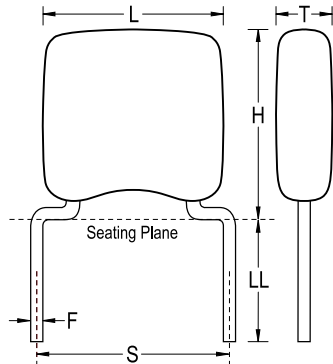

Dimensions

| | |
|----|----------------------|
| L | 5.08mm MAX |
| H | 6.6mm MAX |
| T | 3.18mm MAX |
| S | 5.08mm +/-0.78mm |
| LL | 7mm MIN |
| F | 0.51mm +0.1/-0.025mm |

Packaging Specifications

| | |
|---------------------|-----------|
| Packaging: | Bulk, Bag |
| Packaging Quantity: | 500 |

General Information

| | |
|---------------|------------------------------|
| Style: | Radial |
| Series: | GoldMax |
| Description: | GoldMax, Commercial Standard |
| RoHS: | Yes |
| Termination: | Tin |
| Failure Rate: | N/A |
| Halogen Free: | Yes |

Specifications

| | |
|----------------------------------|---------------------|
| Capacitance: | 2200 pF |
| Capacitance Tolerance: | 10% |
| Voltage DC: | 50 VDC |
| Dielectric Withstanding Voltage: | 125 V |
| Temperature Range: | -55/+125C |
| Temperature Coefficient: | X7R |
| Dissipation Factor: | 2.5% 25C |
| Aging Rate: | 3% Loss/Decade Hour |
| Insulation Resistance: | 100 GOhms |