

Device connector, front mounting - SH-8EPC58AWA00S - 1621569

Please be informed that the data shown in this PDF Document is generated from our Online Catalog. Please find the complete data in the user's documentation. Our General Terms of Use for Downloads are valid (<http://phoenixcontact.com/download>)



Device connector for front wall, straight, shielded: yes, Screw locking, M23, Number of positions: 4+4+4+PE, Type of contact: Male connector, Crimp connection, Axial O-ring, 4x Ø 3.2, Flange dimensions: 26 mm x 26 mm

Why buy this product

- Transmission of signals, data, and power in just a single connector
- CAT5 data interface
- Safe use in the field, thanks to high degree of protection
- Consistent EMC protection for reliable connection solutions in the industrial environment

Key Commercial Data

| | |
|--------------------------------------|--------------------------------|
| Packing unit | 1 STK |
| GTIN | |
| GTIN | 4046356937177 |
| Weight per Piece (excluding packing) | 50.500 g |
| Custom tariff number | 85366990 |
| Country of origin | Germany |
| Note | Made to Order (non-returnable) |

Technical data

Temperature range

| | |
|---------------------------------|-------------------|
| Ambient temperature (operation) | -40 °C ... 130 °C |
|---------------------------------|-------------------|

Data of the insulating body

| | |
|--|--|
| Note | Order information: Crimp contacts, 4x Ø 0.8 mm, 4x Ø 1 mm, 5x Ø 2 mm, order separately |
| Coding | N |
| Insulator material | Polyamide (PA 6.6) |
| Insertion/withdrawal cycles mechanical | 100 |
| Contact connection method | Crimp connection |

Device connector, front mounting - SH-8EPC58AWA00S - 1621569

Technical data

Data of the insulating body

| | |
|---|----------------------|
| Type of contacts | Male connector |
| Number of positions | 13 |
| Contact diameter of power contacts | 2 mm |
| Litz wire cross section of power contacts min. | 0.25 mm ² |
| Litz wire cross section of power contacts max. | 4 mm ² |
| Nominal current per power contact at 25°C | 30 A |
| Nominal voltage, power contact | 630 V AC |
| | 850 V DC |
| Rated surge voltage | 6 kV |
| Contact diameter of signal contacts | 1 mm |
| Litz wire cross section of signal contacts min. | 0.06 mm ² |
| Litz wire cross section of signal contacts max. | 1 mm ² |
| Nominal current per signal contact at 25°C | 8 A |
| Nominal voltage, signal contact | 50 V |
| Rated surge voltage | 1.5 kV |
| Contact diameter, data contacts | 0.8 mm |
| Litz wire cross section, data contacts, min. | 0.08 mm ² |
| Litz wire cross section, data contacts, max. | 0.5 mm ² |
| Nominal current per data contact at 25°C | 3.6 A |
| Nominal voltage of data contact | 50 V |
| Rated surge voltage | 1.5 kV |
| Overvoltage category | III |
| Degree of pollution | 3 |

Housing data

| | |
|--|--|
| Housing material | Turned parts: copper zinc alloy (CuZn), die-cast parts: zinc (GD-Zn) |
| Flange dimensions | 26 mm x 26 mm |
| Type of locking | Screw locking |
| Degree of protection (when plugged in) | IP67 |
| | IP68 |
| Thread type | M23 |

Environmental Product Compliance

| | |
|------------|---|
| China RoHS | Environmentally Friendly Use Period = 50 |
| | For details about hazardous substances go to tab "Downloads", Category "Manufacturer's declaration" |

Drawings

Device connector, front mounting - SH-8EPC58AWA00S - 1621569

Schematic diagram

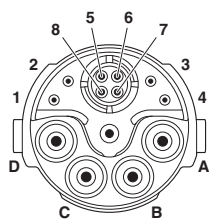

Dimensional drawing

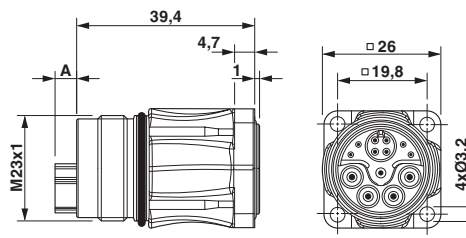

Pin assignment of pin, CAT5

Pin version: dimension A = 4.75 mm, socket version: dimension A = 0 mm

Dimensional drawing

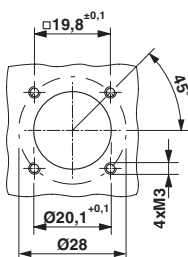

Installation dimensions

Classifications

eCl@ss

| | |
|------------|----------|
| eCl@ss 4.0 | 272607xx |
| eCl@ss 4.1 | 27260701 |
| eCl@ss 5.0 | 27143424 |
| eCl@ss 5.1 | 27143424 |
| eCl@ss 6.0 | 27143424 |
| eCl@ss 7.0 | 27440209 |
| eCl@ss 8.0 | 27440102 |
| eCl@ss 9.0 | 27440103 |

ETIM

| | |
|----------|----------|
| ETIM 4.0 | EC002635 |
| ETIM 5.0 | EC002635 |
| ETIM 6.0 | EC002635 |

UNSPSC

| | |
|-------------|----------|
| UNSPSC 13.2 | 39121413 |
|-------------|----------|

Approvals

Approvals

Device connector, front mounting - SH-8EPC58AWA00S - 1621569

Approvals

Approvals

cULus Recognized / EAC

Ex Approvals

Approval details

| | | |
|--------------------------------|-------|--|
| cULus Recognized | | http://database.ul.com/cgi-bin/XYV/template/LISEXT/1FRAME/index.htm E468743-20150928 |
| Nominal current I _N | 16 A | |
| Nominal voltage U _N | 600 V | |

| | | |
|-----|--|---------|
| EAC | | B.01742 |
|-----|--|---------|

Accessories

Accessories

Crimp contact

Crimp contact - ST-10KP010 - 1618255



Crimp contact, turned, Single contact, Contact diameter: 1 mm, Crimp range: 0.06 mm²...0.25 mm²

Crimp contact - ST-10KP020 - 1618256



Crimp contact, turned, Single contact, Contact diameter: 1 mm, Crimp range: 0.34 mm²...0.5 mm²

Device connector, front mounting - SH-8EPC58AWA00S - 1621569

Accessories

Crimp contact - ST-10KP030 - 1618261



Crimp contact, turned, Single contact, Contact diameter: 1 mm, Crimp range: 0.5 mm²...1 mm²

Crimp contact - SF-20KP021 - 1621579



Crimp contact, turned, Contact diameter: 2 mm, Crimp range: 0.25 mm²...1 mm²

Crimp contact - SF-20KP022 - 1621580



Crimp contact, turned, Contact diameter: 2 mm, Crimp range: 1.5 mm²...2.5 mm²

Crimp contact - SF-20KP023 - 1621581



Crimp contact, turned, Contact diameter: 2 mm, Crimp range: 2.5 mm²...4 mm²

Crimp contact - SF-08KP010 - 1621574



Crimp contact, turned, Contact diameter: 0.8 mm, Crimp range: 0.08 mm²...0.25 mm²

Device connector, front mounting - SH-8EPC58AWA00S - 1621569

Accessories

Crimp contact - SF-08KP020 - 1621575



Crimp contact, turned, Contact diameter: 0.8 mm, Crimp range: 0.34 mm²...0.5 mm²

Mounting material

Color-coding - RF-Z0017 - 1620624



Color-coding, Color: green

Color-coding - RF-Z0018 - 1620625



Color-coding, Color: orange

Color-coding - RF-Z0019 - 1620626



Color-coding, Color: black

Protective cover

Metal dust protection cap - SH-Z2302 - 1622139



Metal dust protection cap with steel wire for M23 hybrid connectors with external thread

Device connector, front mounting - SH-8EPC58AWA00S - 1621569

Accessories

Plastic dust protection cap - SH-Z2304 - 1622137



Plastic dust protection cap for M23 hybrid connectors with external thread

Metal dust protection cap - SH-Z2303 - 1622138



Metal dust protection cap for M23 hybrid connectors with external thread

Sample set - M23 HYBRID_CONTACT-SAMPLE-SET - 1623252

Sample set consisting of 4 x Ø 1.0 mm, 4 x Ø 0.8 mm, 5 x Ø 2.0 mm for all socket and pin contacts for M23 hybrid connectors. Contacts included: 1621573, 1618254, 1621577, 1621575, 1618261, 1621580
