

MCV™ Series 59 & 6

U.S. Patent #: 7,112,093
7,264,502
6,929,508

Universal Compression Connectors

Holland Electronic's new universal compression connectors were created with the Commercial AV Installers' needs in mind. This series consists of five Universal Connectors that terminate most major brands of cable, including Plenum RG-6, RG-6, RG-59, Mini-23 AWG and Mini 25 AWG cables.

Features:

- **One Universal Connector for each Series of Cable (Including Plenum)**
- **Easy Insertion**
- **All Metal Construction**
- **Optimized for Digital Video Applications**
- **Patented Viewing Window**
- **Accommodates Color-Coded Application Bands (P/N: SRR)**

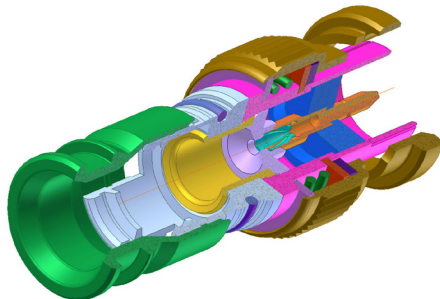

FITS MOST MAJOR COAXIAL CABLE BRANDS - Plenum RG-6, RG-6, RG-59, Mini 23 & Mini 25 - Our new *MCV Universal Compression Connectors* fit a wide variety of coaxial cables that vary in size between manufacturers. Some differences often include thickness of jacket or diameter of insulation depending on variance in materials used in the cable manufacturing process.



AVAILABLE IN BNC, RCA AND F

| Frequency Range | DC - 3,000 MHz | |
|---|-------------------|-----------------|
| Return Loss (1 GHz) | > -27dB | |
| Return Loss (3 GHz) | > -21dB | |
| Insertion Loss (1 GHz) | < .15 dB Max | |
| (The above test results from BNC6-MCVL) | | |
| | Jacket O.D. Range | Pull Force |
| RG59 MCV | 5.8 - 6.1 | 55 lbs. typical |
| RG6 MCV | 5.9 - 6.9 | 70 lbs. typical |
| RG6 MCVL | 6.6 - 7.4 | 70 lbs. typical |
| SLC1855-FPU | 3.7 - 4.1 | 40 lbs. typical |
| SLC-MINI25U | 2.7 - 2.9 | 30 lbs. typical |

WORKS WITH MOST COMPRESSION TOOLS



| | |
|------------|------------|
| Cable Prep | MCT |
| Cable Prep | HPT-6590 |
| Liberty | CM-TOOL |
| Cable Pro | CPLCCT-SLM |
| Holland | CT-FBR |

RG-6 & RG-59 - Fits all standard 21MM Compression Tools
Mini 23 & 25 AWG - Fits all standard 29.8MM Compression Tools

COMPATIBLE COAXIAL CABLE

| Connector Series → | 59-MCV | 6-MCV | 6-MCVL | 23 AWG | 25 AWG |
|--------------------|----------|--------|---------|---------|------------|
| Sheerwire Brand | SVHD59P | SVCA6P | SVCA6QP | SVHD23P | SV253SP |
| Gepco Brand | SVHD59R | SVCA6R | SVCA6QR | SVHD23R | SV253SR |
| | SVCC59P | 495025 | SVHD6P | VS5230 | SV254SP |
| | SVCC59R | C5820 | SVHD6R | | SV254SR |
| | SV59222P | | SVRG63R | | SV255SP |
| | SV59222R | | SVRG64R | | SV255SR |
| | SV59182P | | SVRG65R | | SV256SR |
| | SV59182R | | SVRG66R | | RGB250S |
| | 495023 | | SVCC6P | | RGBS250S |
| | C5782 | | SVCC6R | | RGBSC250S |
| | | | C5812 | | RGBHVC250S |
| | | | C5785 | | |

MCV - COMPATIBLE COAXIAL CABLE

| Outside Diameter --> | 5.8 - 6.1 | 5.9 - 6.9 | 6.6 - 7.4 | 3.7 - 4.1 | 2.7 - 2.9 |
|--------------------------|---------------|--------------|---------------|---------------|---------------|
| Connector Series | 59-MCV | 6-MCV | 6-MCVL | 23 AWG | 25 AWG |
| Sheerwire Brand | SVHD59P | SVCA6P | SVCA6QP | SVHD23P | SV253SP |
| | SVHD59R | SVCA6R | SVCA6QR | SVHD23R | SV253SR |
| | SVCC59P | | SVHD6P | | SV254SP |
| | SVCC59R | | SVHD6R | | SV254SR |
| | SV59222P | | SVRG63R | | SV255SP |
| | SV59222R | | SVRG64R | | SV255SR |
| | SV59182P | | SVRG65R | | SV256SR |
| | SV59182R | | SVRG66R | | |
| | | | SVCC6P | | |
| | | | SVCC6R | | |
| Gepco Brand | 495023 | 495025 | C5812 | VS5230 | RGB250S |
| | C5782 | C5820 | C5785 | | RGBS250S |
| | | | 1152A | | RGBSC250S |
| | | | | | RGBHVC250S |
| Belden | 549945 | 1829R/9116 | 1829R/9116 | 1855A | 1277P-R |
| | 543945 | 533945 | 533945 | 1855P | 1278P-R |
| | 1505A | 1189AP | 1189AP | | 1278R |
| | 8241A | 9116 | 9116 | | 1279P-R |
| | 1151A | 1306B | 1306B | | 1280P-R |
| | 9100 | 1258AM | 1258AM | | 1281R-S3 |
| | 9104 | 1530A | 1530A | | 1281R-S4 |
| | 9275 | 1532A | 1532A | | 1281R-S5 |
| | 9104N | 1532AM | 1532AM | | 1281R-S6 |
| | 9555 | 539945 | 539945 | | HC2648R |
| | 8241 | 1152A | 1152A | | HC2650R |
| | 9274 | | 1260AM | | 1280R |
| | 9105M | | 1360SB | | 1164B |
| | 9204 | | | | 1167B |
| | 9240 | | | | 1418B |
| | 9259 | | | | |
| | 9209A | | | | |
| | 8212 | | | | |
| | 8221 | | | | |
| | 8263 | | | | |
| | 9110 | | | | |
| | 9167 | | | | |
| | 9224 | | | | |
| | 9244 | | | | |
| | 9659 | | | | |
| | 1426A | | | | |
| | 1505F | | | | |
| | 8241B | | | | |
| | 8241F | | | | |
| | 1186A | | | | |
| | 88281 | | | | |
| Honeywell/Genesis | 5013 | 5012 | 5012 | 5022* | |
| | 5035 | 5038 | 5038 | 5019 | |
| | 5001 | 5038 | 5038 | 5020 | |
| | 5009 | 5302 | 5302 | 5029 | |
| | 5013 | | | 5098 | |
| | 5103 | | | 5099 | |
| | 5104 | | | | |
| | 5301 | | | | |
| | 5351 | | | | |
| | 5355 | | | | |

MCV - COMPATIBLE COAXIAL CABLE

| Outside Diameter --> | 5.8 - 6.1 | 5.9 - 6.9 | 6.6 - 7.4 | 3.7 - 4.1 | 2.7 - 2.9 |
|-------------------------|--------------|------------|-------------------|--------------|-------------|
| Connector Series | 59-MCV | 6-MCV | 6-MCVL | 23 AWG | 25 AWG |
| Liberty | 20-CMR-VIDEO | 18-CMP-VID | RG6-QUAD-CATV-WHT | 23-YCLLSIAM | AVC-6-PLN* |
| | 20-CMP-VID | RG6-P-CATV | RG6-CM | RGB-SOL-MINI | AVC14-PLN* |
| | RG59-CATV-PL | | RG6-QUAD | | AVC18-PLN* |
| | RG59-CCTV | | QUADFLEX | | RGB5C-PLN* |
| | RG59-18-2C | | 18-CMR | | RGB5C-25CMP |
| | ELAN-CM-VIA | | RG6-QUAD-PL | | |
| | RG59-CCTV-PL | | RG6-CCTV-PVC | | |
| | | | | | |
| | | | | | |
| Tappan | C30022 | C40009 | C40009 | C90032 | H91925 |
| | C30114 | C40055 | C40055 | D90033 | H91946 |
| | H90369 | C40055 | C40055 | | H91924 |
| | H91319 | C40076 | C40076 | | H91930 |
| | | D40019 | D40019 | | |
| | | H90454 | H90454 | | |
| | | H90767 | H90767 | | |
| | | H915578 | H915578 | | |
| | | H91569 | H91569 | | |
| | | SU4008 | SU4008 | | |
| | | SU4020 | SU4020 | | |
| Commscope | 2020K-V | | | 7538 | |
| | 2036K-V | | | 7538-B | |
| | 5550 | | | | |
| | 5553 | | | | |
| | 5554 | | | | |
| | 2054V | | | | |
| West Penn Cross | 815R | 6100 | 6100 | 825* | WP258255 |
| | 819 | 6100 | 6100 | 2825 | WP258263 |
| | 2815B | 6150 | 6150 | HD825 | WP258265 |
| | 804 | 25Q841 | 25Q841 | 25825 | 253CRGB |
| | 814 | 2806B | 2806B | HD25825 | 255CRGB |
| | 815 | 806R | 806R | WP8253* | 3CRGB |
| | 819 | AQC841 | AQC841 | WP8255* | 5CRGB |
| | 2814 | | | 45825 | 252825 |
| | AQC815 | | | | |
| Coleman / Signal | 99979 | 92003 | 92003 | 99401 | |
| | 92004 | 92003 | 92003 | 99403 | |
| | 92074 | | | 99405 | |
| | 991055 | | | 99415 | |
| | 991057 | | | 99425 | |
| | 993251 | | | 99426 | |
| | 339253 | | | 993211 | |
| | 993236 | | | | |