

Splitport™ Scoop Plate

- Contractor size Splitport™ Scoop is larger than a standard wall plate to cover irregular sheet rock cut outs and damage around the low voltage box.
- Saves installation time since the cables can be run and the plate installed after.
- When the mating half is assembled virtually no hole can be seen from the viewers angle.
- Allows easier cable handling for cable runs that loop back over the scoop.
- The circular design of the plate hole is less obtrusive than other cable recess pass through plates
- The Splitport™ Scoop plate is designed with patented keyed-tab locking feature that holds the wall plate together to withstand pulling and pushing of cables as the installer organizes them.
- By installing one plate half at a time, the cables can be pushed out of the way and allow direct access with the wall plate screw to secure the plate. This unique patented design eliminates having to pass each cable through the wall plate hole, disconnect each cable that is already installed, and use oversized hole plates just to fit large connector ends through.
- They are designed to mount directly to standard low voltage mounting brackets and backless boxes.
- By eliminating the connectors at the wall, the installer reduces labor and material costs and improves signal integrity thereby making your installations more competitive and reliable.
- Splitport™ Scoop plates are perfect for both wall and ceiling installations for audio, video, security, and office networking.
- They are sold individually or in master packs of 25 and are available in industry standard colors of White, Light Almond, Ivory, and Black.



White



Light Almond



Ivory



Black

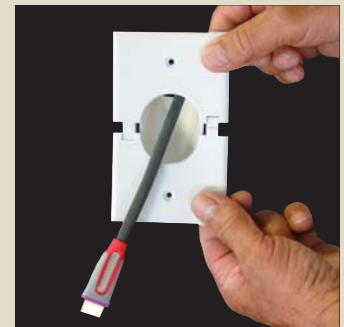

Part No. Description

1-Gang Splitport™ Scoop Plate

Part No.	Description	Hole Size (Diameter)	Hole Area (in. ²)
1GSSWH	1-gang White Splitport™ Scoop Plate, w/screw hardware	1.5"	1.76"
1GSSLA	1-gang Light Almond Splitport™ Scoop Plate, w/screw hardware	1.5"	1.76"
1GSSIV	1-gang Ivory Splitport™ Scoop Plate, w/screw hardware	1.5"	1.76"
1GSSBK	1-gang Black Splitport™ Scoop Plate, w/screw hardware	1.5"	1.76"

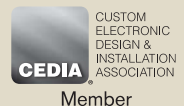

Splitport™ is a Trademark of MIDLITE®

Patented and Multiple Patents Pending

www.midlite.com

Warehouse: 866 Warren Street, Fall River, MA 02721

Office Mail: PO Box 70189, No. Dartmouth, MA 02747

tel 508.676.5169 / toll free 800.606.5169 / fax 508.861.0105

