

Data Sheet

RT033xxHBLU

Page 1/5

P/N

313591xx

xx=number of poles

2017/01/24

Illustration

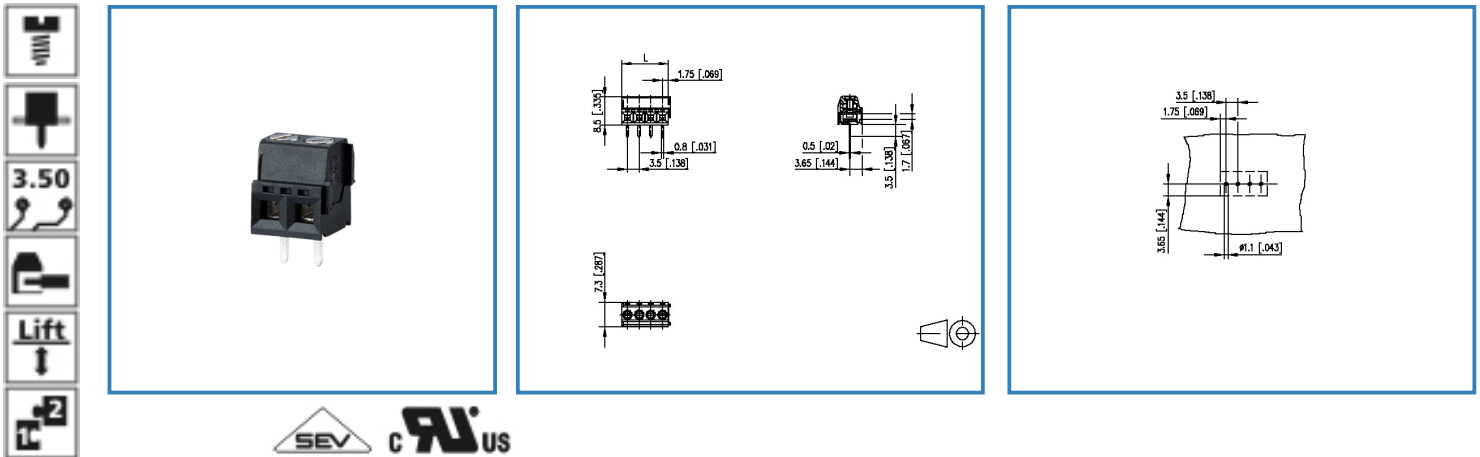

see enlarged drawing at the end of the document

Product specification

- screw type terminal block, solderable
- centerline 3.50 mm, direction of connection 90°
- lift system, modular
- color black
- Tape & Reel packaging
- Max. recommended number of poles: 16

Data Sheet

RT033xxHBLU

Page 2/5

P/N

313591xx

xx=number of poles

2017/01/24

Technical Data



General Data

Tightening torque SEV	0.15 Nm		
Tightening torque UL	2.2 lb-in		
Solder pin length	3.5 mm		
min. number of poles	2		
max. number of poles	4		
Insulating material class	CTI 600		
clearance/creepage dist.	1.7 mm		
protection category	IP 00		
Overvoltage category	III	III	II
Pollution degree	3	2	2
Rated voltage	80 V	320 V	320 V
Rated test voltage	2.5 kV	2.5 kV	2.5 kV

Connection data

Rated wiring solid wire	0.2 - 1.5 mm ² / AWG 26 - 16
Rated wiring stranded wire	0.2 - 1.5 mm ² / AWG 26 - 16

Approvals

 V / A / AWG	150 / 10 / 28 - 16
 1.0 mm ²	130 V / 12 A / T60

Material

insulating material	PA66
flammability class	V0
contact material	CuZn
Glow-Wire Flammability GWFI	960
Glow-Wire Flammability GWIT	775
contact surface	Sn
terminal body material	CuZn
terminal body surface	Ni
screw surface	Zn Cr(VI)-frei/free
screw thread	M2

Climatic properties

upper limit temperature	125 °C
lower limit temperature	-40 °C

Data Sheet

RT033xxHBLU

Page 3/5

P/N

313591xx

xx=number of poles

2017/01/24

General

solderability	Acc. to JEDEC JESD22-B102E 245°C/5s
Tolerance	ISO 2768 -mH



Data Sheet

RT033xxHBLU

Page 4/5

P/N

313591xx

xx=number of poles

2017/01/24

Illustration

Drawing

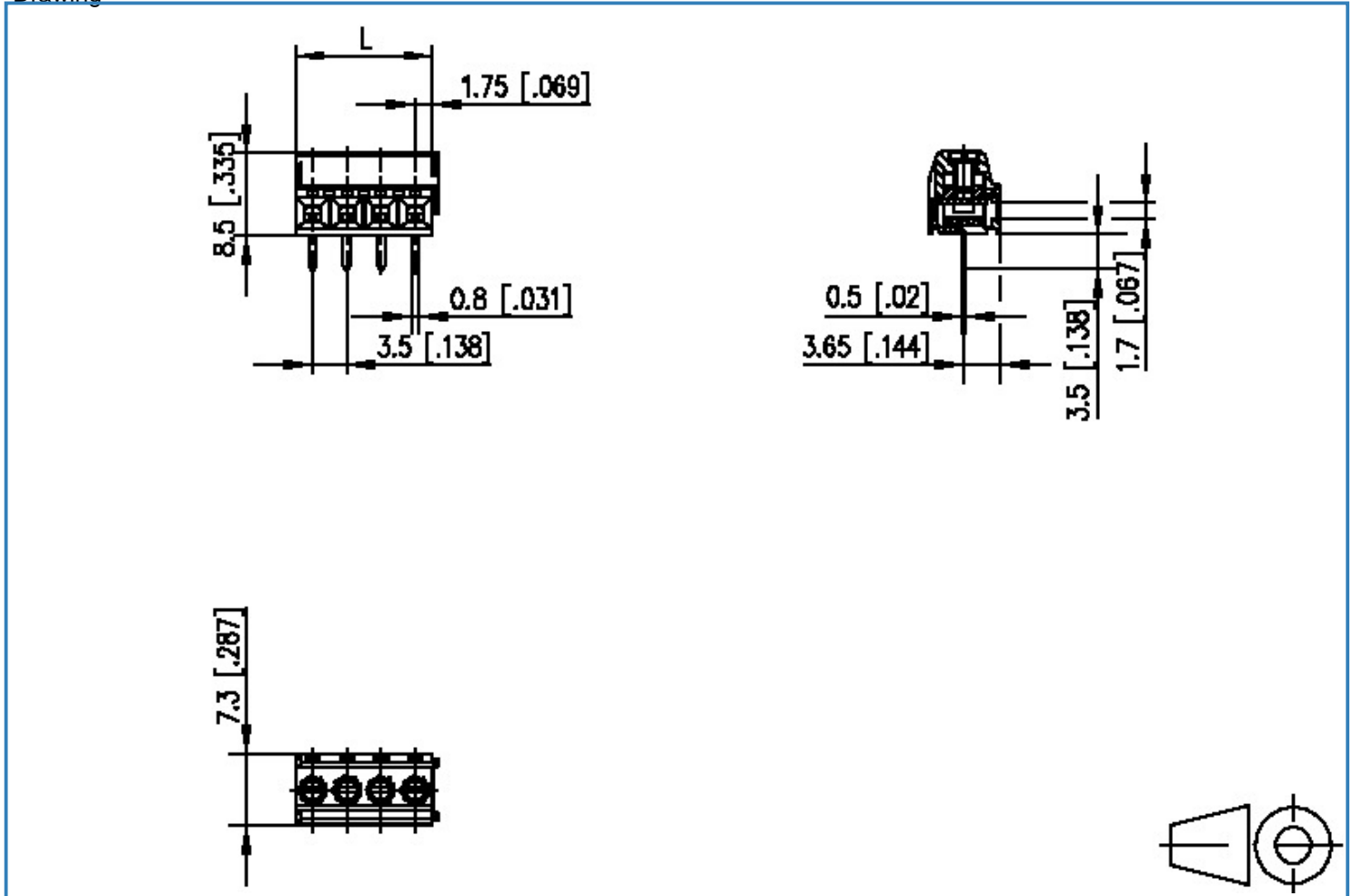

$L = (\text{pole size} - 1) \times \text{centerline} + 3.5 [0.138]$



Data Sheet

RT033xxHBLU

Page 5/5

P/N

313591xx

xx=number of poles

2017/01/24

PCB Layout

