

MAXVIEW

Est 1964



Installation & Operating Instructions



Precision Waterways

MXL024/55 - Single
MXL024/55TWIN - Twin

UK contact:

Helpline: +44 (0)1553 811000
Email: support@maxview.co.uk
Web: www.maxview.co.uk

Maxview reserve the right to change specifications without prior notice
MXL024INS Iss 1

Thank You...

...for purchasing this product, we trust that you will get many years of enjoyment from it.

Should you have any difficulty using your Precision please contact our friendly Customer Helpline on +44 (0)1553 811000.

Please retain these instructions for future reference.

Contents

- | | | | |
|------|--|--------|--|
| 2. | Pack Contents | 11. | Using Your Sat Finder |
| 3. | Tools Required & Dish Assembly | 12. | Satellite Azimuth Alignment Guide & Adjusting LNB Skew |
| 4. | Get To Know Your Precision Waterways Kit | | Skew Map & Elevation Map |
| 5. | Installing Your Precision Waterways Mount | 13. | Glossary Of Terms |
| 7. | Removing The Nylon Mount From the Base | 14. | Fault Finding |
| 7-8. | Setting Up the Precision Waterways | 15. | Accessories |
| 9. | Line Of Sight, Dish Removal & Dish Storage | 16-17. | Safety Warnings, Care & Maintenance, 2 Year Guarantee |
| 10. | Connecting Your Precision Waterways, Guidelines for Sky Satellite Reception & Signal Strength Meter On SKY Box | 18. | Notes |
| | | 19. | |

Pack contents



- A. Dish Assembly
B. Holdall
C. Compass

- D. Mount Pack
E. 10m Push Fit 'F' to
'F' Flexible Cable

Other equipment you will need to get started:

- > TV
- > Satellite Receiver OR TV with built in satellite tuner

Tools Required

- > Power Drill
- > Phillips Screwdriver
- > Weather Resistant Flexible Adhesive*
- > Adhesive Applicator Gun

- > Suitable drill bit
- > Surface Cleaning Equipment
- > Pen/Pencil

*Recommended by Maxview:
Sikaflex – 512 Caravan,
Geocel Geobond HM,
Sikaflex – 252

Dish Assembly

Before you use your Precision you will need to attach the dish to the bracket.

You will find the screws/washers required for fitting the dish already inserted in the bracket.

Remove these with a screwdriver taking note of the hole position you removed them from.

Offer the dish to bracket and re-insert screws/washers to the matching holes.
Firmly tighten screws against dish.

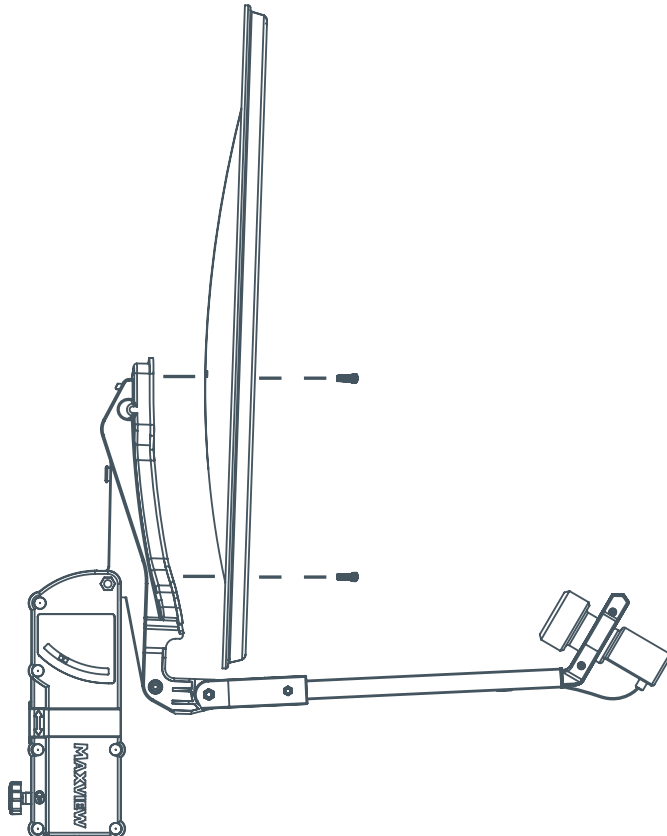

Get To Know Your Precision Waterways Kit

Note: Designed for stationary use only. Remove from mount when boat is moving.

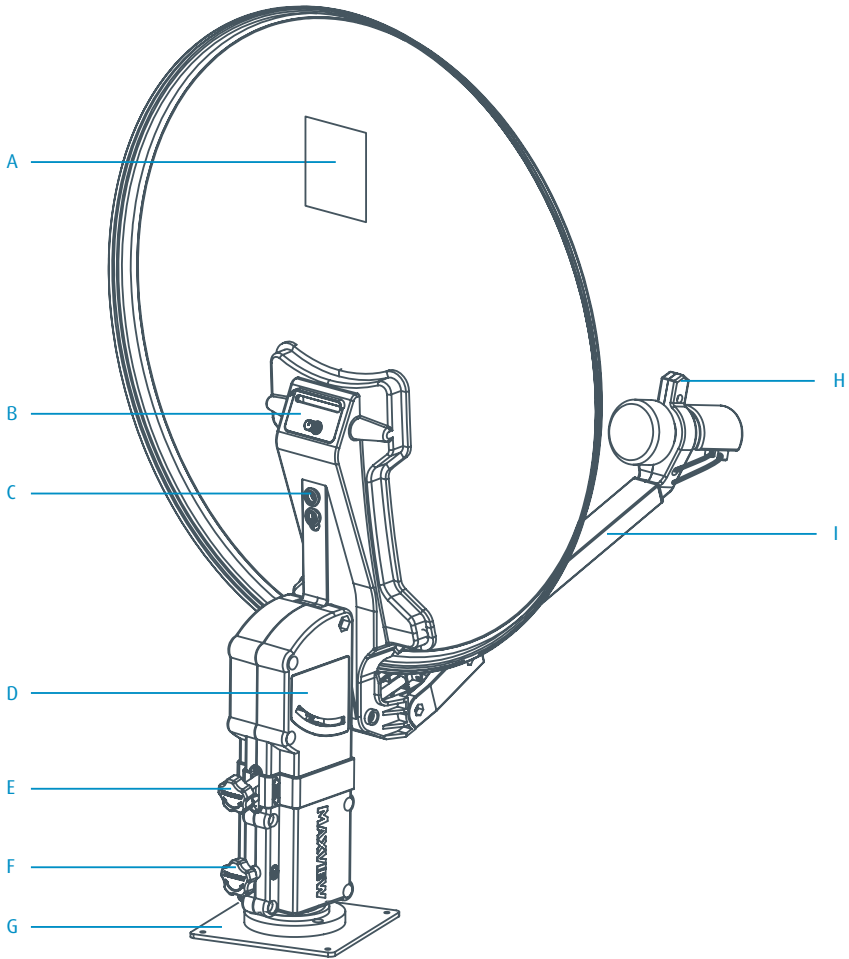

A. Elevation Map

Shows correct elevation for your area

B. Integrated Sat Finder

To help you align your satellite dish to the satellite

C. Coaxial Cable Ports

Easy access ports to attach your coaxial cable

D. Elevation Indicator

Easy to view elevation angle read out

E. Elevation Adjustment Knob

Turn to adjust elevation angle

F. Azimuth Lock

To lock off system in correct position once satellite has been located

G. Waterways Mount Assembly

Fixes to a boat roof for quick set up

H. Magnetic Arm Lock

To secure the LNB arm in a closed position

I. Folding LNB Arm

For compact storage of the system

Installing Your Precision Waterways Mount

1. Locating your mount

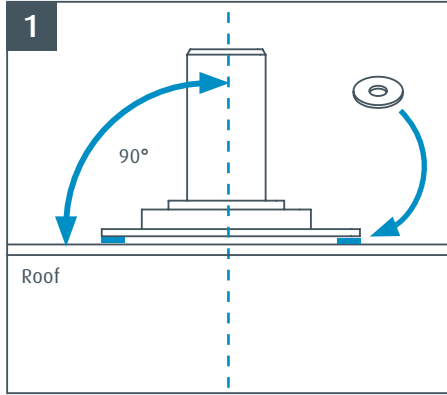

We strongly recommend mounting on the centre line of your boat. For correct performance, the nylon mount must be vertical.

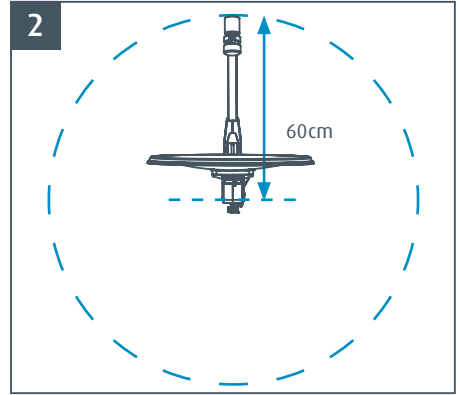

The mount should be in a location where a full 360° rotation can be achieved without any obstruction.

2. Fixing in place

The mount plate is designed to be used on flat roofs or shallow curves. Always use at least 1 washer in each corner, to allow clearance for plate fixings. If your roof has a more aggressive curve or cannot be mounted centrally refer to section 2B.

Please Note: When installing with a flexible adhesive it is not necessary to use mechanical fixings, however do not travel until adhesive has cured. Refer to adhesive manufacturers guidelines for curing times etc.

2A. Fixing to a flat roof

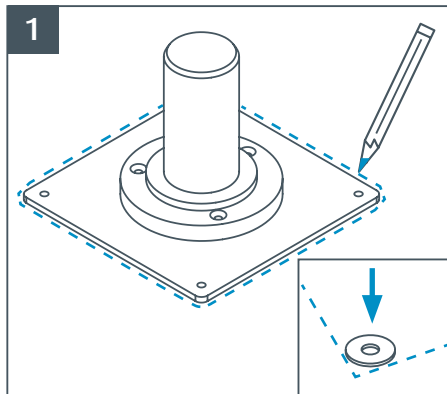

Mark out position of mount on roof and place at least 1 washer into each corner of marked out area.

Please Note: Washers must be used to allow clearance for plate fixings

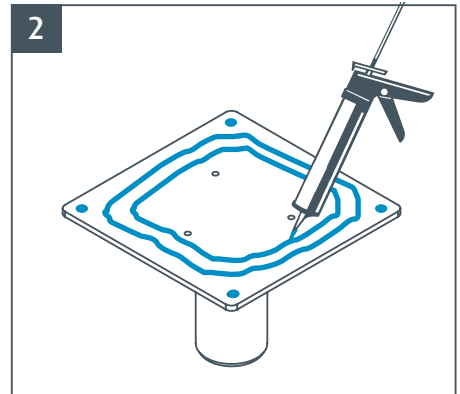

We recommend using a flexible adhesive for all installations.

- See 'Tools Required' section for further details on recommended sealants.
- Clean roof in accordance with adhesive manufacturers guidelines.
- Apply Sealant under plate and a small amount in each hole.

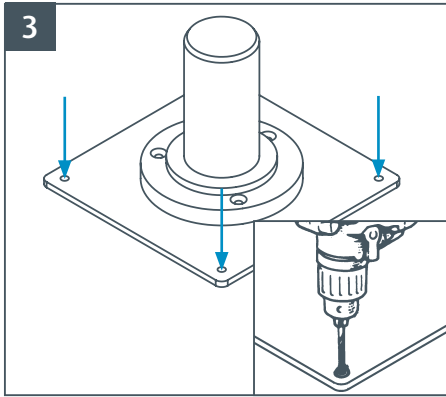

Using mechanical fixings (recommended if travelling before flexible adhesive has properly cured).

- a. Mark out pilot holes.
- b. Drill with suitable drill bit.
- c. Use self-tapping screws (use screws provided or source own) to secure plate to surface.

2B. Fixing To A Curved Roof

Diagrams show examples of curved roofs. Washers have been supplied to suit this application.

Important Note:

Ensure that your mount is always pointing upright.

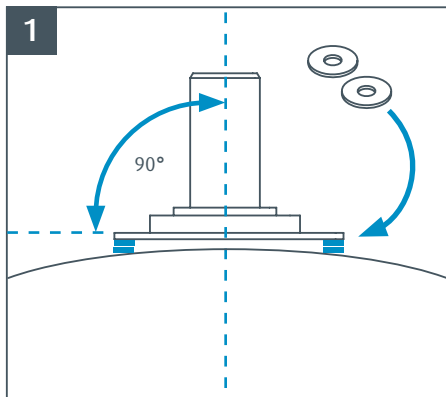

Use the washers provided to pack out any minor curves.

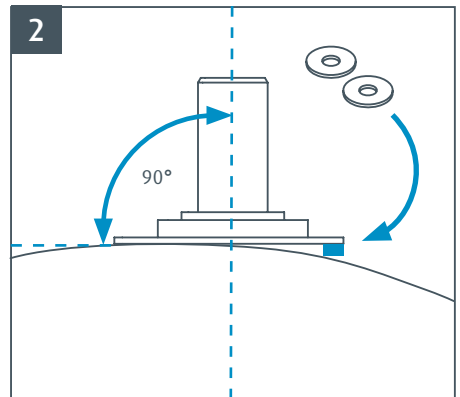

If mounting on the side of a curve:

- a. Use washers provided to pack out curve as necessary
- b. Or create own bespoke fixing arrangement

Removing The Nylon Mount From The Base

If you find the mount obtrusive, then Nylon part has been designed for easy removal from the metal plate.

Remove the 3 Screws* holding the two parts together as highlighted in the image above. This will free the Nylon mount from the plate.

* Please do not over tighten the screws as this may result in damage to the thread within the metal plate

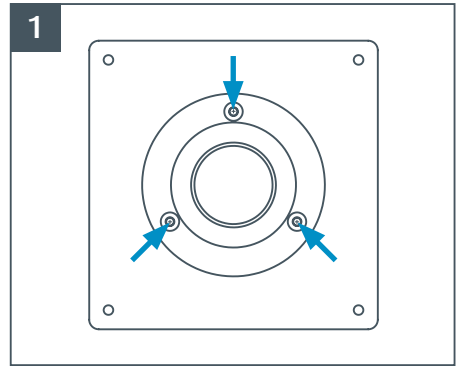

Setting Up the Precision Waterways

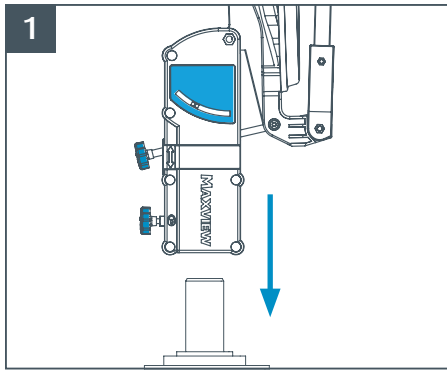

Offer dish unit onto mount.

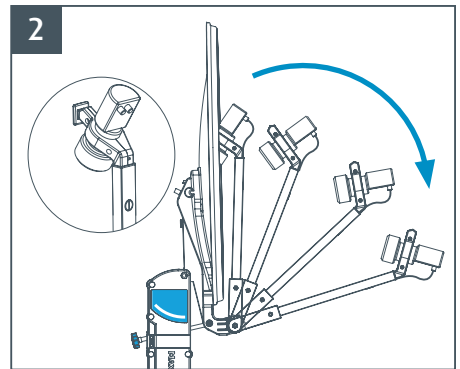

Pull down LNB arm from magnetic lock.

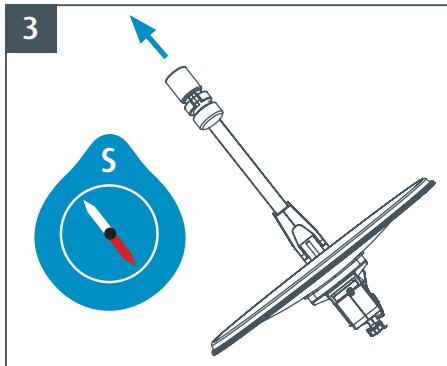

Use compass to point dish South-East.

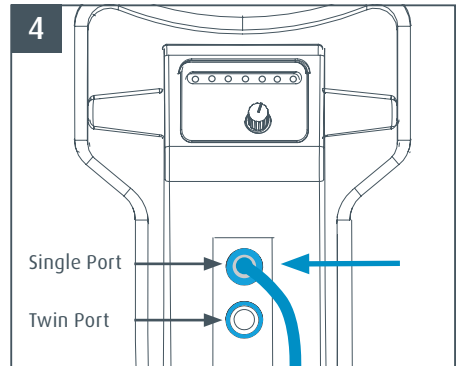

Plug in the 10m Push Fit 'F' to 'F' Flexible Cable to The cable connection port. See page 14 for receiver end connections.

Note: The Flexible Cable has been designed to push directly onto the 'F' Connector Port for easy set up.

 Sat Finder is wired to the single port.

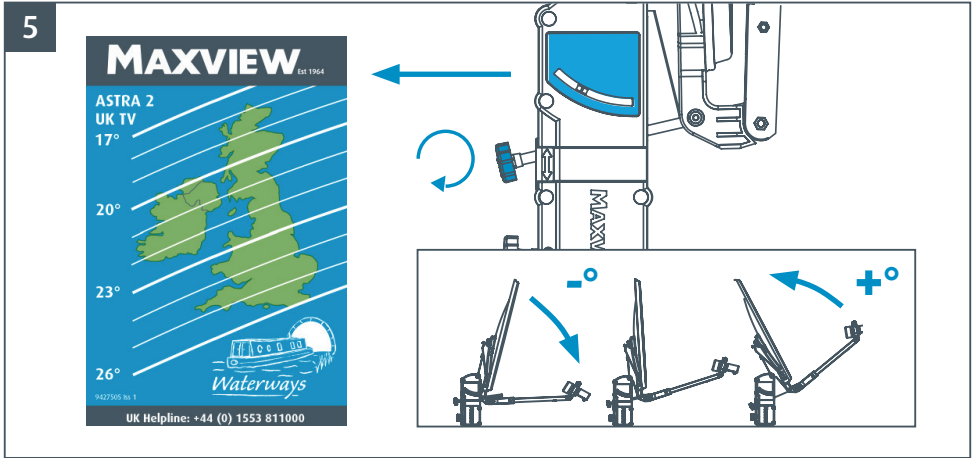

Use the elevation map to determine the required angle for your location. Set the dish to this angle using the elevation knob and indicator.

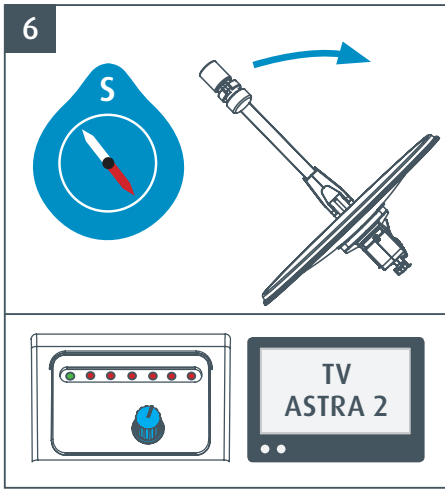

Slowly rotate your dish from left to right through the zone (see page 12) until the correct satellite is located and a picture appears on your TV.

To aid the satellite location process you can use the following methods:

1. Use the integrated sat finder (page 11).
2. Use your receivers built in sat finder.

Please see overleaf for more information on both of these methods.

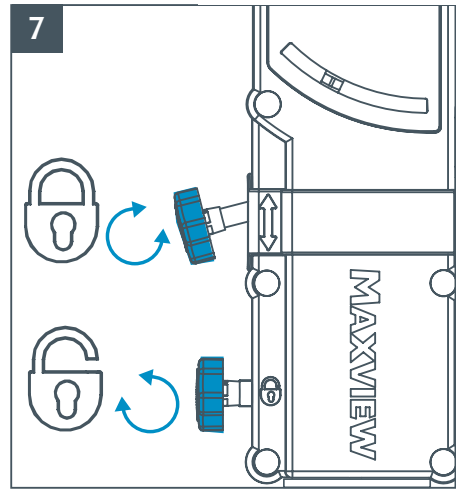

Once satellite is located, lock off the rotation by turning Azimuth lock knob. If you are experiencing signal drop out, fine tune your signal by slightly adjusting the elevation to improve TV picture quality. Again, you can aid this process by using:

1. The integrated sat finder.
2. Your receivers built in sat finder.

Line Of Sight

Note: The system is for stationary use only.
Please remove when boat is moving

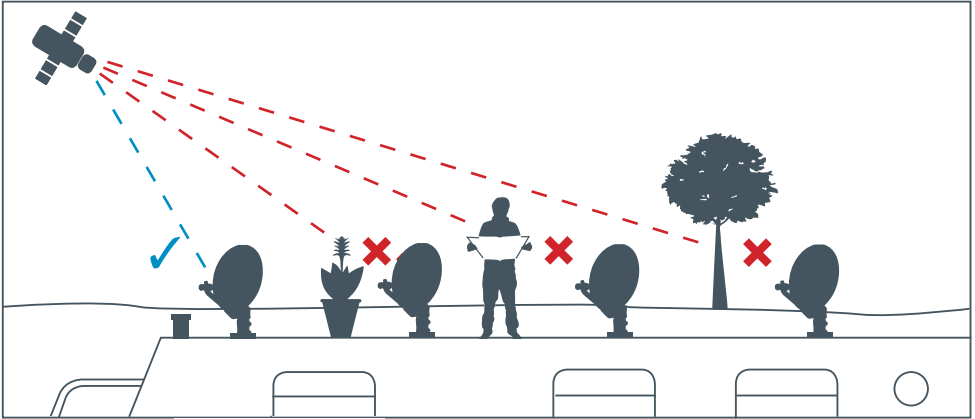

IMPORTANT

Do not block the antenna's line of sight to satellites in the southern sky at any time.
Make sure your dish has clear line of sight avoiding, buildings, bridges, trees and any other close by obstacles.

Dish Removal

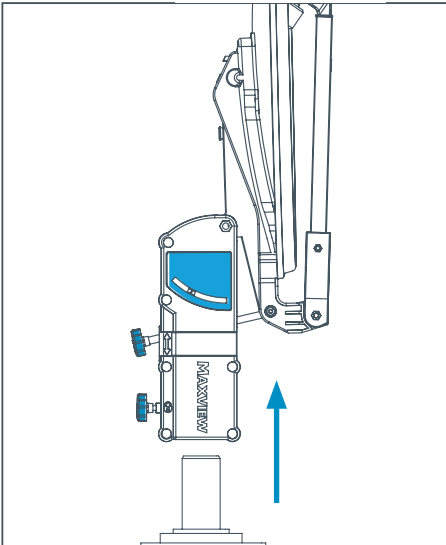

We recommend removing unit when not in use.
Loosen azimuth lock knob and lift system.

Dish Storage

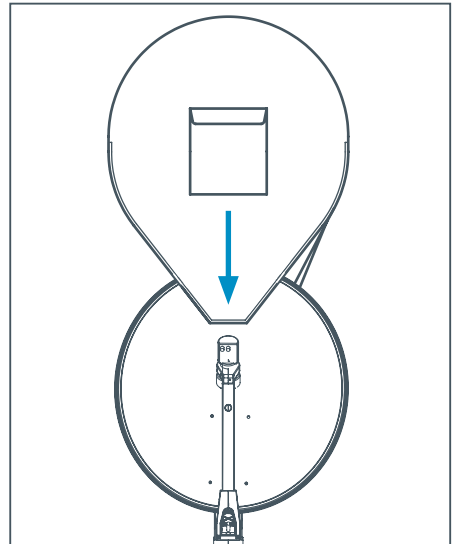

For easy handling the holdall has been designed to simply slide over the dish assembly.

Note: This bag has not been designed to be used for an outside cover for the system.



Not to be left outdoors.
Remove from mount.

Connecting Your Precision Waterways

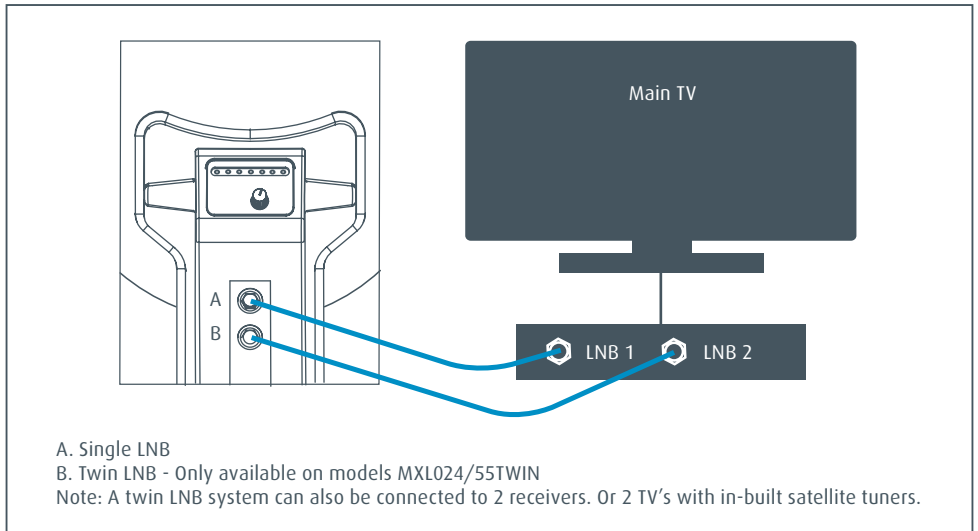

Signal Strength Meter On SKY® Box

To align the dish to Astra 2 using the sky receiver, use the SIGNAL TEST menu built into the SKY™ digibox. To access this menu:

Press the SERVICES button on the remote control. Enter SYSTEM SETUP (number 4).
Enter SIGNAL TEST (number 6). The display will then show, from top to bottom:
SIGNAL STRENGTH - SIGNAL QUALITY- LOCK INDICATOR - NETWORK ID - TRANSPORT STREAM.

You will need to adjust the dish until there is at least a quarter of the SIGNAL QUALITY bar display, the LOCK INDICATOR shows OK and the NETWORK ID is displaying 0002. If the NETWORK ID is showing any other details, you have locked onto the wrong satellite and will need to re-align the dish. Press BACK Up to exit menu's.

Using Your Sat Finder

Your Sat Finder is used to help you locate and find the best signal quality received from satellites.

Using the integrated sat finder.

Tune the sat finder by turning the knob fully anti-clockwise and then slowly clockwise until a deep tone is heard and until 2-3 red LEDs are lit. Slowly rotate the dish from left to right until the pitch of the sat finder tone peaks and more LEDs light up.

You should now have a picture on your TV.

Please note if you have a high tone on your sat finder and receiving no reception, you may have located a different satellite as the sat finder is unable to distinguish between different satellites. If this happens, repeat the above process, searching a slightly different area and dish angle.

Also ensure your receiver box is set to the correct satellite.

Fine tuning using the integrated sat finder.

Once a picture has been found, turn the sat finder down to a deep tone and finely adjust your elevation and azimuth to improve your signal and receive a higher tone with more lights lit.

Using the receiver sat finder.

Firstly, ensure your built in sat finder is turned off by turning it fully anti-clockwise so only the green light shows.

Turn your box onto the correct satellite (e.g. Astra 2 for UK) and bring up the satellite finder menu. (see receiver instructions).

Did you know?

Most receivers have a built in audio tone which sounds when a signal is located. Please check your receiver instructions. Use this when you are unable to see your TV screen.

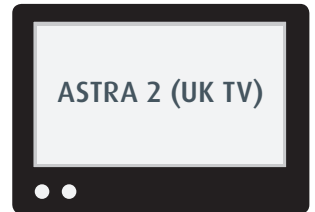
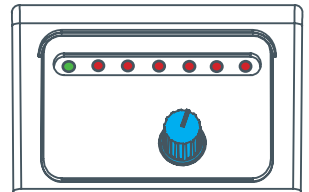

Satellite Azimuth Alignment Guide

Use this general guide to help determine the direction your desired satellite is located in the Southerly zone.

■ Astra 2

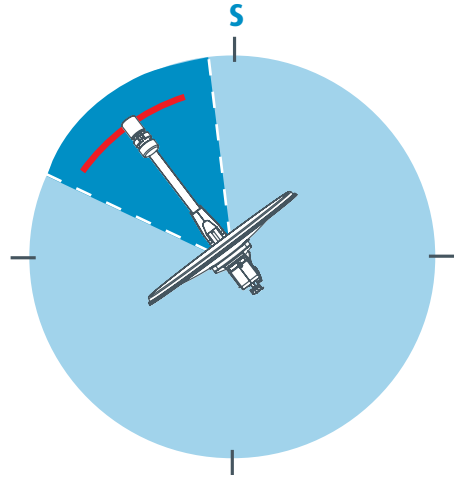

Adjusting LNB Skew

Skew can be adjusted to maximise signal in fringe areas.

Align Skew angle indication with arrow point or split line (highlighted in red).

Twist LNB to desired angle as shown.

For correct angle see the next page for Skew Map.

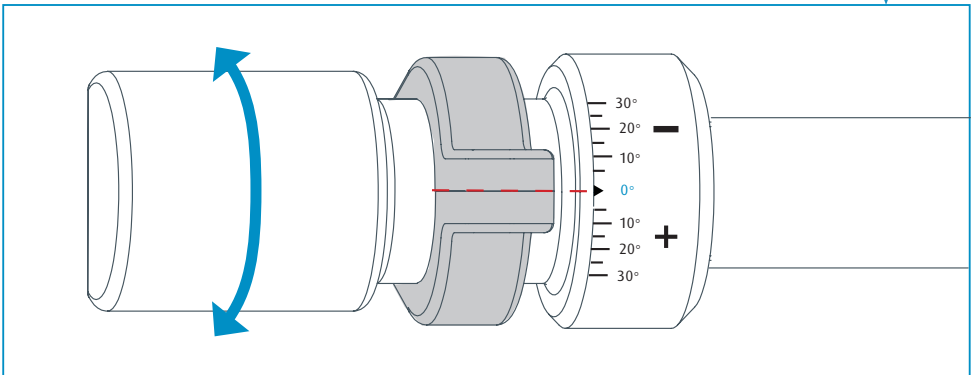
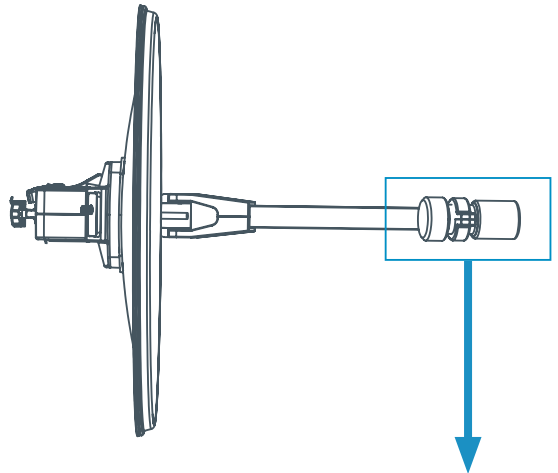

Skew Map

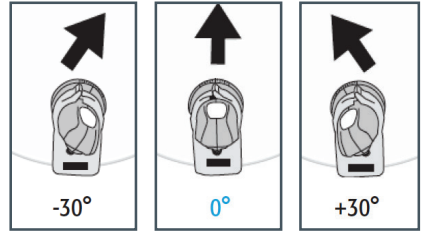
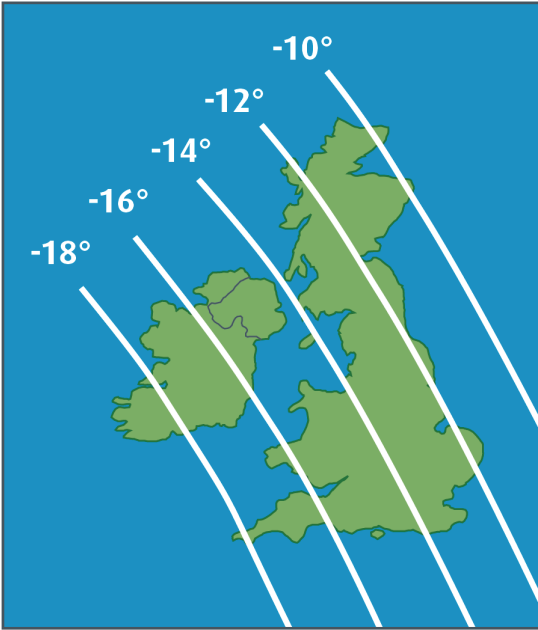

Elevation Map

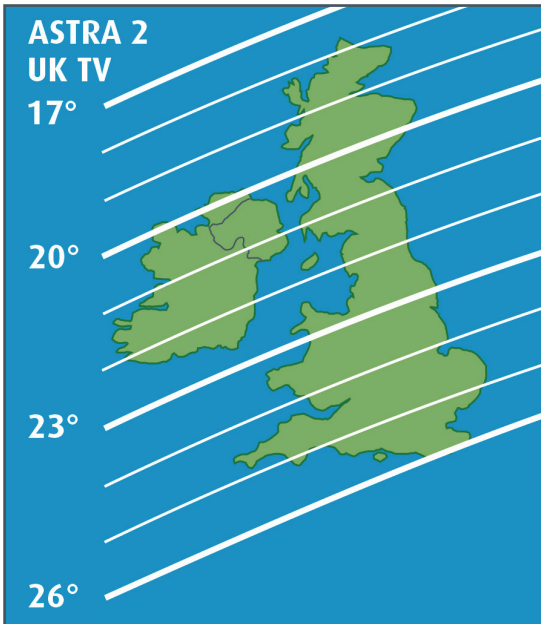

Use the elevation map to find the required elevation for your area



Glossary Of Terms

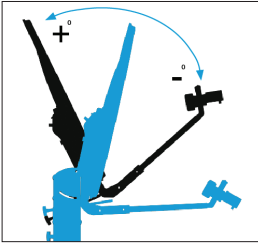

Elevation

The angle between the earth's surface and a particular satellite at a given reception point. This is the vertical angle adjustment of your dish. The elevation angle increases the closer you travel towards the equator.

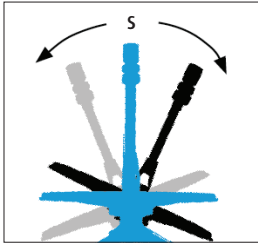

Azimuth

The angle between true north and a particular satellite.

Line Of Sight

This is a straight line between your satellite dish antenna and the satellite. The line between the two needs to be clear, as anything blocking the path will result in a signal disruption. See page 9.

Skew

This is the rotational position of an LNB on the dish arm. Skew can be used to maximise signal in fringe reception areas.

Footprint

This represents the broadcasting coverage area of a particular satellite depending on your dish size.

LNB (Low Noise Block)/LNB

The device which receives and collects the satellite signal reflected from the dish.

Free to air

Describes any products that receives free non-encrypted television and radio channels from a transmitter.

Fault Finding

Remember, to receive a clear satellite reception and picture, the dish must have the correct vertical (elevation) and horizontal (azimuth) alignment.

1. I don't want to use the Sat Finder, can I turn it off?

Simply turn the knob fully to the left. Your sat finder will now be silent and just a green light will be illuminated. Keeping it in-line doesn't affect your signal quality and uses very little power.

2. My Sat Finder has a high pitched tone but I have no picture.

You may have located a different satellite to the one your receiver is set to. E.g. If your receiver is set to Astra 2 (for UK), you may have located the wrong satellite. You will need to realign your dish. See page 12 to gain an idea of where you should point your dish and check elevation also.

3. The dish unit doesn't seem to be dropping onto the mount.

Ensure your rotation lock is not in the locked position. To do this you will need turn the knob anti-clockwise.

4. I am using one output on my twin kit and my Sat Finder isn't working.

The Sat Finder is internally wired to the top output. Therefore, if you wish to use your Sat Finder in a twin kit, but are only using one coaxial connection, ensure you connect the cable to the top output. Refer to page 11 for more information.

5. Will my satellite system work when pointing through trees and buildings?

Satellite, unlike TV signals, will not work through objects. The satellite dish must have a clear line of sight to the satellite in the sky.

6. My dish unit does not rotate smoothly.

Ensure the Azimuth lock is fully released before rotating the system.

7. My system appears to have excessive movement between dish unit and mount.

This is normal and required for rotation, however once you secure the azimuth lock, the system will become stable and will not affect signal reception or quality.

8. I have noticed water inside my system, is this a problem?

The Precision kit has been designed for outdoor use. Therefore, it has been designed for water to pass through the unit and exit easily. The system will dry out very quickly.

Accessories

Omnimax Magnetic Base (B2019)

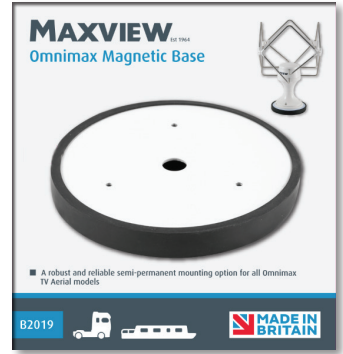
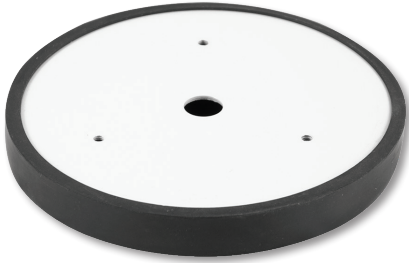

Semi-permanent magnetic mount for flat metal surfaces.

This mount is suitable if a permanent horizontal mount is not an ideal solution.

However this mount does have some usage restrictions:

- Only Suitable for low winds and gusts up to 25mph. (Fresh breeze, Beaufort Force 5 (19-24mph)
- These wind speed restrictions will be considerably lower if the rubber cap is used on the magnetic base.

Sold Separately. Visit www.maxview.co.uk for further information.

Assembly Instructions:

- Remove rubber cap.
- When attaching plastic mount to magnetic base ONLY use screws provided with the magnetic base.
- The mounting restrictions for the standard mount are applicable here also.
- Make sure area is clear of dirt and debris.

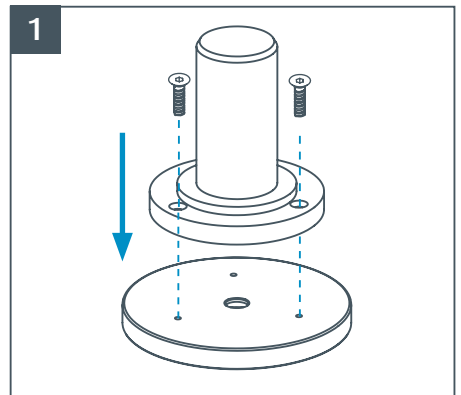

Disclaimer:

The Magnetic Base has been designed and tested for use in low wind. Maxview are not responsible for any damages caused whilst using the Omnimax Magnetic base. Use at your own risk.

Please note: It is important that you remove the rubber cap whilst using the magnetic base.

Accessories

Weatherproof Sockets

Available in
White (B2020) Single
White (B2007) Twin
or Anthracite (B2020/A) Single



Cable entry cover for your canal boat.

This option is ideal for keeping your cables tidy and giving a neat waterproof cable entry into your boat.

Sold Separately. Visit www.maxview.co.uk for further information.



Application example.

Safety Warnings

- Designed for stationary use only. Remove from mount when boat is moving.
 - Take care when adjusting systems, to avoid finger/s being trapped.
 - Always route cables carefully to avoid tripping over causing injury.
 - Always switch power off at the mains before starting any electrical work.
-

Care & Maintenance

The Precision has been designed to be maintenance and trouble free.
For optimum signal strength, keep the antenna clean from dirt, bugs and other debris.

1. Always handle the Precision kit with care. Do not drop the antenna.
2. Never power wash your Precision Kit. Keep the system clean from dirt, bugs, and other debris by hand washing with mild soap and water.



DO NOT USE SOLVENTS TO CLEAN YOUR PRECISION SYSTEM.

2 Year Guarantee

Every new Precision System is thoroughly inspected and tested before leaving the factory and is covered by our two years guarantee from the date of original purchase.

Maxview is responsible for the cost of a replacement part if the original part is determined to be defective under the terms of guarantee. The customer is responsible for the cost of replacement parts after two years.

Should any trouble develop during the guarantee period please contact Maxview before the expiry date. If you do experience a problem with the product contact Maxview Customer Services on +44 (0)1553 811000 or email support@maxview.co.uk

Please make sure you have the following ready when you call:

- Model number • Serial number • Date of purchase • Clear and concise details of the fault

The guarantee does not apply where:

- The product has been abused, misused, improperly installed or improperly maintained.
- The product has been installed without the use of Maxview mounting brackets
- Repairs have been made or attempted by a third party other than Maxview
- Repairs are required due to normal wear and tear
- Modifications have been made to the product
- Damaged caused by abrasive cleaning or power washing
- Circumstances beyond the control of Maxview that have caused the product to no longer operate correctly
- Customer is not the original owner or cannot provide proof of purchase

In no event shall Maxview be liable for any indirect, incidental, or consequential damages from the sale or use of the product. This disclaimer applies both during and after the term of the guarantee. This does not affect your statutory rights



UK contact:

Helpline: +44 (0)1553 811000
Email: support@maxview.co.uk
Web: www.maxview.co.uk