

# MAKER LIFE

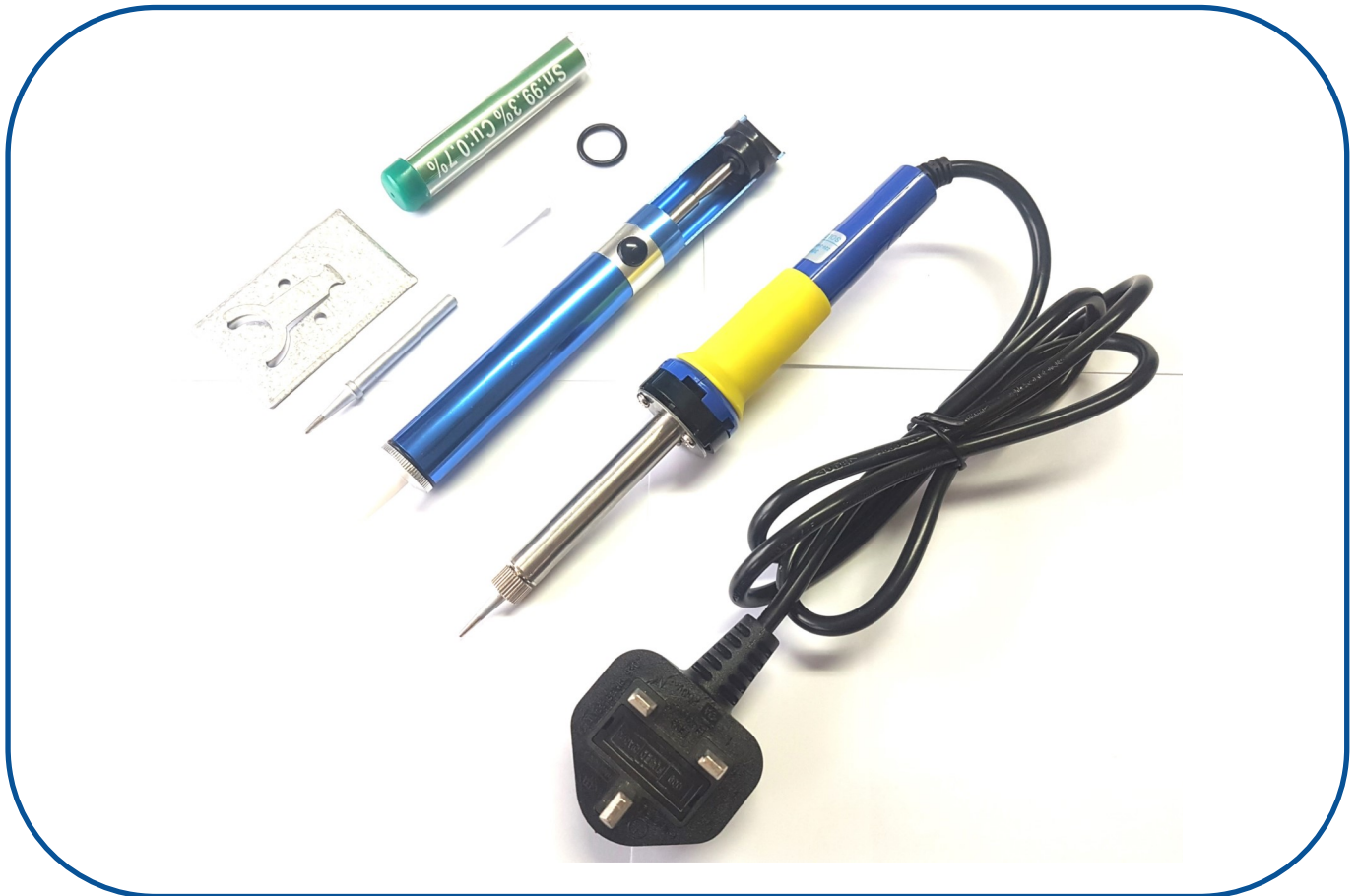

| Model Number | Details   |
|--------------|---|
| BSEL0008     | Soldering iron kit<br>-30W Soldering iron<br>-Spare tip<br>-Desoldering pump<br>-Spare nozzle<br>-Piston ring<br>-Soldering iron stand<br>-Soldering wire |

# MAKER LIFE

## MAINTENANCE:

This tool must be placed on its stand when not in use. If the supply cord is damaged, it must be replaced by the manufacturer or its service agent or a similarly qualified person in order to avoid hazard.

## HOW TO SOLDER:

- 1) File off any dirt, rust or paint on the part you wish to solder.
- 2) Heat the part with the soldering iron.

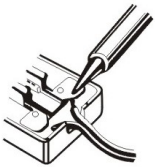

- 3) Apply rosin-based solder to the part and melt it with the soldering iron.

Note: when using non-rosin-based solder, be sure to apply a soldering paste to the part before applying the solder.



- 4) Wait for the solder to cool and harden before moving the soldered part.

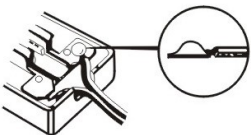

- 5) When you do soldering,

Please follow below steps to operate. This can maximally protect the tip from getting oxidation.

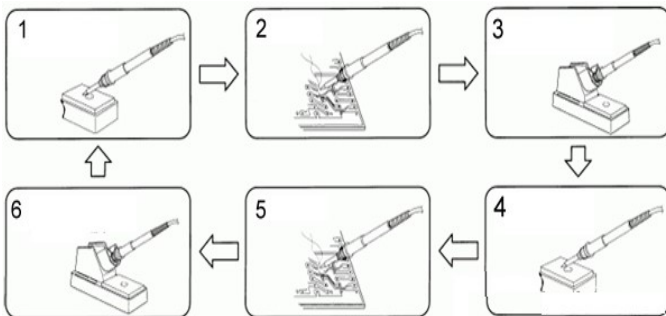

1. Before soldering, clean the tip on sponge, and then wear tin on the tip - Start your soldering work - when not in use (during breaks), please put the soldering iron on the holder -à clean the tip, wear tin on the tip - do the soldering - vice versa..

2. When the soldering work is done, adjust the temperature to 270°C or switch off the power first, and then clean the tip, wear tin on the tip as protection.

# MAKER LIFE

## TIP REPLACEMENT

Note: Tip replacement or cleaning should be done only when the iron is at room temperature or below. The tip can be changed or replaced simply by unscrewing the knurled nut barrel assembly. The station must be switched off and allowed to cool before and during this operation, as damage may result if the system is left on without the tip inserted, after removing tip, remove any oxide dust that may have formed in the tip retaining area of the barrel. Be careful to avoid getting dust in your eyes. Replace the tip and screw the retaining knurled nut barrel assembly using only hand pressure to tighten. Pliers should only be used to tighten the nut if loosening should occur when the iron is hot to avoid burning your fingers. Care should be taken not to over tighten as this would damage the element.

## GENERAL CLEANING

The outer case of the iron or station may be cleaned with a damp cloth using small amounts of liquid detergent. Never submerge the unit in liquid or allow any liquid to enter the case of the station. Never use solvent to clean the case.

## WARNING INSTRUCTIONS:

The appliance is not a toy, and must be kept out of children's hands.

Before cleaning the appliance or changing the filter, always remove the power lead plug from the socket. Unscrewing the housing is not permitted.

This appliance is not intended for use by persons (including children) with reduced physical, sensory or mental capabilities, or lack of experience and knowledge, unless they have been given supervision or instruction concerning use of the appliance by a person responsible for their safety.

Children should be supervised to ensure that they do not play with the appliance.

If the supply cord is damaged, it must be replaced by the manufacturer, its service agent or similarly qualified persons in order to avoid a hazard.

## ATTENTION:

On first time use the soldering iron may produce smoke, this is just grease used in manufacturing burning off, it is normal and should only last for approx. 10 minutes. It is not harmful to the product or user.

## CARE OF THE TIP:

Always keep tips coated with tin to ensure a long service life.

Do not keep the iron at high temperature for a long time

Never clean the tip with coarse materials

Never cool in water.

Remove the tip and clean every twenty hours of use, or at least once a week, and remove any loose build up in the barrel.

Do not use fluxes containing chloride or acid. Use only rosin or activated resin fluxes.

Do not use any compound or anti-seize materials

Handle the heated soldering iron with extreme care, as the high temperature of the iron can cause fires or painful burns.

Make sure that the soldering tip is correctly fitted and that the locking screw is tightened.

Never file the specially-plated tip.

