

# Product Data Sheet



## GL35

### Grounding Lug

Part No: 9819830



**Screw is GREEN: Universal color for grounding**

**Wire Range:**

- #350 kcmil - #6 AWG Cu Wire
- #350 kcmil - #6 AWG Cu Wire

See tables below for Flexible stranded approvals.

**Electrical Ratings:**

- 310A copper wire, 250A aluminum wire (Based on NEC Table 310-16, 75°C columns)

**Materials:**

- Connector: High conductivity aluminum, tin plated
- Terminal screws: Steel, nickel plated – painted green

**Agency Approvals:**

- UL Recognized, UL, File No. ZMVF2.E43665
- CSA Certified, CSA File No. 63510-25 (Wire Classes B & C only)
- RoHS Compliant

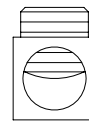

**Wire Range:**

		Copper Wire Stranding Classes - Number of Strands						
Wire Size	Torque	Solid	Class B	Class C	Class G	Class H	Class I	Class K
350 kcmil	275 in. lbs		37	61				
300	275 in. lbs		37	61				
250	275 in. lbs		37	61	~ 259	~ 427	~ 637	~ 2499
4/0	275 in. lbs		19	37	~ 133	~ 259	~ 532	~ 2107
3/0	275 in. lbs		19	37	~ 133	~ 259	~ 418	~ 1666
2/0	275 in. lbs		19	37	~ 133	~ 259	~ 342	~ 1323
1/0	275 in. lbs		19	37	~ 133	~ 259	~ 266	~ 1064
1	275 in. lbs		19	37	~ 133	~ 259	~ 210	~ 836
2	275 in. lbs		7	19	~ 49	~ 133	~ 161	~ 665
4	275 in. lbs		7	19				
6	275 in. lbs		7	19				

~Quantity of strands for Classes G, H, I, K may vary by manufacturer.

Aluminum stranded wire range: #350– #6 AWG

- Hex key required: 5/16"
- Wire strip length – 1 3/16"
- Panel mountable: 1/2" fastener, torque to 40 ft. lbs. (54 N-m)
- Lock washer and flat washer recommended with mounting bolt

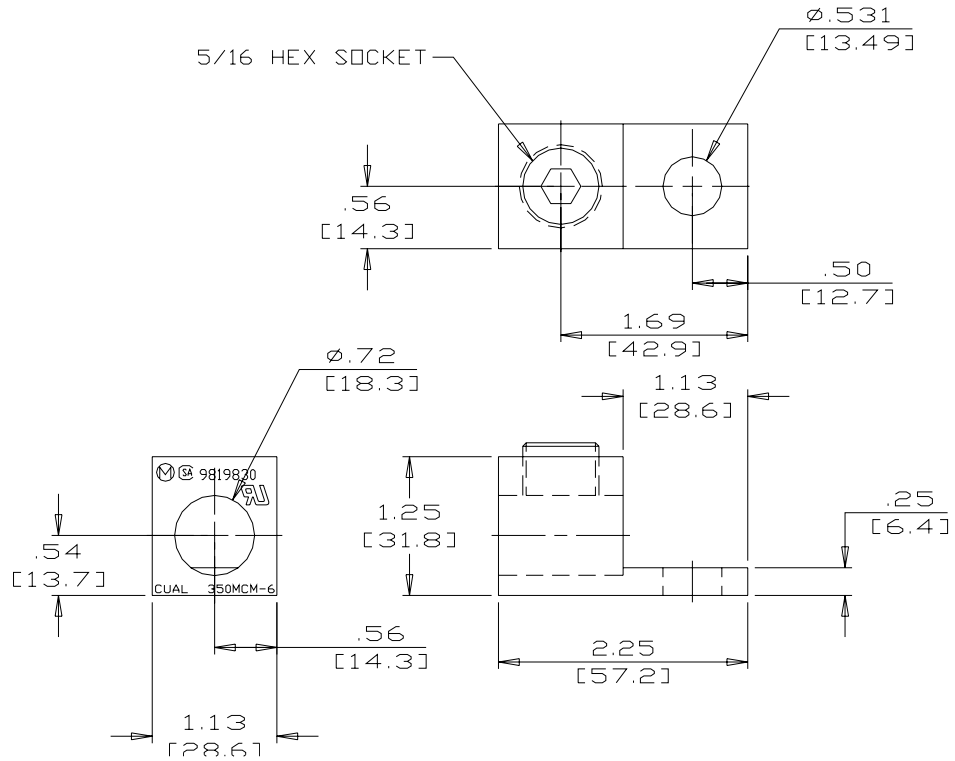

[WWW.MARATHONSP.COM](http://WWW.MARATHONSP.COM)  
1-419-352-8441

PDS 0368 REV A 6/04/09