

# DU Flanged bushes

717-6340

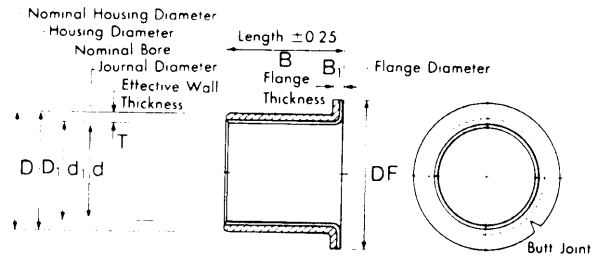

Figure 18

$d_1$	$D$	$DF$	$d$	$D_1$	$B_1$	$T$	$B$																																																																																																	
6	8	12	5.990	8.015	1.00	1.005	4	FMB 0604DU	8	FMB 0608DU																																																																																														
			5.978	8.000																																																																																																				
8	10	15	7.987	10.015									0.80	0.980	5.5	FMB 0805.5DU	7.5	FMB 0807.5DU	9.5	FMB 0809.5DU																																																																																				
			7.972	10.000																																																																																																				
10	12	18	9.987	12.018																	1.50	1.505	7	FMB 1007DU	9	FMB 1009DU	12	FMB 1012DU	17	FMB 1017DU																																																																										
			9.972	12.000																																																																																																				
12	14	20	11.984	14.018																											1.30	1.475	7	FMB 1207DU	9	FMB 1209DU	12	FMB 1212DU	17	FMB 1217DU																																																																
			11.966	14.000																																																																																																				
14	16	22	13.984	16.018																																					2.00	2.005	12	FMB 1412DU	17	FMB 1417DU																																																										
			13.966	16.000																																																																																																				
15	17	23	14.984	17.018																																															1.80	1.970	9	FMB 1509DU	12	FMB 1512DU	17	FMB 1517DU																																														
			14.966	17.000																																																																																																				
16	18	24	15.984	18.018																																																									11.5	11.505	12	FMB 1612DU	17	FMB 1617DU																																						
			15.966	18.000																																																																																																				
18	20	26	17.984	20.021																																																																			11.5	11.505	12	FMB 1812DU	17	FMB 1817DU	22	FMB 1822DU																										
			17.966	20.000																																																																																																				
20	23	30	19.980	23.021																																																																													16.5	16.505	11.5	FMB 2011.5DU	16.5	FMB 2016.5DU	21.5	FMB 2021.5DU																
			19.959	23.000																																																																																																				
25	28	35	24.980	28.021																																																																																							16.5	16.505	11.5	FMB 2511.5DU	16.5	FMB 2516.5DU	21.5	FMB 2521.5DU						
			24.959	28.000																																																																																																				
30	34	42	29.980	34.025	16	16.005	16	FMB 3016DU	26	FMB 3026DU																																																																																														
			29.959	34.000																																																																																																				
35	39	47	34.975	39.025									16	16.005	16	FMB 3516DU	26	FMB 3526DU																																																																																						
			34.950	39.000																																																																																																				
40	44	52	39.975	44.025																	16	16.005	16	FMB 4016DU	26	FMB 4026DU																																																																														
			39.950	44.000																																																																																																				

All dimensions in mm