

# EAO – Your Expert Partner for Human Machine Interfaces

## 82-5151.02A4 - Indicator 19 mm stainless-steel

### 82-5151.02A4 - Indicator 19 mm stainless-steel



*Attention: The preview is based on a sample product. This can differ from your current configuration.*

#### Mounting

Mounting cut-out Ø 19 mm  
Design flush

#### Front

Front dimension Ø 22 mm  
Front shape round  
Front ring shape flush  
Front bezel material Stainless steel

#### Other Attributes

Operating voltage 24 V VDC  
Weight 0,018 kg  
Operation current 7 mA

#### Operating-/Indication part

Lens optics opaque  
Lens material Stainless steel  
Lens profile flat  
Lens illumination illuminative  
Lens colour Stainless steel

#### IP-Rating

Front protection IP 65, IP 67

#### Connection Method

Terminal Solder 2.8 x 0.5 mm

#### Illumination

Illumination Dot with LED bi-colour red/green

#### Function

Indicator

# EAO – Your Expert Partner for Human Machine Interfaces

82-5151.02A4 - Indicator 19 mm stainless-steel

## Dimensions

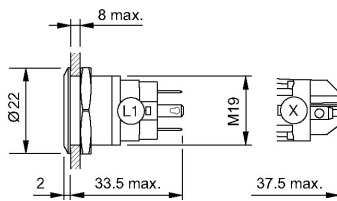

## Mounting cut-outs

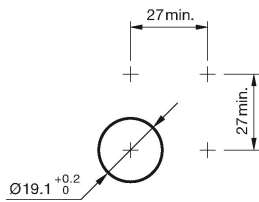

## Wiring diagram

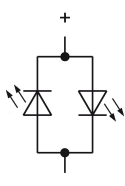

## Component layout

