



Pass & Seymour

Switches  
Hard Use

15 & 20A, 120/277VAC

**CSB15AC1, CSB15AC2, CSB15AC3, CSB15AC4, CSB20AC1, CSB20AC2, CSB20AC3, CSB20AC4**

**Affordable durability for a wide range of applications.**

**T**hese switches offer excellent value while meeting federal specification standards. External screw-pressure-plate back wiring enables fast installation and superior electrical connections. Rugged construction shrugs off hard-use and abuse.

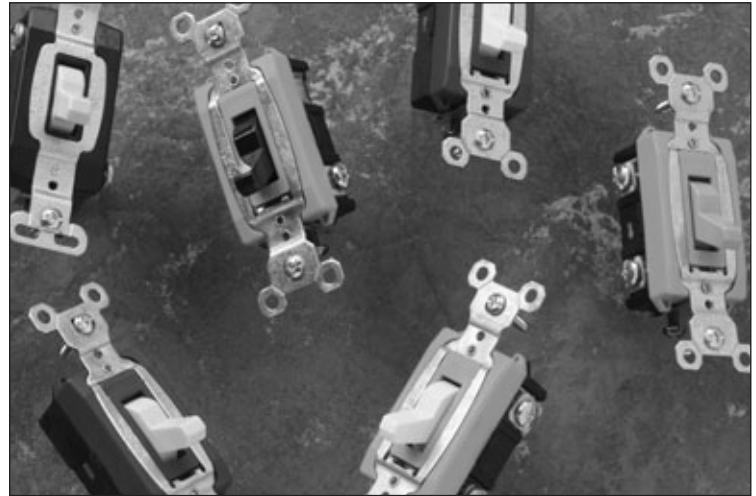

**Features & Benefits**

**One-piece plated steel strap** for corrosion-resistance.

**Heavy-duty bumpers** for quiet, smooth operation.

**Oversized silver-alloy contacts** for long life and better heat dissipation.

**Heavy-duty, brass alloy, one-piece contact arm** virtually eliminates contact bounce.

**Shallow design** for easier installation.

**Glass-reinforced nylon back body** for durability and strength.

**Cam control and spring actuator** for positive "makes and breaks" with a minimum of arcing.

**Locking support** provides resistance to face and back body separation.

**Side and external screw-pressure-plate back wire** with #14 - #10 AWG copper or copper-clad wire.

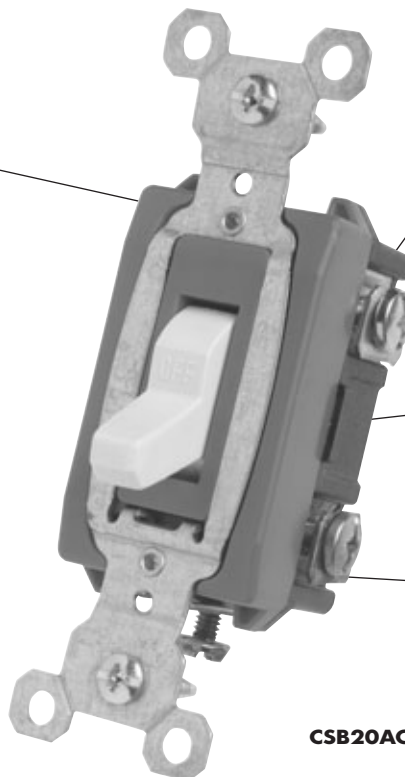

**CSB20AC1-LA**

**Field Uses/Vertical Markets**

- Education
- Institutional
- Retail
- Office
- Hospitality/Lodging
- Multiple Dwelling



Pass & Seymour

# Switches Hard Use 15 & 20A, 120/277VAC

## Ordering Information

Catalog Number				Rating		Color
Single Pole	Double Pole	Three-Way	Four-Way	A.	VAC	
<b>Toggle Switches</b> Back & Side Wire						
CSB15AC1-I	CSB15AC2-I	CSB15AC3-I	CSB15AC4-I	15	120/277	Ivory
CSB15AC1-W	CSB15AC2-W	CSB15AC3-W	CSB15AC4-W	15	120/277	White
CSB15AC1	CSB15AC2	CSB15AC3	CSB15AC4	15	120/277	Brown
CSB15AC1-GRY	CSB15AC2-GRY	CSB15AC3-GRY	CSB15AC4-GRY	15	120/277	Gray
CSB15AC1-LA	CSB15AC2-LA	CSB15AC3-LA	CSB15AC4-LA	15	120/277	Light Almond
CSB20AC1-I	CSB20AC2-I	CSB20AC3-I	CSB20AC4-I	20	120/277	Ivory
CSB20AC1-W	CSB20AC2-W	CSB20AC3-W	CSB20AC4-W	20	120/277	White
CSB20AC1	CSB20AC2	CSB20AC3	CSB20AC4	20	120/277	Brown
CSB20AC1-GRY	CSB20AC2-GRY	CSB20AC3-GRY	CSB20AC4-GRY	20	120/277	Gray
CSB20AC1-LA	CSB20AC2-LA	CSB20AC3-LA	CSB20AC4-LA	20	120/277	Light Almond

For more information on these and other P&S products refer to our Catalog or visit our web site.

# Switches Hard Use 15 & 20A, 120/277VAC



Pass & Seymour

## Technical Specifications

### 3rd Party Compliance

UL Listed, File Number E140597, Standard UL20, General Use Snap Switches.  
Federal Specification WS896.  
cULus Listed, File Number LR17446, Standard CSA-C22.2 No. 111, General Use Snap Switches.  
Conforms to NEMA WD-1 and WD-6.

### Performance

#### Electrical

Dielectric Withstand Voltage	1500V Minimum
Maximum Working Voltage	277VAC
Overload	Minimum 4.8 times rated current for 100 cycles
Temperature Rise	30°C maximum at rated current
Maximum Continuous Current	277VAC
Endurance	50,000 cycles minimum, resistive, inductive, tungsten filament lamp load (Fed Spec)

#### Mechanical

Terminal Accommodations	#14 AWG – #10 AWG
-------------------------	-------------------

#### Environmental

Flammability	UL94 V2
Operating Temperature	Maximum continuous +115°C, minimum -40°C

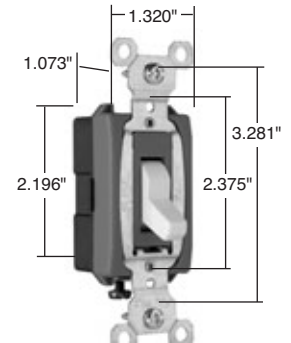

Dimensions for  
15 & 20 Amp

### Materials

Back Body	Glass-Reinforced Nylon	Contacts	Silver Cadmium Oxide
Front Body	Nylon	Spring Arm	Brass
Toggle	Thermoplastic Polycarbonate	Bumper	Rubber
Terminals	Brass	Spring	Zinc-Plated Steel
Terminal Screws	Tri-Drive Brass-Plated Steel	Ground Terminal	Brass
Strap	Plated Steel	Ground Screw	Tri-Drive Zinc-Plated Steel
Pressure Plate	Brass		

15 Amp Cover	Blue
20 Amp Cover	Red

### Warranty

1 Year

## Complimentary Devices & Accessories

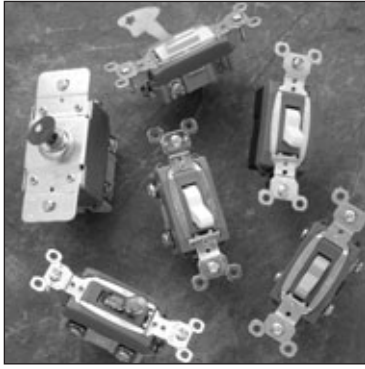

### SWITCHES

- Heavy-Duty Toggle
- Heavy-Duty Lighted Toggle
- Heavy-Duty Security
- Heavy-Duty Locking
- Commercial Grade Toggle

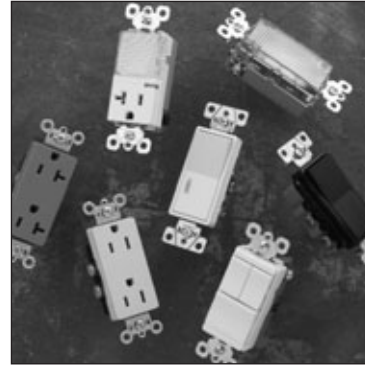

### DECORATOR DEVICES

- Construction Grade Switches
- Specification Grade Combo Switches
- Construction Grade Receptacles
- Commercial Grade Receptacles
- Specification Grade Hallway Lights

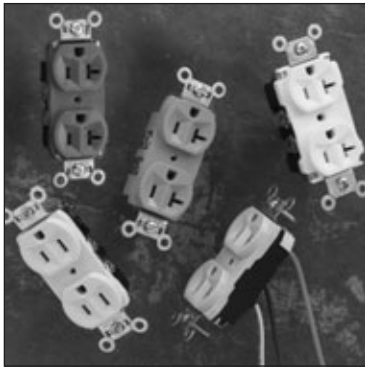

### STRAIGHT BLADE RECEPTACLES

- Extra Heavy-Duty
- Heavy-Duty
- Hard Use
- Construction Grade
- Construction Grade Leaded
- Commercial Grade

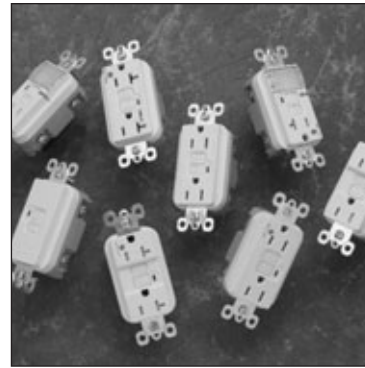

### GFCIs

- Specification Grade
- Hospital Grade
- Dead Front



### WALL PLATES

- TradeMaster® Thermoplastic Nylon
- Screwless Polycarbonate
- Stainless Steel
- Brass
- Aluminum
- Dustproof Stainless Steel Covers

## Also available...

- Light Almond Devices
- Hospital Grade Devices
- PlugTail™ Devices
- TVSS & Isolated Ground Devices
- Ground Continuity Monitoring (GCM)
- Straight Blade Plugs & Connectors
- Turnlok® Locking Devices
- Weatherproof Boxes & Covers
- IEC 309 Industrial Products
- Flexcor® Wire Mesh Grips
- Configurable Solutions



**Legrand/Pass & Seymour**  
P.O. Box 4822  
Syracuse, NY 13221-4822  
800-223-4185

**North America Headquarters**  
60 Woodlawn Street  
West Hartford, CT 06110  
Phone: 1.877.BY.LEGRAND (295.3472)  
Fax: 1.860.232.2062  
www.legrand.us

**Legrand Canada**  
570 Applewood Crescent  
Vaughan, ON, L4K 4B4  
Phone: 905.738.9195  
Fax: 905.738.9721  
www.legrand.ca

SF104R2 — Updated April 2006 — For latest specs visit [www.legrand.us/passandseymour](http://www.legrand.us/passandseymour)