

## Base strip - MSTB 2,5/10-G - 1754591

Please be informed that the data shown in this PDF Document is generated from our Online Catalog. Please find the complete data in the user's documentation. Our General Terms of Use for Downloads are valid (<http://phoenixcontact.com/download>)

Header, nominal current: 12 A, rated voltage (III/2): 320 V, number of positions: 10, pitch: 5 mm, Color: green, contact surface: Tin, mounting: Wave soldering



The figure shows a 10-position version of the product

### Why buy this product

- Maximum flexibility when it comes to device design – one header for connectors with different connection technologies
- Easy PCB replacement thanks to plug-in modules
- Well-known mounting principle allows worldwide use
- Items that can be aligned in various pitches support flexible and space-saving PCB assembly

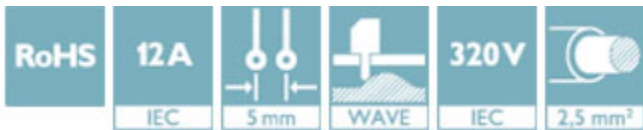

### Key Commercial Data

Packing unit	1 STK
GTIN	
GTIN	4017918028763
Weight per Piece (excluding packing)	3.600 g
Custom tariff number	85366930
Country of origin	Germany

### Technical data

#### Dimensions

Length [ l ]	12 mm
Pitch	5 mm
Dimension a	45 mm
Width [ w ]	50 mm
Constructional height	8.6 mm

## Base strip - MSTB 2,5/10-G - 1754591

### Technical data

#### Dimensions

Height [ h ]	12.1 mm
Length of the solder pin	3.5 mm
Pin dimensions	1 x 1 mm
Hole diameter	1.4 mm

#### General

Range of articles	MSTB 2,5/..-G
Insulating material group	I
Rated surge voltage (III/3)	4 kV
Rated surge voltage (III/2)	4 kV
Rated surge voltage (II/2)	4 kV
Rated voltage (III/3)	250 V
Rated voltage (III/2)	320 V
Rated voltage (II/2)	400 V
Connection in acc. with standard	EN-VDE
Nominal current $I_N$	12 A
Maximum load current	12 A
Insulating material	PA
Flammability rating according to UL 94	V0
Color	green
Number of positions	10

#### Standards and Regulations

Connection in acc. with standard	EN-VDE
	CSA
Flammability rating according to UL 94	V0

#### Environmental Product Compliance

China RoHS	Environmentally friendly use period: unlimited = EFUP-e
	No hazardous substances above threshold values

### Drawings

# Base strip - MSTB 2,5/10-G - 1754591

Dimensional drawing

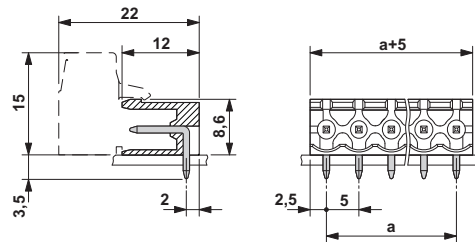

## Classifications

### eCl@ss

eCl@ss 4.0	272607xx
eCl@ss 4.1	27260701
eCl@ss 5.0	27260701
eCl@ss 5.1	27260701
eCl@ss 6.0	27260704
eCl@ss 7.0	27440402
eCl@ss 8.0	27440402
eCl@ss 9.0	27440402

### ETIM

ETIM 3.0	EC001121
ETIM 4.0	EC002637
ETIM 5.0	EC002637
ETIM 6.0	EC002637

### UNSPSC

UNSPSC 6.01	30211810
UNSPSC 7.0901	39121409
UNSPSC 11	39121409
UNSPSC 12.01	39121409
UNSPSC 13.2	39121409

## Approvals

### Approvals

#### Approvals

CSA / VDE Gutachten mit Fertigungsüberwachung / IECCEB Scheme / cULus Recognized / EAC

# Base strip - MSTB 2,5/10-G - 1754591

## Approvals

Ex Approvals

### Approval details

CSA		<a href="http://www.csagroup.org/services/testing-and-certification/certified-product-listing/">http://www.csagroup.org/services/testing-and-certification/certified-product-listing/</a>	13631
		B	D
Nominal current IN		10 A	10 A
Nominal voltage UN		300 V	300 V

VDE Gutachten mit Fertigungsüberwachung		<a href="http://www.vde.com/en/Institute/OnlineService/VDE-approved-products/Pages/Online-Search.aspx">http://www.vde.com/en/Institute/OnlineService/VDE-approved-products/Pages/Online-Search.aspx</a>	40004701
Nominal current IN		12 A	
Nominal voltage UN		250 V	

IECEE CB Scheme		<a href="http://www.iecee.org/">http://www.iecee.org/</a>	DE1-58978-B1B2
Nominal current IN		12 A	
Nominal voltage UN		250 V	

cULus Recognized		<a href="http://database.ul.com/cgi-bin/XYV/template/LISEXT/1FRAME/index.htm">http://database.ul.com/cgi-bin/XYV/template/LISEXT/1FRAME/index.htm</a>	E60425-19931011
		B	D
Nominal current IN		15 A	15 A
Nominal voltage UN		300 V	150 V

EAC			B.01742
-----	---	--	---------

## Base strip - MSTB 2,5/10-G - 1754591

### Accessories

#### Accessories

#### Coding element

Coding star - CR-MSTB - 1734401



Coding section, inserted into the recess in the header or the inverted plug, red insulating material

---

### Filler plug

Accessories - MSTB-BL - 1755477



Keying cap, for forming sections, plugs onto header pin, green insulating material

---

### Flange

Accessories - MSTB-BF - 1759981



Mounting flange, for fixing both ends of the header onto the PCB, green insulating material, with M 2 x 14 screws and nuts.

---

### Labeled terminal marker

Marker card - SK 5/3,8:FORTL.ZAHLEN - 0804183



Marker card, Card, white, labeled, Horizontal: Consecutive numbers 1 - 10, 11 - 20, etc. up to 91 - (99)100, Mounting type: adhesive, for terminal block width: 5 mm, Lettering field: 5 x 3.8 mm

---

### Additional products

## Base strip - MSTB 2,5/10-G - 1754591

### Accessories

#### Printed-circuit board connector - TVFKC 1,5/10-ST - 1713910



Plug component, nominal current: 10 A, rated voltage (III/2): 320 V, number of positions: 10, pitch: 5 mm, connection method: Push-in spring connection, Color: green, contact surface: Tin

---

#### Printed-circuit board connector - TVFKCL 1,5/10-ST - 1716001

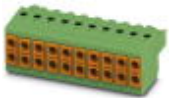

Plug component, nominal current: 10 A, rated voltage (III/2): 320 V, number of positions: 10, pitch: 5 mm, connection method: Push-in spring connection, Color: green, contact surface: Tin

---

#### Plug - QC 1,5/10-ST - 1718041

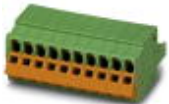

Plug component, nominal current: 12 A, rated voltage (III/2): 630 V, number of positions: 10, pitch: 5 mm, connection method: Displacement connection, Color: green, contact surface: Tin

---

#### Printed-circuit board connector - FKCN 2,5/10-ST - 1732823



Plug component, nominal current: 12 A, rated voltage (III/2): 320 V, number of positions: 10, pitch: 5 mm, connection method: Push-in spring connection, Color: green, contact surface: Tin

---

#### Printed-circuit board connector - MSTB 2,5/10-ST - 1754601



Plug component, nominal current: 12 A, rated voltage (III/2): 320 V, number of positions: 10, pitch: 5 mm, connection method: Screw connection with tension sleeve, Color: green, contact surface: Tin

## Base strip - MSTB 2,5/10-G - 1754591

### Accessories

#### Printed-circuit board connector - MSTB 2,5/10-STZ - 1759004



Plug component, nominal current: 12 A, rated voltage (III/2): 320 V, number of positions: 10, pitch: 5 mm, connection method: Screw connection with tension sleeve, Color: green, contact surface: Tin

---

#### Printed-circuit board connector - MSTBP 2,5/10-ST - 1765852



Plug component, nominal current: 12 A, rated voltage (III/2): 320 V, number of positions: 10, pitch: 5 mm, connection method: Screw connection with tension sleeve, Color: green, contact surface: Tin

---

#### Printed-circuit board connector - SMSTB 2,5/10-ST - 1768833



Plug component, nominal current: 12 A, rated voltage (III/2): 320 V, number of positions: 10, pitch: 5 mm, connection method: Screw connection with tension sleeve, Color: green, contact surface: Tin

---

#### Printed-circuit board connector - FRONT-MSTB 2,5/10-ST - 1779495



Plug component, nominal current: 12 A, rated voltage (III/2): 320 V, number of positions: 10, pitch: 5 mm, connection method: Front screw connection, Color: green, contact surface: Tin

---

#### Printed-circuit board connector - MSTBT 2,5/10-ST - 1779916



Plug component, nominal current: 12 A, rated voltage (III/2): 320 V, number of positions: 10, pitch: 5 mm, connection method: Screw connection with tension sleeve, Color: green, contact surface: Tin

## Base strip - MSTB 2,5/10-G - 1754591

### Accessories

Printed-circuit board connector - MVSTBR 2,5/10-ST - 1792090



Plug component, nominal current: 12 A, rated voltage (III/2): 320 V, number of positions: 10, pitch: 5 mm, connection method: Screw connection with tension sleeve, Color: green, contact surface: Tin

Printed-circuit board connector - MVSTBW 2,5/10-ST - 1792605



Plug component, nominal current: 12 A, rated voltage (III/2): 320 V, number of positions: 10, pitch: 5 mm, connection method: Screw connection with tension sleeve, Color: green, contact surface: Tin

Printed-circuit board connector - FKCT 2,5/10-ST - 1909294



Plug component, nominal current: 12 A, rated voltage (III/2): 320 V, number of positions: 10, pitch: 5 mm, connection method: Push-in spring connection, Color: green, contact surface: Tin

Printed-circuit board connector - FKCVR 2,5/10-ST - 1909799



Plug component, nominal current: 12 A, rated voltage (III/2): 320 V, number of positions: 10, pitch: 5 mm, connection method: Push-in spring connection, Color: green, contact surface: Tin

Printed-circuit board connector - FKCVW 2,5/10-ST - 1910115

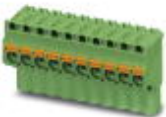

Plug component, nominal current: 12 A, rated voltage (III/2): 320 V, number of positions: 10, pitch: 5 mm, connection method: Push-in spring connection, Color: green, contact surface: Tin



## Base strip - MSTB 2,5/10-G - 1754591

### Accessories

Printed-circuit board connector - FKC 2,5/10-ST - 1910432

Plug component, nominal current: 12 A, rated voltage (III/2): 320 V, number of positions: 10, pitch: 5 mm, connection method: Push-in spring connection, Color: green, contact surface: Tin



Printed-circuit board connector - FKCS 2,5/10-ST - 1974818

Plug component, nominal current: 12 A, rated voltage (III/2): 320 V, number of positions: 10, pitch: 5 mm, connection method: Push-in spring connection, Color: green, contact surface: Tin

