

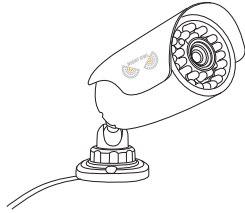

Please visit our website at www.NightOwlSP.com for all manuals, software, and firmware updates. There are also How-To videos with step-by-step instructions for connecting your device.

BEFORE YOU GET STARTED YOU WILL NEED



Camera

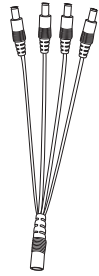

Power Splitter

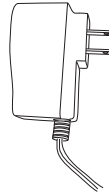

Camera Power Adapter

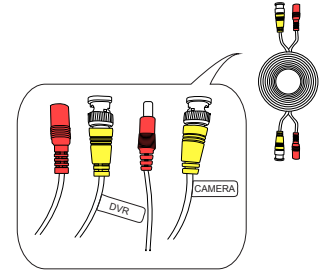

Video/Power Cables

CONNECTING CAMERAS TO YOUR DVR

NOTE: Connect the cameras to the DVR before mounting to ensure that they work properly.

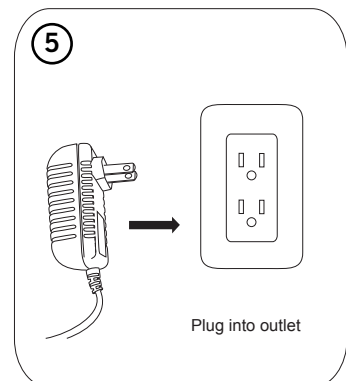
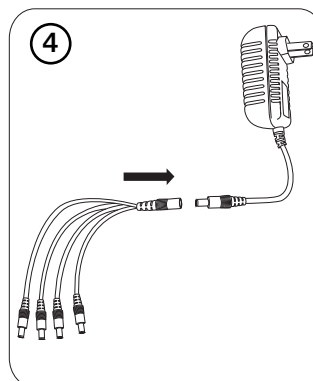
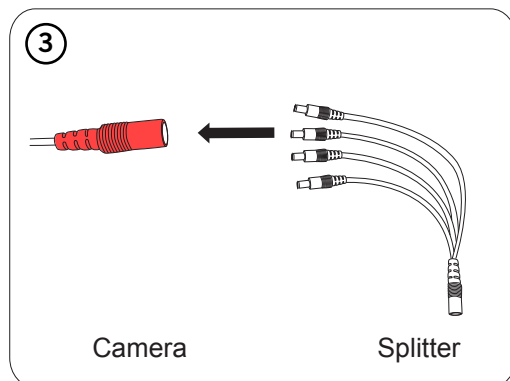
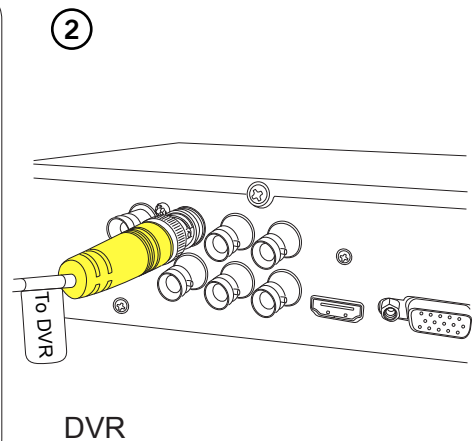
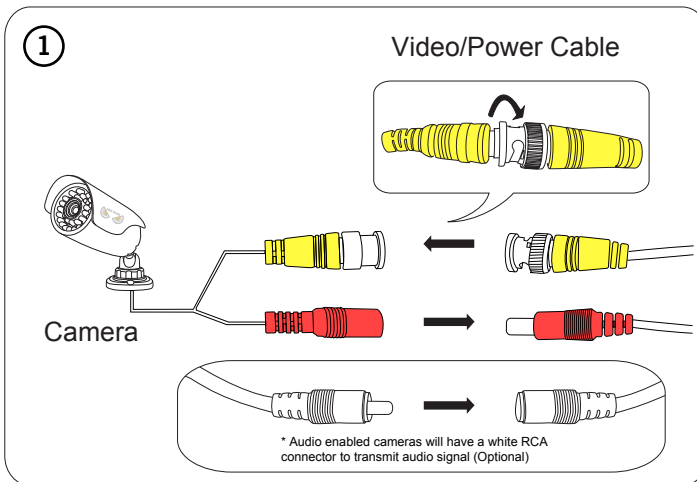



WIRING DIAGRAM

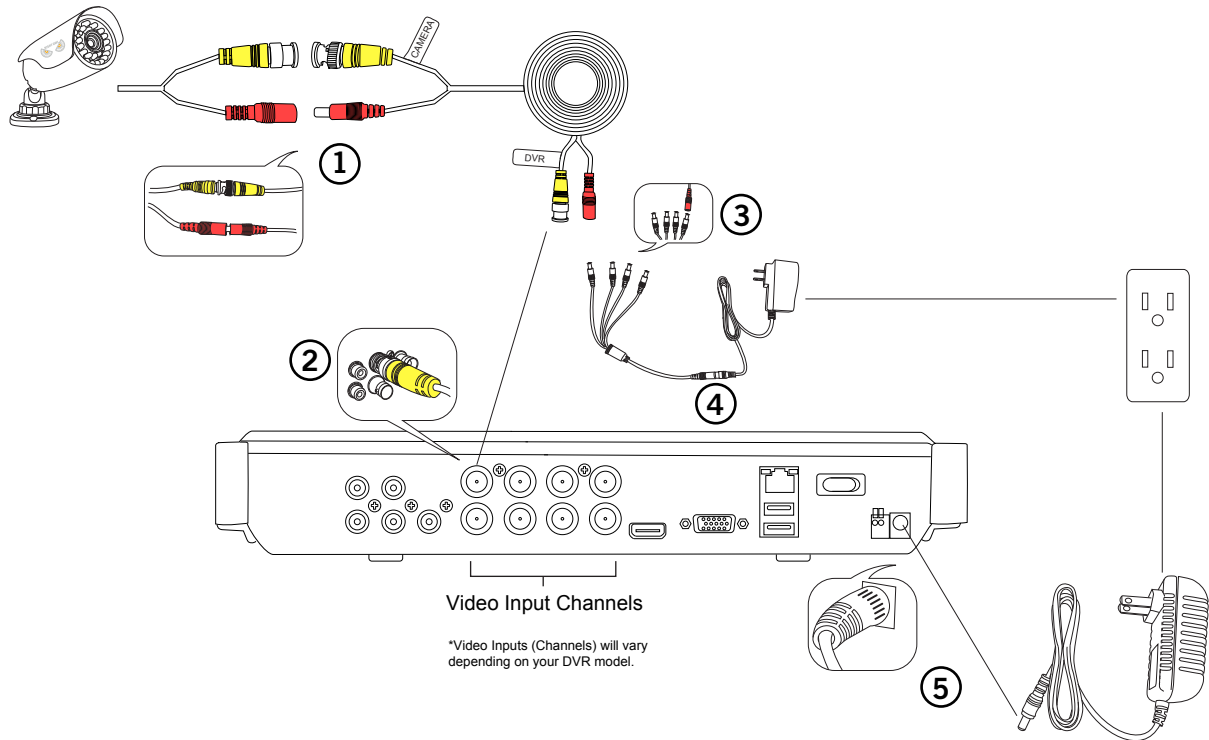

CAMERA SETUP

- ① Connect the video / power leads from the camera to the connectors on the video / power cable. *Audio enabled cameras will have an additional white RCA connector.
- ② Connect the BNC connector on the other end of the cable to any of the Video In ports on the DVR. (Video IN ports' quantity will vary depending on DVR channel size)
- ③ Plug one of the power leads on the power splitter into the power lead on the power and video cable. (Repeat for each camera included with this package to ensure proper connection and function)
- ④ Connect the single end of the power splitter to the camera power adapter.
- ⑤ Plug both power adapters from the DVR and Camera into a surge protector / power outlet.



Please visit our website at www.NightOwlSP.com for all manuals, software, and firmware updates. There are also How-To videos with step-by-step instructions for connecting your device.

BEFORE YOU GET STARTED YOU WILL NEED



DVR

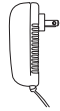

DVR Power Adapter



Mouse



HDMI



Monitor / T.V. (not included)

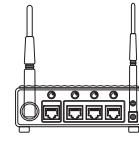

Router (not included)



Ethernet

CONNECTING THE DVR TO A MONITOR / T.V.

1

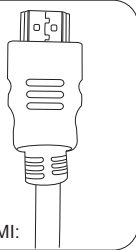

Using HDMI:

2

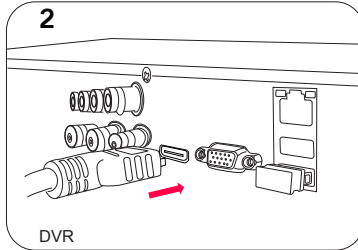

DVR

3

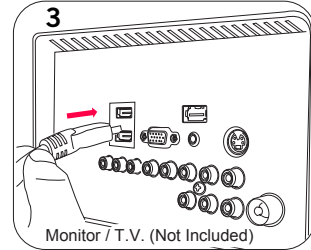

Monitor / T.V. (Not Included)

CONNECTING THE MOUSE TO YOUR DVR

1

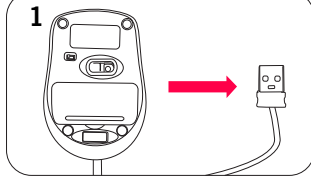

2

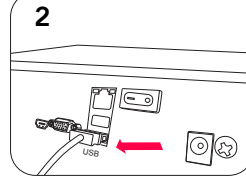

CONNECTING YOUR ROUTER

1

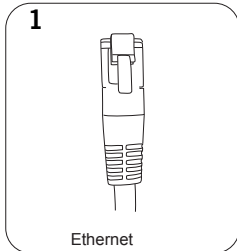

Ethernet

2

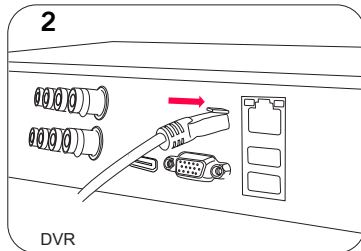

DVR

3

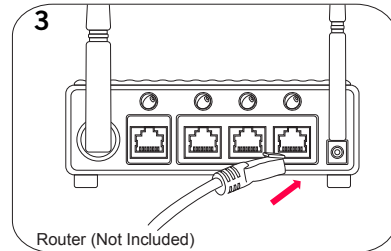

Router (Not Included)

POWERING YOUR DVR

1

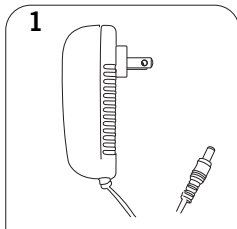

DVR Power Adapter

2

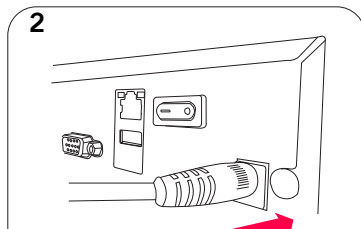

DVR

3

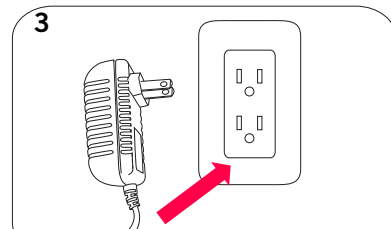

Plug into outlet

Images used are for reference only. Your product may vary slightly.