

THIS DRAWING IS UNPUBLISHED. RELEASED FOR PUBLICATION SEP ,2004.

© COPYRIGHT 2004 BY TYCO ELECTRONICS CORPORATION. ALL RIGHTS RESERVED.

LOC	DIST	REVISIONS					
E	B	P	LTR	DESCRIPTION	DATE	DWN	APVD
		D		ECR-06-002568	28SEP04	JMS	FWK

NOTES

- 1 100 TRAY PACK IN ACCORDANCE WITH AMP SPEC 107-3275
- 2 SINGLE PACK IN ACCORDANCE WITH AMP SPEC 107-3275
- 3 Au PLATING
- 4 Ni PLATING
- 5 ELECTRICAL CHARACTERISTICS  
 FREQUENCY RANGE: DC - 6 GHz  
 NOMINAL IMPEDANCE: 50 Ohm  
 INSULATION RESISTANCE: 1000 MOhm  
 WORKING VOLTAGE: 335 Volts RMS at Sea Level  
 DIELECTRIC WITHSTAND VOLTAGE: 1000 Volts RMS Max  
 CONTACT RESISTANCE:  
 CENTRE CONTACT: 5.00 mOhm Max  
 OUTER CONTACT: 1.00 mOhm Max  
 VSWR @ 4GHz: N/A  
 INSERTION LOSS dB @ x 1.0 GHz: 0.10 Max
- 6 MECHANICAL CHARACTERISTICS  
 COUPLING NUT RETENTION FORCE: N/A  
 DURABILITY: 500 Cycles Min
- 7 ENVIRONMENTAL CHARACTERISTICS  
 OPERATING TEMPERATURE: -65 to +165 DegC

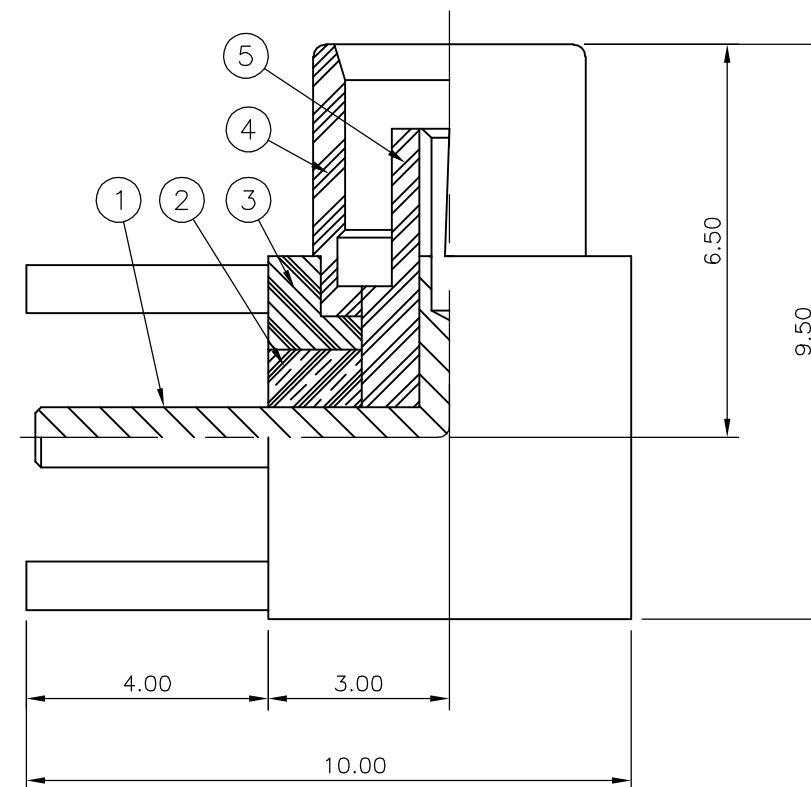
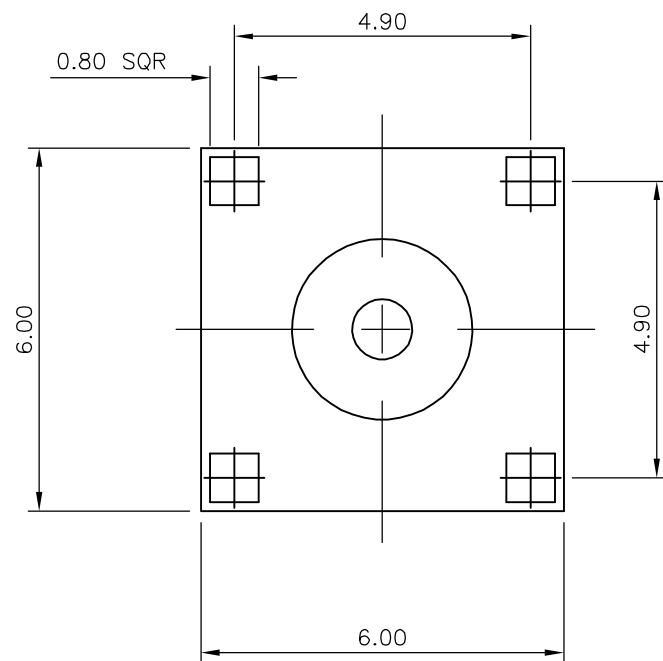

RECOMMENDED PCB LAYOUT WITH MOUNTING POSTS

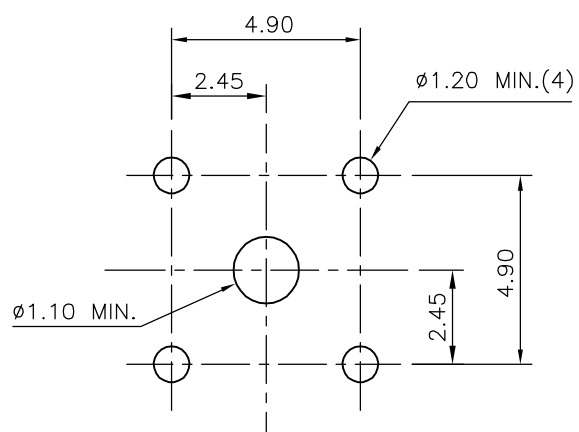

QTY	1	1	1	1	MATERIAL	DESCRIPTION	ITEM
					PTFE	INSULATOR	5
	-	-	1	1	BRASS	3 BODY	4
	1	1	-	-	BRASS	4 BODY	4
	-	-	1	1	BRASS	3 BODY	3
	1	1	-	-	BRASS	4 BODY	3
	1	1	1	1	PTFE	INSULATOR	2
	1	1	1	1	PHOS BRONZE	3 PIN	1
	6--2	1--2	6--0	1--0			
	1	2	1	2			

THIS DRAWING IS A CONTROLLED DOCUMENT.		DWN J.SANDWELL 28SEP04	Tyco Electronics Corporation Bideford, UK, EX39 4HE	
DIMENSIONS: mm		CHK S.PARLOW 28SEP04		
TOLERANCES UNLESS OTHERWISE SPECIFIED:		APVD F.WHEELER-KING 28SEP04	NAME MCX ELBOW PCB SOCKET 50 OHMS	
0 PLC ± - 1 PLC ± - 2 PLC ± - 3 PLC ± - 4 PLC ± - ANGLES ± -		PRODUCT SPEC	SIZE	
MATERIAL		APPLICATION SPEC	CAGE CODE	DRAWING NO
FINISH		WEIGHT	A3 00779 C-1337586	
CUSTOMER DRAWING			RESTRICTED TO	
SCALE NTS			SHEET 1 OF 1	REV D