

REVISIONS

DOC. NO. SPC-F005 * Effective: 7/8/02 * DCP No: 1398

DCP #	REV	DESCRIPTION	DRAWN	DATE	CHECKD	DATE	APPRVD	DATE
1780	A	Released	DCM	10/16/05	JWM	10/17/05	JC	10/17/05

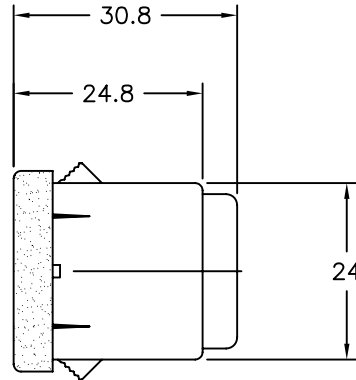
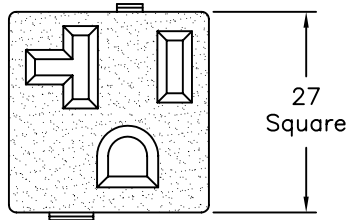

ASSEMBLY

Rated: 15A @ 125V AC

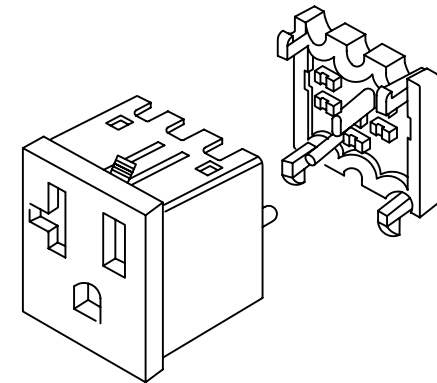

NOTE: PRODUCT SHIPPED UNASSEMBLED

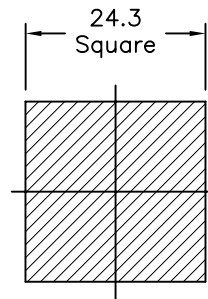
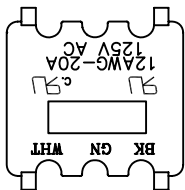
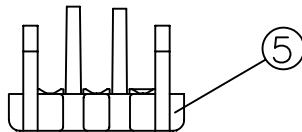
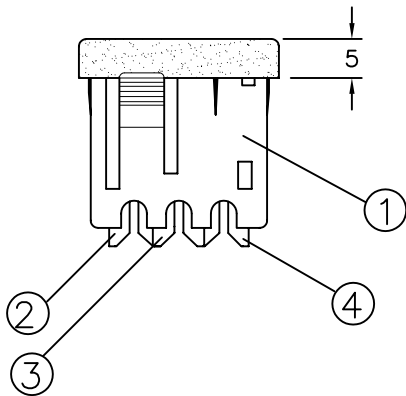

RECOMMENDED PANEL CUTOUT
Panel Thickness: 0.8 ~ 1.8mm
RECOMMENDED TO USE 12 AWG

5	Cover back of the Body, Nylon, Black Color.	1
4	Contact PIN Bronze Strip t=0.7mm Cu	1
3	Contact PIN Bronze Strip t=0.7mm Cu	1
2	Contact PIN Bronze Strip t=0.7mm Ni-Plated	1
1	Body Insulator NYLON Black Color	1

DISCLAIMER:
ALL STATEMENTS AND TECHNICAL INFORMATION CONTAINED HEREIN ARE BASED UPON INFORMATION AND/OR TESTS WE BELIEVE TO BE ACCURATE AND RELIABLE. SINCE CONDITIONS OF USE ARE BEYOND OUR CONTROL, THE USER SHALL DETERMINE THE SUITABILITY OF THE PRODUCT FOR THE INTENDED USE AND ASSUME ALL RISK AND LIABILITY WHATSOEVER IN CONNECTION THEREWITH.

TOLERANCES:

UNLESS OTHERWISE
SPECIFIED: ±0.50

DRAWN BY:

Dan McVicker

DATE:

10/16/05

CHECKED BY:

Jeff McVicker

DATE:

10/17/05

APPROVED BY:

John Cole

DATE:

10/17/05

DRAWING TITLE:

Snap-In, 20 Amp, T-Slot Receptacle

SIZE

A

DWG. NO.

SPC11468

ELECTRONIC FILE

35C0627.dwg

REV

A

SCALE: NTS

U.O.M.: Millimeters

SHEET: 1 OF 1